



## Complete user's manual

CL82219/CL82229/CL82319/

CL82419/CL82519

DECT 6.0 cordless telephone/  
answering system with caller ID/  
call waiting

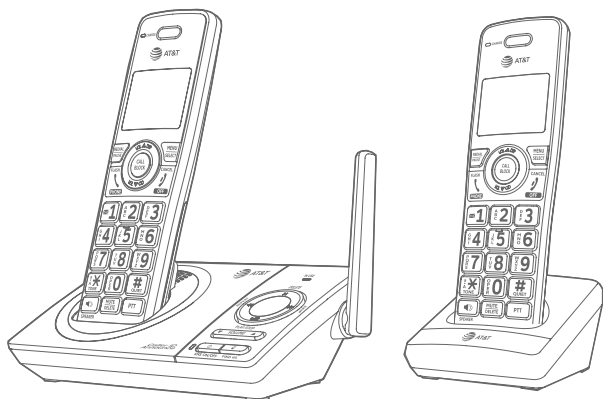

Scan the QR code for  
support information





# Congratulations

on your purchase of this AT&T product. Before using this AT&T product, please read the **Important safety information** section on pages 1-3 of this manual. Please thoroughly read this user's manual for all the feature operations and troubleshooting information necessary to install and operate your new AT&T product. You can also visit our website at **<https://telephones.att.com>** or call **1 (800) 222-3111**. In Canada, dial **1 (866) 288-4268**.

This telephone meets the California Energy Commission regulations for energy consumption. Your telephone is set up to comply with the energy-conserving standards right out of the box. No further action is necessary.

This telephone system is compatible with certain AT&T DECT 6.0 cordless headsets and speakerphones. Visit

**<https://telephones.att.com/accessories>** for a list of compatible cordless headsets and speakerphones.

Model number: CL82219/CL82229 (two handsets)

CL82319 (three handsets)

CL82419 (four handsets)

CL82519 (five handsets)

Type: DECT 6.0 cordless telephone/answering system with caller ID/call waiting

Serial number: \_\_\_\_\_

Purchase date: \_\_\_\_\_

Place of purchase: \_\_\_\_\_

Both the model and serial numbers of your AT&T product can be found on the bottom of the telephone base.

Save your sales receipt and original packaging in case it is necessary to return your telephone for warranty service.

Compatible with  
Hearing Aids T-coil



Telephones identified with this logo have reduced noise and interference when used with most T-coil equipped hearing aids and cochlear implants. The TIA-1083 Compliant Logo is a trademark of the Telecommunications Industry Association. Used under license.



The ENERGY STAR® program ([www.energystar.gov](http://www.energystar.gov)) recognizes and encourages the use of products that save energy and help protect our environment. We are proud to mark this product with the ENERGY STAR® label indicating it meets the latest energy efficiency guidelines.



# Parts checklist

Your telephone package contains the following items. Save your sales receipt and original packaging in the event warranty service is necessary.



Quick start guide



Smart call blocker leaflet

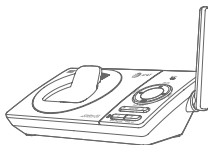

Telephone base



Cordless handset  
(2 for CL82219/CL82229)  
(3 for CL82319)  
(4 for CL82419)  
(5 for CL82519)



Charger for cordless handset with power adapter installed  
(1 for CL82219/CL82229)  
(2 for CL82319)  
(3 for CL82419)  
(4 for CL82519)



Battery for cordless handset  
(2 for CL82219/CL82229)  
(3 for CL82319)  
(4 for CL82419)  
(5 for CL82519)



Battery compartment cover  
(2 for CL82219/CL82229)  
(3 for CL82319)  
(4 for CL82419)  
(5 for CL82519)



Wall-mount bracket

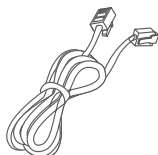

Telephone line cord

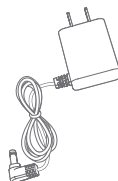

Power adapter for telephone base



# Complete user's manual

CL82219/CL82229/CL82319/

CL82419/CL82519

DECT 6.0 cordless

telephone/ answering system

with caller ID/call waiting

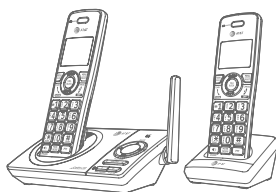

## Table of contents

### Getting started

Important safety  
information ..... 1

Safety information ..... 1

Especially about cordless  
telephones ..... 2

Precautions for users  
of implanted cardiac  
pacemakers ..... 3

ECO mode ..... 3

Especially about telephone  
answering systems ..... 3

Quick reference guide -  
handset ..... 5

Quick reference guide -  
telephone base ..... 10

Telephone base and  
charger installation ..... 11

Telephone base  
installation ..... 11

Charger installation ..... 12

Battery installation and  
charging ..... 13

Battery installation and  
charging ..... 14

Initial setups ..... 16

Installation options ..... 18

Tabletop to wall-mount  
installation ..... 18

Wall-mount to tabletop  
installation ..... 19

### Telephone settings

Handset settings ..... 20

Ringer volume ..... 21

Ringer tone ..... 22

Set date/time ..... 23

LCD language ..... 24

Caller ID announce ..... 25

Set speed dial voicemail  
number ..... 27

Voicemail (visual message  
waiting) indicator ..... 27

Clear voicemail  
indication ..... 28

Rename handset ..... 29

Use caller ID to  
automatically set date  
and time ..... 30

Key tone ..... 30



Home area code .....	31
Dial mode .....	32
QUIET mode .....	33

## Telephone operation

Telephone operation .....	34
Making a call.....	34
On hook dialing (predialing).....	34
Answering a call.....	34
Ending a call.....	34
Auto off .....	34
Temporary ringer silencing .....	35
Handset speakerphone.....	35
Last number redial.....	35
Equalizer.....	36
Options while on calls .....	37
Volume control.....	37
Call waiting.....	37
Mute.....	38
Chain dialing.....	39
Temporary tone dialing....	40
Blind transfer .....	41

## Multiple handset use

Multiple handset use.....	42
Handset locator .....	42
Join a call in progress.....	42
Intercom .....	43
Answer an incoming call during an intercom call....	44
Call transfer using intercom .....	45
Push-to-talk (PTT).....	46
Turn PTT on or off.....	46
PTT call to a single device.....	47

PTT call to multiple devices .....	48
Answer a PTT call.....	49
Change a one-to-one PTT call to an intercom call.....	49
Answer an incoming call during a PTT call .....	50
Make an outgoing call during PTT call.....	50
End or leave a PTT call.....	51

## Directory

About the directory .....	52
Shared directory .....	52
Capacity .....	52
Create directory entries.....	53
Create a new directory entry .....	53
Add a predialed telephone number to the directory .....	54
Review the directory.....	55
Review directory entries...	55
Search the directory .....	56
Search by name .....	56
Dial, delete or edit directory entries .....	57
Display dial .....	57
Delete a directory entry...	57
Dial, delete or edit directory entries .....	58
Edit a directory entry .....	58
Speed dial .....	59
Assign a speed dial number .....	59
Assign your voicemail speed dial number .....	60



Reassign a speed dial number .....	60
Delete a speed dial number .....	61
Make a call using speed dial.....	62
Check your voicemail using speed dial .....	62

## Caller ID

About caller ID .....	63
Information about caller ID with call waiting .....	63
Caller ID log .....	64
How the caller ID log works.....	64
Missed (new) call indicator .....	64
Caller ID operation.....	65
Memory match.....	65
Review the caller ID log ....	66
View dialing options.....	67
Dial a caller ID log entry ...	68
Delete caller ID log entries .....	68
Save a caller ID log entry to the directory.....	69
Save a caller ID log entry to the allow list.....	70
Save a caller ID log entry to the block list .....	70
Save a caller ID log entry to the star name list .....	71
Reasons for missing caller ID information .....	72

## Smart call blocker

About Smart call blocker* .....	73
Call categories .....	74
Call controls.....	75
Call block settings.....	77
Set Smart call blocker on/off.....	77
Set profile .....	77
Block list.....	79
Allow list.....	84
Star name list .....	89
Screening announcements .....	93
Allowed calls .....	96
Blocked calls .....	97
Screen unknown calls.....	98
Screened call options .....	99
Screen robocalls .....	101
Option while on a call .....	103

## Answering system

Answering system settings .....	104
Announcement .....	104
Answer on/off .....	106
Voice guide.....	107
Call screening .....	108
Number of rings .....	109
Remote access code .....	110
Message alert tone .....	111
Message recording time .....	112
Answering system and voicemail indicators.....	113
Using the answering machine and voicemail together.....	114
Message capacity .....	115



Voice prompts .....	115
Call screening .....	116
Call intercept .....	117
Base ringer .....	117
Temporarily turning off the message alert tone...	117
Message playback.....	118
Options during playback.....	119
Delete all old messages .....	120
Recording and playing memos.....	121
Record a memo .....	121
Play back a memo .....	121
Base message counter displays.....	122
Message counter displays .....	122
Remote access .....	123

## Appendix

Adding and registering handsets/headsets/ speakerphones .....	125
Register a handset to the telephone base .....	125
Deregistering handsets .....	127
Deregister all handsets from the telephone base.....	127
Alert tones and lights.....	129
Handset screen icons .....	129
Handset alert tones.....	130
Telephone base alert tones .....	130
Lights .....	131

Screen display messages....	132
Screen messages.....	132
Troubleshooting.....	136
Maintenance .....	148
For C-UL compliance.....	149
Mesures de sécurité importantes .....	149
FCC Part 68 and ACTA.....	153
FCC Part 15.....	155
California Energy Commission battery charging testing instructions .....	156
Limited warranty .....	157
Technical specifications.....	160
DECT 6.0 digital technology .....	160
Telephone operating range .....	160
Redefining long range coverage and clarity .....	160
HD audio .....	160
Simulated full-duplex handset speakerphone ...	160

## Index

Index.....	161
------------	-----



# Important safety information



This symbol is to alert you to important operating or servicing instructions that may appear in this user's manual. Always follow basic safety precautions when using this product to reduce the risk of injury, fire, or electric shock.

## Safety information

---

- ▶ Read and understand all instructions in the user's manual. Observe all markings on the product.
- ▶ Avoid using a telephone during a thunderstorm. There may be a slight chance of electric shock from lightning.
- ▶ Do not use a telephone in the vicinity of a gas leak. Under certain circumstances, a spark may be created when the adapter is plugged into the power outlet, or when the handset is replaced in its cradle. This is a common event associated with the closing of any electrical circuit. In an inadequately ventilated environment, the user should not plug the phone into a power outlet, nor put a charged handset into the cradle where there are concentrations of flammable or flame-supporting gases. A spark in such an environment could create a fire or explosion. Such environments might include: medical use of oxygen without adequate ventilation; industrial gases (cleaning solvents; gasoline vapors; etc.); a leak of natural gas; etc.
- ▶ Do not use this product near water or when you are wet. For example, do not use it in a wet basement or shower, nor next to a swimming pool, bathtub, kitchen sink and laundry tub. Do not use liquids or aerosol sprays for cleaning. If the product comes in contact with any liquid, unplug any line or power cord immediately. Do not plug the product back in until it has dried thoroughly.
- ▶ Install this product in a protected location where no one can trip over any line or power cords. Protect cords from damage or abrasion.
- ▶ If this product does not operate normally, see the **Troubleshooting** section on pages 136-147 of this user's manual. If you cannot solve the problem, or if the product is damaged, refer to the **Limited warranty** section on pages 157-159. Do not open this product except as directed in your user's manual. Opening the product or reassembling it incorrectly may expose you to hazardous voltages or other risks.
- ▶ Replace batteries only as described in your user's manual (pages 13-15). Do not burn or puncture batteries — they contain caustic chemicals.
- ▶ This power adapter is intended to be correctly oriented in a vertical or floor mount position. The prongs are not designed to hold the plug in place if it is plugged into a ceiling or an under-the-table/cabinet outlet.
- ▶ For pluggable equipment, the socket-outlet shall be installed near the equipment and shall be easily accessible.



### CAUTIONS:

- ▶ Use only the power adapter provided with this product. To obtain a replacement, visit our website at **<https://telephones.att.com>** or call **1 (800) 222-3111**. In Canada, dial **1 (866) 288-4268**.



## Important safety information



**CAUTION:** To prevent risk of fire or battery explosion, replace with the correct battery type. Dispose of used batteries according to the instructions.

- ▶ Disconnect the telephone line from the equipment before open the battery door.  
Do not use the battery in following conditions:
  - ▶ High or low extreme temperature during use, storage or transportation.
  - ▶ Replacement of a battery with an incorrect type that can defeat a safeguard.
  - ▶ Disposal of a battery into fire or a hot oven, or mechanically crushing or cutting of a battery, that can result in an explosion.
  - ▶ Leaving a battery in an extremely high temperature surrounding environment that can result in an explosion or the leakage of flammable liquid or gas.
  - ▶ A battery subjected to extremely low air pressure that can result in an explosion or the leakage of flammable liquid or gas.
- ▶ Use only the supplied rechargeable battery or replacement battery (model BT183342/ BT283342). To order, visit our website at  
**<https://telephones.att.com>**, or call **1 (800) 222-3111**. In Canada, dial **1 (866) 288-4268**.
- ▶ The applied nameplate is located at the bottom or near of the product.

### Especially about cordless telephones

---

- ▶ Privacy: The same features that make a cordless telephone convenient create some limitations. Telephone calls are transmitted between the telephone base and the handset by radio waves, so there is a possibility that your cordless telephone conversations could be intercepted by radio receiving equipment within range of the cordless handset. For this reason, you should not think of cordless telephone conversations as being as private as those on corded telephones.
- ▶ Electrical power: The telephone base of this cordless telephone must be connected to a working electrical outlet which is not controlled by a wall switch. Calls cannot be made from the handset if the telephone base is unplugged, switched off or if the electrical power is interrupted.
- ▶ Potential TV interference: Some cordless telephones operate at frequencies that may cause interference to TVs and VCRs. To minimize or prevent such interference, do not place the telephone base of the cordless telephone near or on top of a TV or VCR. If interference is experienced, moving the cordless telephone farther away from the TV or VCR will often reduce or eliminate the interference.
- ▶ Rechargeable batteries: This product contains nickel-metal hydride rechargeable batteries. Exercise care in handling batteries in order not to create a short circuit with conductive material such as rings, bracelets, and keys. The battery or conductor may overheat and cause harm. Observe proper polarity between the battery and the battery charger.
- ▶ Nickel-metal hydride rechargeable batteries: Dispose of these batteries in a safe manner. Do not burn or puncture. Like other batteries of this type, if burned or punctured, they could release caustic material which could cause injury.



## Important safety information



The RBRC Seal means that the manufacturer is voluntarily participating in an industry program to collect and recycle nickel-metal hydride rechargeable batteries when taken out of service within the United States. These batteries may be taken to a participating local retailer of replacement batteries or recycling center. You may call 1-800-8-BATTERY® for locations accepting spent Ni-MH batteries.

The RBRC Seal and 1-800-8-BATTERY® are registered trademarks of Call2recycle, Inc.

### **Precautions for users of implanted cardiac pacemakers**

---

Cardiac pacemakers (applies only to digital cordless telephones):

Wireless Technology Research, LLC (WTR), an independent research entity, led a multidisciplinary evaluation of the interference between portable wireless telephones and implanted cardiac pacemakers. Supported by the U.S. Food and Drug Administration, WTR recommends to physicians that:

#### **Pacemaker patients:**

- ▶ Should keep wireless telephones at least six inches from the pacemaker.
- ▶ Should NOT place wireless telephones directly over the pacemaker, such as in a breast pocket, when it is turned ON.
- ▶ Should use the wireless telephone at the ear opposite the pacemaker.

WTR's evaluation did not identify any risk to bystanders with pacemakers from other persons using wireless telephones.

### **ECO mode**

---

This power conserving technology reduces power consumption for optimal battery performance. The ECO mode activates automatically whenever the handset is synchronized with the telephone base.

### **Especially about telephone answering systems**

---

Two-way recording: This unit does not sound warning beeps to inform the other party that the call is being recorded. To ensure that you are in compliance with any federal or state regulations regarding recording a telephone call, you should start the recording process and then inform the other party that you are recording the conversation.

## **SAVE THESE INSTRUCTIONS**



You must install and charge the battery before using the telephone.



**STOP!**

See pages 13-15 for easy instructions.

Install the telephone base close to a telephone jack and a power outlet not controlled by a wall switch. The telephone base can be placed on a flat surface or vertically mounted on the wall (see page 18). For optimum range and better reception, place the telephone base in a central and open location.

If you subscribe to high-speed Internet service (DSL - digital subscriber line) through your telephone line, you must install a DSL filter between the telephone line cord and the telephone wall jack (see page 11). The filter prevents noise and caller ID problems caused by DSL interference. Please contact your DSL service provider for more information about DSL filters.

Your product may be shipped with protective stickers covering the handset and telephone base displays - remove them before use.

For customer service or product information, visit our website at **<https://telephones.att.com>** or call **1 (800) 222-3111**. In Canada, dial **1 (866) 288-4268**.

**Avoid placing the telephone base and charger too close to:**

- ▶ Communication devices such as television sets, VCRs, or other cordless telephones.
- ▶ Excessive heat sources.
- ▶ Noise sources such as a window with traffic outside, motors, microwave ovens, refrigerators, or fluorescent lighting.
- ▶ Excessive dust sources such as a workshop or garage.
- ▶ Excessive moisture.
- ▶ Extremely low temperature.
- ▶ Mechanical vibration or shock such as on top of a washing machine or workbench.



# Quick reference guide - handset

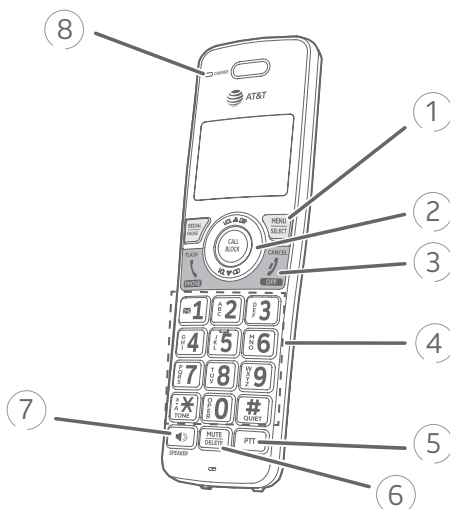

## 1 REDIAL/PAUSE

- ▶ Press repeatedly to view the last ten numbers dialed (page 35).
- ▶ While entering numbers, press and hold to insert a dialing pause (page 53).

## MENU/SELECT

- ▶ When the handset is not in use, press to show the menu.
- ▶ While in the menu, press to select an item or save an entry or setting.

## 2 VOL ▲ DIR

- ▶ Press **▲DIR** to show directory entries when the handset is not in use (page 55).
- ▶ Press to scroll up while in menus.

- ▶ While entering names or numbers, press to move the cursor to the right.
- ▶ Press to increase the listening volume when on a call (page 37), or to increase the message playback volume (page 119).

## CALL BLOCK

- ▶ Press to block the incoming call when the telephone is ringing (page 73).
- ▶ When on a call, press to block the call (page 103).
- ▶ When the handset is not in use, press to show the Smart call blocker menu (page 77).



# Quick reference guide - handset

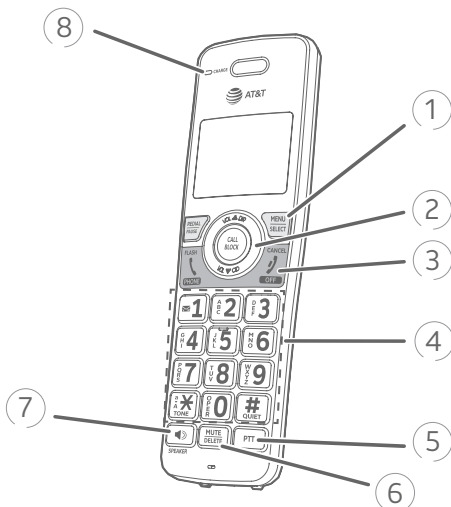

## ② VOL ▼ CID

- ▶ Press **▼CID** to show caller ID log when the handset is not in use (page 66).
- ▶ Press to scroll down while in menus.
- ▶ While entering names or numbers, press to move the cursor to the left.
- ▶ Press to decrease the listening volume when on a call (page 37), or to decrease the message playback volume (page 119).

## ③ \PHONE/FLASH

- ▶ Press to make or answer a call (page 34).
- ▶ During a call, press to answer an incoming call when you receive a call waiting alert (page 37).

## /OFF/CANCEL

- ▶ During a call, press to hang up (page 34).
- ▶ While in a menu, press to cancel an operation.
- ▶ Press to return to the previous menu.
- ▶ Press and hold to exit menu display completely.
- ▶ When the handset is ringing, press to mute the ringer temporarily (page 35).
- ▶ Press and hold while the telephone is not in use to erase the missed call indicator (page 64).



# Quick reference guide - handset

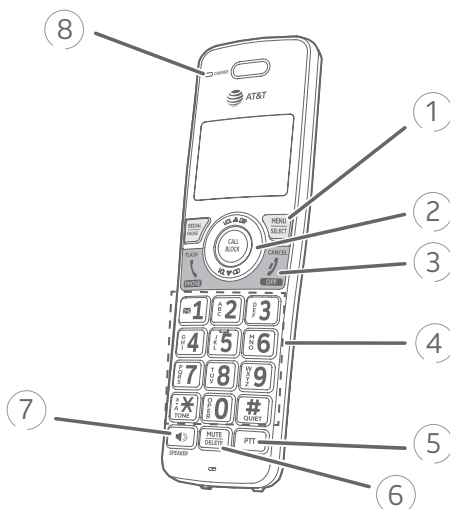

## 4 1

- ▶ While reviewing a caller ID log entry, press repeatedly to add or remove 1 in front of the telephone number before dialing or saving it in the directory (page 67).
- ▶ Press and hold to set (page 27) or to dial your voicemail number (page 62).

## 5 **PTT**

- ▶ Press and hold to enter the **QUIET** mode setting screen, or to deactivate **QUIET** mode (page 33).

## 6 **MUTE/DELETE**

- ▶ Press to initiate a one-to-one or one-to-group broadcast.
- ▶ Press and hold to broadcast to a group of system devices.

## 7 **TONEX/a>A**

- ▶ Press to switch to tone dialing temporarily during a call if you have pulse service (page 40).
- ▶ While entering names, press to change the next letter to upper or lower case (page 53).

## 8 **QUIET# (pound key)**

- ▶ Press repeatedly to display other dialing options when reviewing a caller ID log entry (page 67).

## 9 **PTT**

- ▶ During a call, press to mute the microphone (page 38).
- ▶ When the handset is ringing, press to mute the ringer temporarily (page 35).
- ▶ While reviewing the caller ID log, directory, redial memory, block list, allow list, or star name list, press to delete an individual entry.
- ▶ While predialing, press to delete digits.



# Quick reference guide - handset

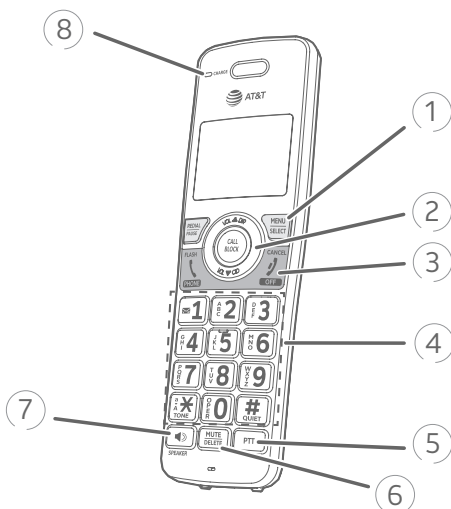

- 
- (6) ▶ During message or announcement playback, press to delete the playing message or the recorded announcement.
- 

- (7) **/SPEAKER**
- ▶ Press to make or answer a call using the speakerphone (page 34).
  - ▶ Press to switch between the speakerphone and the handset (page 35).

- 
- (8) **CHARGE light**
- ▶ On when the handset is charging in the telephone base or charger.
-



# Quick reference guide - handset

## Main menu

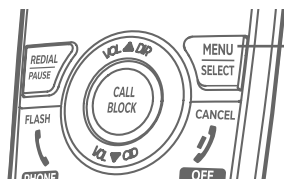

## Main menu

- Play messages (page 118)
- Answering sys (page 104)
- Smart call blk (page 73)
- Directory (page 52)
- Caller ID log (page 63)
- Intercom (page 43)
- Ringers (page 21)
- Set date/time (page 23)
- Settings (page 24)

The > symbol highlights a menu item.



## Using menus:

- Press **MENU/SELECT** to show the menu.
- Press **▼CID** or **▲DIR** to scroll through menu items.
- Press **MENU/SELECT** to confirm or save changes to a highlighted menu item.
- Press **/OFF/CANCEL** to cancel an operation, back up to the previous menu, or exit the menu display.



# Quick reference guide - telephone base

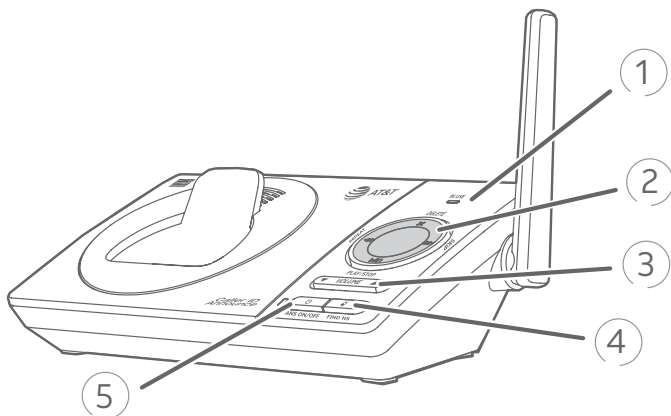

## ① IN USE indicator

- ▶ On when the handset is in use, or when the answering system is answering an incoming call.
- ▶ Flashes when another telephone is in use on the same line.
- ▶ Flashes when there is an incoming call.

## ② ◀/REPEAT

- ▶ Press to repeat a message.
- ▶ Press twice to play the previous message (page 119).

## X/DELETE

- ▶ Press to delete the message currently playing (page 119).
- ▶ Press twice to delete all old messages when the phone is not in use (page 120).

## ▶/SKIP

- ▶ Press to skip a message (page 119).

## ▶/PLAY/STOP

- ▶ Press to start or stop message playback (page 118).

## Message counter

- ▶ Shows the number of messages or other answering system information.

## ③ ▼ VOLUME ▲

- ▶ During message playback, press to adjust the listening volume (page 119).
- ▶ While in idle mode, press to adjust the base ringer volume.

## ④ 🔍 FIND HS

- ▶ While the phone is idle, press to page all handsets (page 42).

## ⑤ ⏻/ANS ON/OFF

- ▶ Press to turn the built-in answering system on or off (page 106).



# Telephone base and charger installation

Install the telephone base and charger, as shown below.

The telephone base is ready for tabletop use. If you want to change to wall-mounting, see **Installation options** on page 18 for details.

## Telephone base installation

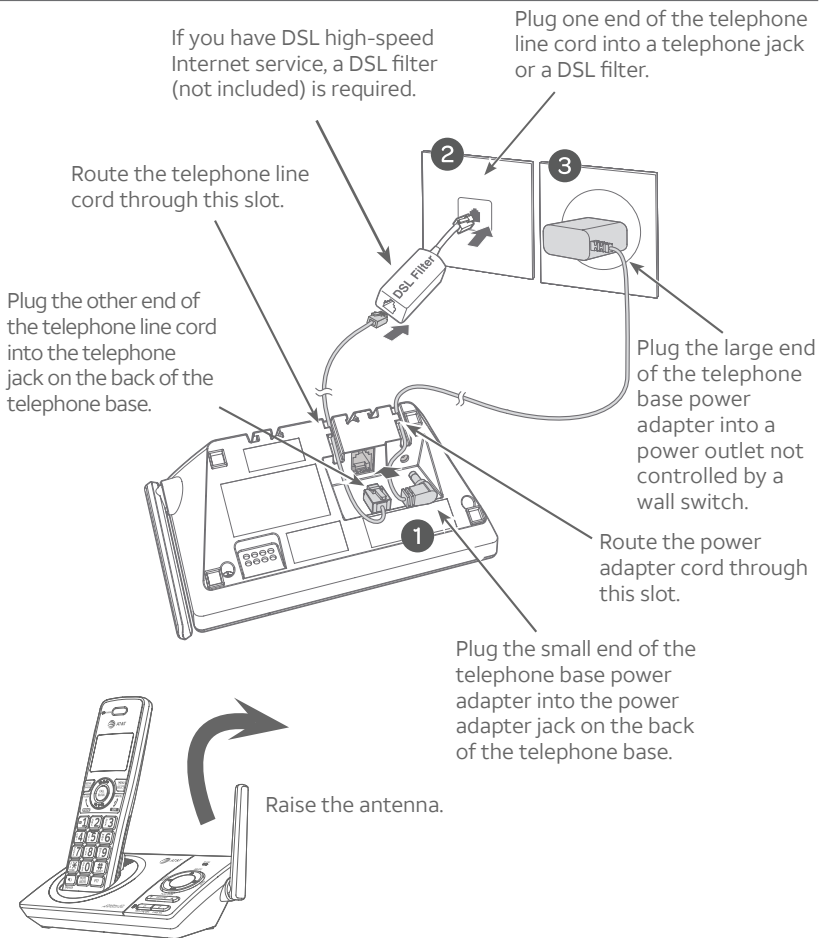



# Telephone base and charger installation

## Charger installation

---

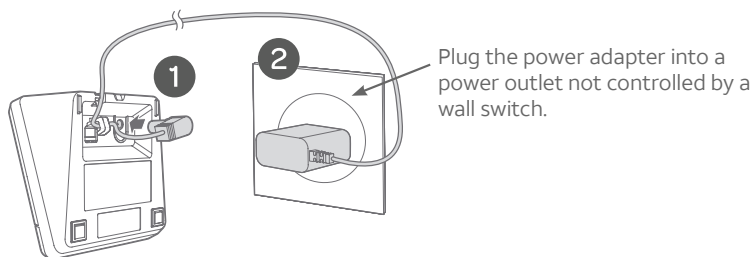

## IMPORTANT INFORMATION



- ▶ Use only the power adapter(s) supplied with this product. To order a replacement power adapter, visit our website at **<https://telephones.att.com>** or call **1 (800) 222-3111**. In Canada, dial **1 (866) 288-4268**.
- ▶ The power adapters are intended to be correctly oriented in a vertical or floor mount position. The prongs are not designed to hold the plug in place if it is plugged into a ceiling, under-the-table or cabinet outlet.



# Battery installation and charging

Install the battery, as shown below. Once you have installed the battery, the screen indicates the battery status (see the following table). If necessary, place the handset in the telephone base or charger to charge the battery. For best performance, keep the handset in the telephone base or charger when not in use. The battery is fully charged after ten hours of continuous charging. See the table on page 160 for battery operating times.

If the screen shows **Place in charger** and  flashes, you need to charge the handset without interruption for at least 30 minutes to give the handset enough charge to use the telephone for a short time. The following table summarizes the battery charge indicators and actions to take.

Battery indicators	Battery status	Action
The screen is blank, or shows <b>Place in charger</b> and  (flashing).	Battery has no or very little charge. The handset cannot be used.	Charge without interruption (at least 30 minutes).
The screen shows <b>Low battery</b> and  (flashing).	Battery has enough charge to be used for a short time.	Charge without interruption (at least 30 minutes).
The screen shows <b>HANDSET X.</b>	Battery is charged.	To keep the battery charged, place it in the telephone base or charger when not in use.



Note: If you are on a phone call in low battery mode, you hear four short beeps every minute.



# Battery installation and charging

## Step 1

Plug the battery connector securely into the socket inside the handset battery compartment. Insert the supplied battery with the label **THIS SIDE UP** facing up, as indicated.

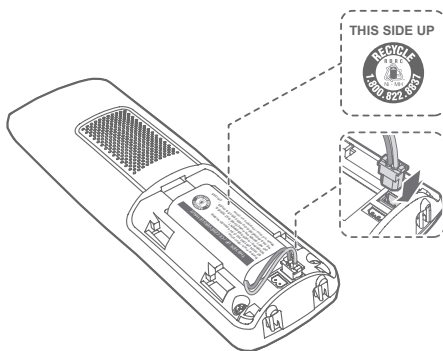

## Step 2

Align the cover flat against the battery compartment, then slide it upwards until it clicks into place.

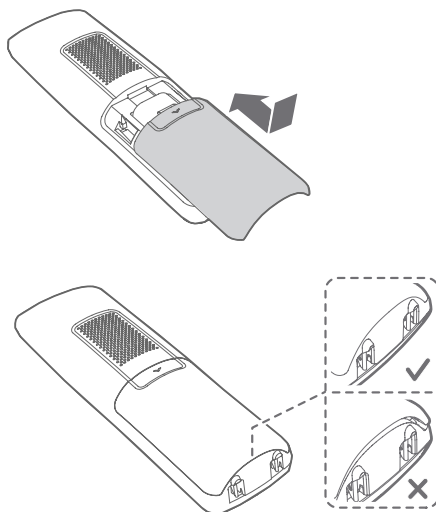



## Battery installation and charging

### Step 3

Charge the handset by placing it face forward in the telephone base or charger. The **CHARGE** light on the handset is on during charging.

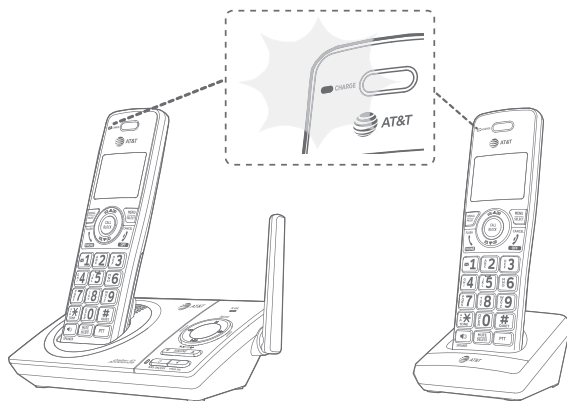

### IMPORTANT INFORMATION

- ▶ Use only the supplied rechargeable battery or replacement battery (model BT183342/BT283342). To order, visit our website at **<https://telephones.att.com>** or call **1 (800) 222-3111**. In Canada, dial **1 (866) 288-4268**.
- ▶ If you do not use the handset for a long time, disconnect and remove the battery to prevent possible leakage.



## Initial setups

After you install your telephone or power returns following a power outage, the handset will prompt you to set the date and time. For instructions, see **Set date/time** on page 23. To skip setting the date and time, press **⏏ OFF/CANCEL** on the handset.



After the date and time setting is done or skipped, the handset then prompts if you want to set Smart call blocker. Press **MENU/SELECT** on the handset to start the Smart call blocker setup via voice guide. To skip the setup, press **⏏ OFF/CANCEL** on the handset.



### Voice guide to set Smart call blocker:

If you choose to set Smart call blocker via voice guide, you hear a voice prompt, *"Hello! This voice guide will assist you with the basic setup of Smart call blocker..."*. Listen to the instructions and then choose one of the following options.

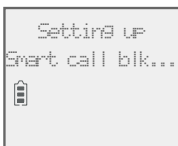

On the handset:

- ▶ Press **1** if you want to screen calls with telephone numbers that are not saved in your directory, allow list or star name list; or
- ▶ Press **2** if you do not want to screen calls, and want to allow all incoming calls to get through.



## Initial setups

If you select option 1 to screen all incoming calls, we recommend that you add the phone numbers of your family members and friends, and desired businesses to your **Directory** (see page 53) or **Allow list** (see page 84), or add their names to the **Star name list** (see page 89). This will avoid Smart call blocker to screen their calls.

For more details on **Smart call blocker**, see page 73.



Note: You can restart the voice guide to set Smart call blocker by resetting your handset power.

After the Smart call blocker setting is done or skipped, the handset will prompt if you want to set up the answering system. Press **MENU/SELECT** to start the answering system setup via voice guide. For more details, see **Voice guide** on page 107. To skip the setup, press **⏏ OFF/CANCEL** on the handset.

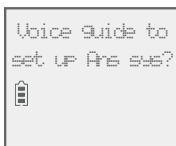



## Installation options

Your telephone base is ready for tabletop use. If you want to mount your telephone on a wall, follow the steps to connect the telephone base with a standard dual-stud telephone wall-mounting plate. You may need a professional to install the mounting plate.

### Tabletop to wall-mount installation

1. Plug the telephone line into the telephone base. If you are using a DSL filter, plug the other end of the telephone line into the filter. Route the telephone line cord (or DSL filter) through the wall-mount bracket hole.
2. Align the holes on the wall-mount bracket with the standard wall plate and slide the wall-mount bracket down until it locks securely.
3. Position the telephone base, as shown below. Insert the extended tabs (marked B) of the wall-mount bracket into the slots on the back of the telephone base. Push the telephone base down until it is securely in place.
4. Plug the power adapter into a power outlet not controlled by a wall switch. Plug the other end of the power adapter into the telephone base. Bundle the telephone line cord and power adapter cord neatly with twist ties.

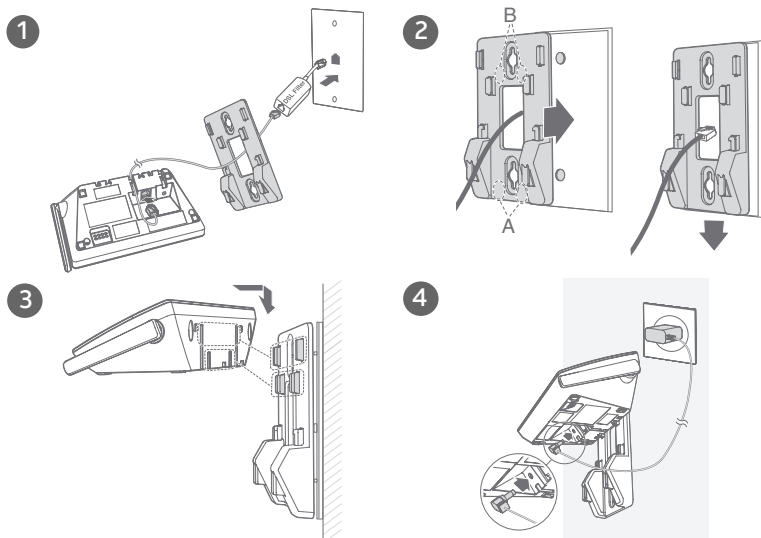



## Installation options

### Wall-mount to tabletop installation

---

1. Unplug the large end of the power adapter from the electrical outlet.
2. If the telephone line cord and power adapter cord are bundled, untie them first. Slide the wall-mount bracket up and remove it from the wall-mounting plate.

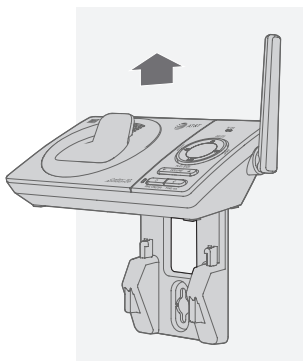

3. Unplug the telephone line cord or the DSL filter from the telephone wall jack. Push the telephone base up and away from the wall-mount bracket to detach it from the wall-mount bracket.

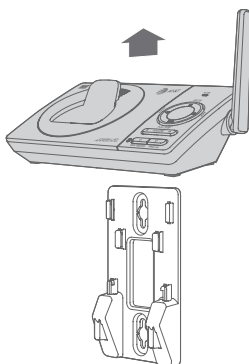

4. See **Telephone base and charger installation** on page 11.



## Handset settings

Use the menu to change the telephone settings.

1. Press **MENU/SELECT** on the handset when it is not in use to enter the main menu.
2. Press ▼ **CID** or ▲ **DIR** to scroll to the feature to be changed. When scrolling through the menu, the ► symbol indicates the selected menu item.
3. Press **MENU/SELECT** to select the highlighted item.



Note: Press **↵ OFF/CANCEL** to cancel an operation, back up to the previous menu or exit the menu display. Press and hold **↵ OFF/CANCEL** to return to idle mode.



# Handset settings

## Ringer volume

You can set the ringer volume level to one of six levels or turn the ringer off. When the ringer is off,  appears on the screen.

1. Press **MENU/SELECT** in idle mode to enter the main menu.
2. Use **▼CID** or **▲DIR** to scroll to **Ringers**, then press **MENU/SELECT**.
3. Press **MENU/SELECT** again to select **Ringer volume**.
4. Press **▼CID** or **▲DIR** to sample each volume level.
5. Press **MENU/SELECT** to save your preference. There is a confirmation tone and the screen returns to the previous menu.



Notes:

- ▶ The handset ringer volume also determines the ringer volume for intercom calls.
- ▶ If the ringer volume is set to off, that handset is silenced for all incoming calls except paging tone.
- ▶ If the ringer volume is set to off, the caller ID will not be announced and the screen will briefly display Caller ID won't be announced.



# Handset settings

## Ringer tone

You can choose one of ten ringer tones.

1. Press **MENU/SELECT** in idle mode to enter the main menu.
2. Use ▼**CID** or ▲**DIR** to scroll to **Ringers**, then press **MENU/SELECT**.
3. Press ▼**CID** or ▲**DIR** to scroll to **Ringer tone**, then press **MENU/SELECT**.
4. Press ▼**CID** or ▲**DIR** to sample each ringer tone.
5. Press **MENU/SELECT** to save your preference.  
There is a confirmation tone and the screen returns to the previous menu.



Note: If you turn off the ringer volume, you will not hear ringer tone samples.



# Handset settings

## Set date/time

The answering system announces the day and time of each message prior to playing it. Before using the answering system, set the date and time as follows. If you subscribe to caller ID service, the day, month and time are set automatically with each incoming call. The year must be set so that the day of the week can be calculated from the caller ID information. You can turn off the date and time settings of the caller ID service and set the date and time manually (see **Use caller ID to automatically set date and time** on page 30).

After a power failure or handset registration, the system prompts you to set the date and time.

### To set the date and time manually:

1. When the handset is in idle mode, press **MENU/SELECT** to enter the main menu.
2. Press ▼**CID** or ▲**DIR** to scroll to **Set date/time** and then press **MENU/SELECT**.
3. Press ▼**CID** or ▲**DIR** to select the month, then press **MENU/SELECT**, or enter the number using the dialing keys.
4. Press ▼**CID** or ▲**DIR** to select the day, then press **MENU/SELECT**, or enter the number using the dialing keys.
5. Press ▼**CID** or ▲**DIR** to select the year, or enter the number using the dialing keys, then press **MENU/SELECT** to move on to set the time.
6. Press ▼**CID** or ▲**DIR** to select the hour, then press **MENU/SELECT**, or enter the number using the dialing keys.
7. Press ▼**CID** or ▲**DIR** to select the minute, then press **MENU/SELECT**, or enter the number using the dialing keys.





## Handset settings

- Press **▼CID** or **▲DIR** to highlight **AM** or **PM**, or press **2** for **AM** or **7** for **PM**. Press **MENU/SELECT** to confirm. There is a confirmation tone and the screen returns to the previous menu.



Note: If the clock is not set when a message is recorded, the system announces, “Time and day not set,” before it plays the message.

### LCD language

---

You can select the language used for all screen displays.

- Press **MENU/SELECT** in idle mode to enter the main menu.
- Use **▼CID** or **▲DIR** to scroll to **Settings**, then press **MENU/SELECT**.
- Press **MENU/SELECT** to choose **LCD language**.
- Press **▼CID** or **▲DIR** to highlight **English**, **Français** or **Español**, then press **MENU/SELECT**. The screen prompts **Set English/Français/Español as LCD language?**.
- Press **MENU/SELECT** to save your preference. There is a confirmation tone and the screen returns to the previous menu.



Note: If you accidentally change the LCD language to French or Spanish, you can reset it back to English without going through the French or Spanish menus. Press **MENU/SELECT** on the handset in idle mode, then enter **364#**. There is a confirmation tone.



# Handset settings

## Caller ID announce

The caller ID announce feature lets you know who's calling without having to look at the display. When you have an incoming call, the handset and/or base speaks "*Call from...*" and the name of the caller based on the directory or caller ID information. If the caller's name is private or unknown, the phone number up to the last 11 digits will be announced. If the caller's phone number is also private or unknown, no information will be announced. The default setting is **On**.

### To turn on or off the caller ID announce feature:

1. Press **MENU/SELECT** in idle mode to enter the main menu.
2. Use ▼**CID** or ▲**DIR** to scroll to **Settings**, then press **MENU/SELECT**.
3. Use ▼**CID** or ▲**DIR** to scroll to **Caller ID annc**, then press **MENU/SELECT**.
4. Use ▼**CID** or ▲**DIR** to highlight the desired option, then press **MENU/SELECT**.
  - ▶ **Set all On/Off** - Change the setting for the base and all handsets.
  - ▶ **Local handset** - Change the setting for that handset only.
  - ▶ **Base** - Change the setting for the telephone base only.
5. Use ▼**CID** or ▲**DIR** to highlight **On** or **Off**, then press **MENU/SELECT**. There is a confirmation tone and the screen returns to the previous menu. If you change the setting to **Set all On/Off**, the screen shows **CID Annc ON/OFF on all HS & BS**. The caller ID announce feature has been turned on or off on all handsets and on the telephone base.





## Telephone settings

# Handset settings



### Notes:

- ▶ To use the caller ID announce feature, you must subscribe to caller ID service from your telephone service provider.
- ▶ When there are up to five handsets registered, the telephone system supports caller ID announce for all handsets. If six or more devices are registered, the system supports caller ID announce for the first four registered handsets only.
- ▶ This feature does not announce information for call waiting calls.
- ▶ It takes at least two rings for the phone to receive caller ID information and announce it. If the phone is answered before the end of the second ring, the phone won't have time to announce the caller's information.
- ▶ Pronunciation of names may vary with this feature. Not all names may be pronounced correctly.
- ▶ Caller ID announce is available in English only.
- ▶ If you have paired an AT&T **TL80133** DECT 6.0 cordless speakerphone to the telephone base, the caller ID announce setting for all devices also applies to the cordless speakerphone. When the setting is **On**, the cordless speakerphone speaks "Call from..." and the name of the caller based on the directory or caller ID information during an incoming call. If the caller's name is unavailable, the phone number up to the last 11 digits will be announced.



# Handset settings

## Set speed dial voicemail number

This feature lets you save your voicemail number for easy access when you press and hold the  **1** key.

### To save your voicemail number:

1. Press **MENU/SELECT** in idle mode to enter the main menu.
2. Use **▼CID** or **▲DIR** to scroll to **Settings**, then press **MENU/SELECT**.
3. Use **▼CID** or **▲DIR** to scroll to **Voicemail #**, then press **MENU/SELECT**.
4. Use the dialing keys to enter the voicemail access number provided by your telephone service provider (up to 30 digits) when prompted.
  - ▶ Press **▼CID** or **▲DIR** to move the cursor to the left or right.
  - ▶ Press **MUTE/DELETE** on the handset to erase a digit.
  - ▶ Press and hold **MUTE/DELETE** on the handset to erase all digits.
  - ▶ Press **REDIAL/PAUSE** to enter a three-second dialing pause (a **p** appears).
5. Press **MENU/SELECT** to save. There is a confirmation tone and the screen displays **Voicemail # saved**, then returns to the previous menu.



## Voicemail (visual message waiting) indicator

If you subscribe to a voicemail service offered by your telephone service provider, this feature provides a visual indication when you have new voicemail messages.

**New voicemail** and the  icon appear on the handset screen.

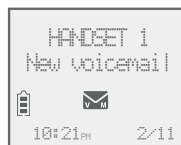



## Handset settings



Notes:

- ▶ This feature does not indicate new messages recorded on your phone's built-in answering system.
- ▶ For more information about the difference between your answering system and voicemail, see page 113.

### Clear voicemail indication

---

Use this feature when the telephone indicates that you have new voicemail but there is none. For example, when you have accessed your voicemail while away from home. This feature only turns off the displayed **New voicemail** and the  icon; it does not delete your voicemail messages. As long as you have new voicemail messages, your telephone service provider continues to send the signal to turn on the indicators.

#### To manually turn off the new voicemail indicators:

1. Press **MENU/SELECT** when in idle mode to enter the main menu.
2. Use **▼CID** or **▲DIR** to scroll to **Settings**, then press **MENU/SELECT**.
3. Use **▼CID** or **▲DIR** to scroll to **Clr voicemail**, then press **MENU/SELECT**. The screen shows **Reset Voicemail Indicator?**.
4. Press **MENU/SELECT** again to turn the voicemail indication off. There is a confirmation tone and the screen returns to the previous menu.

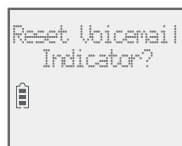

Notes:

- ▶ Your telephone service provider voicemail may alert you to new messages with a stutter (broken) dial tone. Contact your telephone service provider for more details.
- ▶ For information about using your voicemail service, contact your telephone service provider.



## Handset settings

### Rename handset

---

You can edit the handset name for each system handset.

1. When the handset is idle, press **MENU/SELECT**.
2. Use ▼**CID** or ▲**DIR** to scroll to **Settings**, then press **MENU/SELECT**.
3. Use ▼**CID** or ▲**DIR** to scroll to **Rename handset**, then press **MENU/SELECT**.
4. Change the handset name when prompted.
  - Press ▼**CID** or ▲**DIR** to move the cursor to the left or right.
  - Use the dialing keys to enter a name (up to 11 characters). Each time you press a key, a character on that key appears. Additional key presses produce other characters on that key. See the chart on page 54.
  - Press **MUTE/DELETE** to backspace and delete a character.
  - Press and hold **MUTE/DELETE** to delete all characters.
5. Press **MENU/SELECT** to save the setting and return to the previous menu. There is a confirmation tone.





# Handset settings

## Key tone

The handset is set to beep with each key press. You can adjust the key tone volume or turn it off. If you turn off the key tone, there are no beeps when you press keys.

1. Press **MENU/SELECT** in idle mode to enter the main menu.
2. Use **▼CID** or **▲DIR** to scroll to **Settings**, then press **MENU/SELECT**.
3. Use **▼CID** or **▲DIR** to scroll to **Key tone**, then press **MENU/SELECT**.
4. Use **▼CID** or **▲DIR** to select the desired volume or **Off**.
5. Press **MENU/SELECT** to save your preference. There is a confirmation tone and the screen returns to the previous menu.



## Use caller ID to automatically set date and time

If you subscribe to caller ID service, the day, month and time are set automatically with each incoming call. Follow the steps to turn the **CID time sync** feature on or off. The default setting is **On**.

1. When the handset is in idle mode, press **MENU/SELECT** to enter the main menu.
2. Press **▼CID** or **▲DIR** to scroll to **Settings**, then press **MENU/SELECT**.
3. Press **▼CID** or **▲DIR** to scroll to **CID time sync**, then press **MENU/SELECT**.
4. Press **▼CID** or **▲DIR** to highlight **On** or **Off**, then press **MENU/SELECT** to save. There is a confirmation tone and the screen returns to the previous menu.

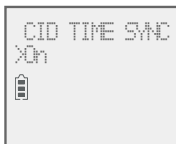



# Handset settings

## Home area code

If you dial seven digits to make a local call (no area code required), enter your area code into the telephone as the home area code. When you receive a call from within your home area code, the caller ID log only displays the seven digits of the telephone number.

This feature makes it easy for you to place a call from the caller ID log. If you dial ten digits to make a local phone call, do not use this home area code feature. If you do, you cannot place local calls from your caller ID log, as they will have only seven digits.

### To set the home area code:

1. Press **MENU/SELECT** in idle mode to enter the main menu.
2. Use **▼CID** or **▲DIR** to scroll to **Settings**, then press **MENU/SELECT**.
3. Use **▼CID** or **▲DIR** to scroll to **Home area code**, then press **MENU/SELECT**. The screen briefly shows **Only for 7digit dial from CID**.
4. Use the dialing keys to enter a three-digit home area code.
  - ▶ Press **MUTE/DELETE** to delete a digit.
  - ▶ Press and hold **MUTE/DELETE** to delete all digits.
5. Press **MENU/SELECT** to save. There is a confirmation tone and the screen shows **Area code will not show in CID** briefly before returning to the previous menu.



Note: If in the future, your telephone service provider requires you to dial ten digits to make a local call (area code plus telephone number), you need to delete your home area code and dial out locally from the call ID log. With the home area code displayed, press and hold **MUTE/DELETE** until the digits are deleted, and then press **MENU/SELECT**. The home area code is now restored to its default setting of **\_ \_ \_** (empty).



# Handset settings

## Dial mode

---

The dial mode is preset to tone dialing. If you have pulse (rotary) service, you must change the dial mode to pulse dialing before using the telephone.

### To set the dial mode:

1. Press **MENU/SELECT** in idle mode to enter the main menu.
2. Use ▼**CID** or ▲**DIR** to scroll to **Settings**, then press **MENU/SELECT**.
3. Use ▼**CID** or ▲**DIR** to scroll to **Dial mode**, then press **MENU/SELECT**.
4. Use ▼**CID** or ▲**DIR** to highlight **Touch-tone** or **Pulse**, then press **MENU/SELECT**. There is a confirmation tone and the screen returns to the previous menu.





# Handset settings

## QUIET mode

---

When **QUIET** mode is turned on, the telephone silences all sounds during the set period of time (1-12 hours). However, the handset locator paging tone and any sound-generating operations initiated by users, such as making calls using the speakerphone or setting ringer volume, will sound as normal. After you turn on **QUIET** mode, this feature activates immediately and the answering system turns on automatically. When **QUIET** mode is on, the answering system takes calls and records messages without broadcasting them.

### To turn QUIET mode on:

1. Press and hold **QUIET #** in idle mode to enter the **QUIET** mode setting screen. The screen shows **Quiet: \_\_ hours (1-12 hours)**.
2. Use the dialing keys to enter the desired number of hours (1-12) you would like to turn on **QUIET** mode, then press **MENU/SELECT**. Your screen briefly shows **Answering sys is ON** and then **Quiet mode on**.

### To turn QUIET mode off:

- ▶ While **QUIET** mode is on, press and hold **QUIET #**. The screen then shows **Quiet mode is off** and you hear a confirmation tone.



#### Notes:

- ▶ If you change the base ringer, handset ringer, ringer volume, key tone, or caller ID announce features when QUIET mode is on, the sample plays but the feature is still muted after saving the setting.
- ▶ After QUIET mode is turned off or the set period of time has expired, all muted features will be activated again.
- ▶ The PTT function is not available when QUIET mode is on.
- ▶ Intercom is available during QUIET mode, but the handset will not ring.
- ▶ When QUIET mode is on, and Smart call blocker is on and in screening mode, all screened calls will be sent to the answering system after screening. For more information on Smart call blocker, see page 73.



# Telephone operation

## Making a call

- Press **\ PHONE/FLASH** or **📞/SPEAKER**, then enter the telephone number.

The screen displays the elapsed time as you talk (in hours, minutes and seconds).



Note: Pressing **\ PHONE/FLASH** or **📞/SPEAKER** to access services from your telephone service provider does not affect the elapsed time.

### Elapsed time



## On hook dialing (predialing)

- Enter the telephone number. Press **MUTE/DELETE** to make corrections when entering the phone number.
- Press **\ PHONE/FLASH** or **📞/SPEAKER** to dial.

## Answering a call

- Press **\ PHONE/FLASH** or **📞/SPEAKER**.  
-OR-
- Press any dialing key (**0-9**, **TONE X** or **#**).

## Ending a call

- Press **📞 OFF/CANCEL** or return the handset to the telephone base or charger.

## Auto off

A call ends automatically when you put the handset in the telephone base or charger.



# Telephone operation

## Temporary ringer silencing

Press **⏸/OFF/CANCEL** or **MUTE/DELETE** while the telephone is ringing to silence the ringer temporarily on that handset only. This turns off the ringer without disconnecting the call. The next incoming call rings normally at the preset volume.

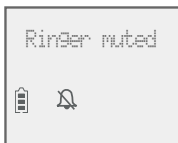

## Handset speakerphone

During a call, press **🔊/SPEAKER** to switch between handsfree speakerphone and normal handset use. Press **⏸/OFF/CANCEL** or return the handset to the telephone base or charger to hang up.



Notes:

- ▶ When you use the speakerphone, the key pad and the **🔊/SPEAKER** button on the handset are lit.
- ▶ The speakerphone uses more power than the normal handset. If the handset battery becomes very low while you are using the speakerphone, the call remains in speakerphone mode until you hang up or the battery becomes depleted.
- ▶ After installing a battery into the handset, the screen may show **Low battery**. If you use the speakerphone at this time, the battery may become depleted. Follow the instructions in the **Battery installation and charging** section on pages 13-15.

## Last number redial

Each handset stores the last ten telephone numbers dialed (up to 30 digits).

### To view the ten most recently dialed numbers:

- ▶ To display the most recently called number, press **REDIAL/PAUSE**.
- ▶ To view up to ten recently called numbers, press **REDIAL/PAUSE**, then **▼CID**, **▲DIR** or **REDIAL/PAUSE** repeatedly.

The handset beeps twice at the end of the list. Press **⏸/OFF/CANCEL** to exit.



## Telephone operation

### To redial a number:

- ▶ To dial the displayed number, press **\ PHONE/FLASH** or **📞/SPEAKER**.  
**-OR-**
- ▶ Press **\ PHONE/FLASH** or **📞/SPEAKER**, then press **REDIAL/PAUSE** repeatedly to view the redial memory. Press **MENU/SELECT** to dial the displayed number.



### To delete a redial entry:

- ▶ While the screen displays the desired number, press **MUTE/DELETE** to delete the number from the redial memory.

## Equalizer

---

The handset equalizer enables you to change the quality of the audio to best suit your hearing.

While on a call or intercom call, press **MENU/SELECT** to select the equalizer setting **Treble 1**, **Treble 2**, **Bass** or **Natural** (the default setting). The current setting is shown on the handset screen for two seconds.



Notes:

- ▶ If you switch the call between the handset and the speakerphone by pressing **📞/SPEAKER**, the audio setting remains unchanged.
- ▶ The current equalizer setting remains unchanged until a new setting is selected.



## Options while on calls

### Volume control

---

You can set the listening volume to one of six levels. While on a call, press

**VOL ▼ CID** to decrease or press

**VOL ▲ DIR** to increase the listening volume.

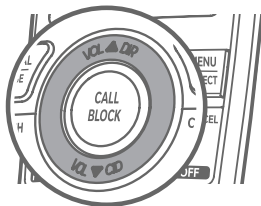

Notes:

- ▶ Handset and speakerphone volume settings are independent.
- ▶ When the volume reaches the minimum or maximum setting, you hear two beeps.

### Call waiting

---

If you subscribe to call waiting service from your telephone service provider, and someone calls while you are already on a call, you hear two beeps.

- ▶ Press **\ PHONE/FLASH** on the handset to put your current call on hold and take the new call.
- ▶ Press **\ PHONE/FLASH** on your handset at any time to switch back and forth between calls.



Note:

- ▶ If the Smart call blocker feature is on and in screening mode, and you receive a call waiting call:
  - If you have already picked up a screened call, the telephone checks whether the call waiting call's number can be found in the directory, block list or allow list. It also checks whether the caller name is in the star name list. After that, the telephone displays the caller ID information or **Blocked call** accordingly. You can press **\ PHONE/FLASH** or **▶/SPEAKER** to take the new call, or press **CALL BLOCK** on the handset to block it.
  - If the telephone is screening a call, the call waiting call will be ignored and logged as missed call in the caller ID log.



## Options while on calls

### Mute

---

Use the mute function to turn off the microphone. You can hear the caller, but the caller cannot hear you.

#### To mute a call:

- While on a call, press **MUTE/DELETE**.  
When mute is on, the handset shows **Muted** for a few seconds and **MUTE** icon displays until you turn off mute.

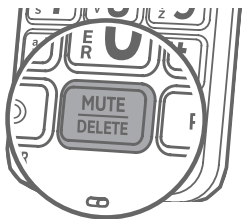

#### To end mute a call:

- Press **MUTE/DELETE** again. When mute is off, **Microphone ON** appears temporarily on the handset.





## Options while on calls

**Chain dialing**

Use this feature to initiate a dialing sequence from the numbers in the directory, caller ID log or redial memory while you are on a call.

Chain dialing is useful when you wish to access other numbers (such as bank account numbers or access codes) from the directory, caller ID log or redial list.

**To access the directory while on a call:**

1. Press **MENU/SELECT**.
2. Press **▼CID** or **▲DIR** to scroll to **Directory** and then press **MENU/SELECT**.
3. Press **▼CID** or **▲DIR** to scroll to the desired number.
4. Press **MENU/SELECT** to dial the number shown.

**To access the caller ID log while on a call:**

1. Press **MENU/SELECT**.
2. Press **▼CID** or **▲DIR** to scroll to **Caller ID log**, then press **MENU/SELECT**.
3. Press **▼CID** or **▲DIR** to scroll to the desired number.
4. Press **MENU/SELECT** to dial the number shown.

**To access the redial list while on a call:**

1. Press **REDIAL/PAUSE** to show the most recently dialed number.
2. Press **▼CID** or **▲DIR** to scroll to the desired number, or press **REDIAL/PAUSE** repeatedly to find the desired number. Press **MENU/SELECT** to dial the number shown.

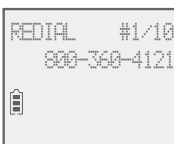
**Notes:**

- ▶ You cannot edit a directory entry while on a call. For more details about the directory, see pages 52-62.
- ▶ You cannot copy a caller ID entry into the directory while on a call. For more details about the caller ID log, see pages 63-72.
- ▶ If you press **REDIAL/PAUSE** while on a call, you can only view the ten most recently dialed numbers but you cannot erase the entries. For more details about the redial memory, see page 35.
- ▶ Press **OFF/CANCEL** on the handset to exit redial, directory or caller ID log when on a call.



## Options while on calls

### **Temporary tone dialing**

---

If you have pulse (rotary) service only, you can switch from pulse to touch-tone dialing temporarily during a call. This is useful if you need to send touch-tone signals to access your telephone banking or long distance services.

1. During a call, press **TONEX**.
2. Use the dialing keys to enter the desired number. The telephone sends touch-tone signals.
3. The telephone automatically returns to pulse dialing after you end the call.



## Options while on calls

**Blind transfer**

While on an outside call, you can transfer the call to a specific device or any device without notifying them.

**To transfer an outside call directly without notifying the desired device:**

1. During the call, press **MENU/SELECT**.
2. Press **▼CID** or **▲DIR** to scroll to **Transfer** and then press **MENU/SELECT**.
  - ▶ If you have a two-handset system and no other registered devices, the outside call is put on hold and your handset shows **Transferring call...** The other handset rings and shows **Transfer from other handset**.
  - ▶ If you have other registered device(s) or more than two handsets, your screen shows **TRANSFER TO:**. Use the dialing keys to enter a specific device number (**1-9** for handsets 1-9, **TONE\*** followed by **0-2** for handsets 10-12, or **TONE\*** followed by **#** for all devices), or press **▼CID** or **▲DIR** to scroll to the desired device and press **MENU/SELECT**. The outside call is put on hold and your handset screen shows **Transferring call...** or **Transferring call to all...** The other device rings and shows **Transfer from HANDSET X (HANDSET** represents the handset name, **X** represents the handset number).
3. To answer the call on the destination handset, press **\ PHONE/FLASH**, **📞/SPEAKER**, or any dialing key (**0-9**, **TONE\*** or **#**). The initiating handset shows **Call transferred** and goes to idle mode.

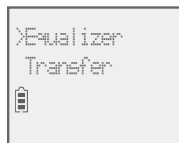
**Notes:**

- ▶ To cancel the transfer and return to the external call before the blind transfer call is answered, press **/ OFF/CANCEL**, **\ PHONE/FLASH** or **📞/SPEAKER** on your handset.
- ▶ If the other device does not answer the transfer within 30 seconds, the transfer ends and the initiating device rings while showing **No response to transfer**. If it does not pick up within 30 seconds, the device returns to idle mode and the outside call ends.



## Multiple handset use

### Handset locator

---

The handset locator feature is useful if you misplace any handsets.

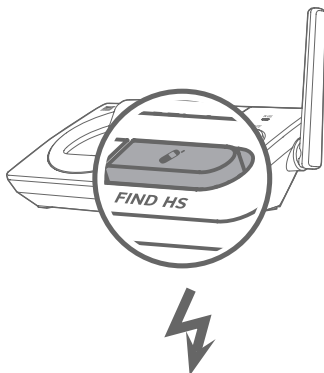

#### To start the paging tone:

- Press  **FIND HS** on the telephone base to start the paging tone on all handsets for 60 seconds.



Note: If you press  **OFF/CANCEL** or **MUTE/DELETE** on a handset, the ringer of that handset stops, but the paging to the rest of the handsets continues.

#### To stop the paging tone:

- Press  **PHONE/FLASH**,  **/SPEAKER**, or any dialing key (**0-9**, **TONE**  or **#**) on the handset(s).

-OR-

- Press  **FIND HS** on the telephone base.

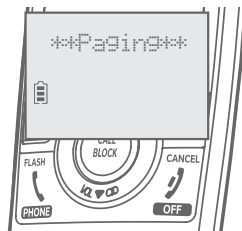

### Join a call in progress

---

When a handset is already on a call and you would like to join the call, press  **PHONE/FLASH** or  **/SPEAKER** on your handset.

To end the call using a handset, press  **OFF/CANCEL** or place the handset in the telephone base or charger. The call does not end until all handsets hang up.



Notes:

- If you have registered a cordless headset or cordless speakerphone to the telephone base, you can also join a call in progress using the registered device. Refer to the user's manuals of your cordless headset or speakerphone for more information.
- You can use up to four system handsets at the same time on an outside call.



## Intercom

Use the intercom feature for conversations between two handsets, or a handset and a cordless headset/speakerphone (sold separately). You can purchase expansion handsets (AT&T model CL80119), cordless headsets, and speakerphones (AT&T model TL80133) for this telephone base to expand your telephone system (up to 12 handsets, cordless headsets or speakerphones).

### Using a handset to initiate intercom calls:

1. Press **MENU/SELECT** in idle mode to enter the main menu. Press **▼CID** or **▲DIR** to scroll to **Intercom**, then press **MENU/SELECT**.
  - If you have a two-handset system and no other registered devices, the handset shows **Calling other handset**.
  - If you have more than two handsets and/or cordless headset(s)/speakerphone(s), the handset shows **INTERCOM TO:**. Use the dialing keys to enter a specific device number (**1-9** for handsets 1-9, **TONEX** followed by **0-2** for handsets 10-12, **#** for a single headset/speakerphone, **#** followed by **1** or **2** for headset/speakerphone 1 or 2, or **TONEX** followed by **#** for all devices), or press **▼CID** or **▲DIR** to scroll to the desired handset and press **MENU/SELECT**. Your handset screen shows **Calling HANDSET X** or **Calling all handsets**.



The destination handset(s) rings and shows **Other handset is calling**, **HANDSET X is calling** or **HANDSET X is calling all** (**HANDSET** represents the handset name, **X** represents the handset number).

2. To answer the intercom call, press **\ PHONE/FLASH**, **📞/SPEAKER** or any dialing key (**0-9**, **TONEX**, or **#**) on the called device. Both devices now show **Intercom**.



## Intercom

3. To end the intercom call, one party presses **⏏ OFF/CANCEL**, or place the handset back in the telephone base or charger. The other party hears four beeps. Both devices display **Intercom ended**.



### Notes:

- ▶ Before the intercom call is answered, you can cancel it by pressing **⏏ OFF/CANCEL**.
- ▶ If the called party does not answer within 100 seconds or if the handset is in use, on a call or out of range, the initiating device shows **No answer. Try again**.
- ▶ To temporarily silence the intercom ringer, press **⏏ OFF/CANCEL** or **MUTE/DELETE**.
- ▶ You can only use one pair of handsets at a time to make intercom calls.
- ▶ For cordless headsets and speakerphones, refer to the corresponding user's manual on how to answer and end an intercom call.
- ▶ If a total of two cordless headset(s) and/or speakerphone(s) are registered to the telephone base, they appear as **HEADSET 1** and **HEADSET 2**, respectively.

## Answer an incoming call during an intercom call

---

If you receive an outside call during an intercom call, there is a two-beep call waiting tone.

- ▶ To answer the call, press **⏏ PHONE/FLASH**. The intercom call ends automatically. The party on the intercom call hears four beeps. Other system devices can also answer the incoming call by pressing **⏏ PHONE/FLASH**.
- ▶ To end the intercom call without answering the incoming call, press **⏏ OFF/CANCEL** on the handset.



## Call transfer using intercom

Use the intercom feature to transfer an outside call to another system device. You can also share an outside call with another system device.

### To transfer or share an outside call using intercom:

1. During the call, press **MENU/SELECT**.
2. Press ▼**CID** or ▲**DIR** to scroll to **Intercom** and press **MENU/SELECT**.
3. If you have a two-handset system and no other registered devices, your handset screen shows **Calling other handset**.

### -OR-

If you have more than two handsets and/or cordless headset(s)/speakerphone(s), your screen shows **INTERCOM TO:**. Use the dialing keys to enter a specific device number (**1-9** for handsets 1-9, **TONE ✕** followed by **0-2** for handsets 10-12, or **TONE ✕** followed by **#** for all devices), or press ▼**CID** or ▲**DIR** to scroll to the desired handset and press **MENU/SELECT**. Your handset screen shows **Calling HANDSET X**, or **Calling all handsets**.

4. When the destination handset picks up, your handset shows **Intercom** and the outside call is put on hold. You have the following options:
  - ▶ You can transfer the call. Press **MENU/SELECT**, then press ▼**CID** or ▲**DIR** to scroll to **Transfer**. Press **MENU/SELECT** again. The handset shows **Call transferred**. The other handset automatically connects to the outside call.
  - ▶ You can let the other handset join you on the outside call in a three-way conversation. Press **MENU/SELECT**. Press ▼**CID** or ▲**DIR** to highlight **Share call**, then press **MENU/SELECT**.
  - ▶ You can end the intercom call and continue the outside call with your handset. Press \ **PHONE/FLASH** on your handset (the ended intercom call party hears four beeps).



## Push-to-talk (PTT)

You can directly broadcast messages to the speakerphone of any device. Press and hold **PTT** on a handset to begin two-way communication.

- ▶ Only one device can talk at a time. To do so, press and hold **PTT**.
- ▶ You must release **PTT**, so the other person can respond.
- ▶ Only one PTT session can be active at a time.
- ▶ While PTT is in use between two devices, other devices cannot use the intercom feature but can access the answering system.
- ▶ When you attempt to place a PTT call to another device which is accessing the answering system or on an intercom call or outside call, your device screen shows **Not available at this time**.

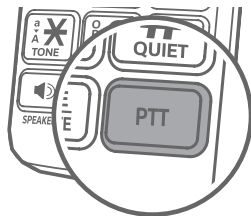

Note: The PTT function is not available when QUIET mode is on or if you have only one handset.

### Turn PTT on or off

1. Press **PTT** when the handset is not in use. The **PUSH TO TALK** menu displays.
2. Press ▼**CID** or ▲**DIR** to highlight **PTT On/Off**, then press **MENU/SELECT**.
3. Press ▼**CID** or ▲**DIR** to choose **On** or **Off**, then press **MENU/SELECT**.



Note: The handset screen displays **No Incoming PTT** when PTT is turned off.



# Push-to-talk (PTT)

## PTT call to a single device

- There are a few ways to begin a PTT call to a single device. When the handset is not in use:
  - If you have a two-handset system, press and hold **PTT**.
  - If you have more than two handsets:
    - Press **PTT** on the handset, then use the dialing keys to enter the destination device number.
    - OR-
    - Press **PTT** on the handset. Press ▼ **CID** or ▲ **DIR** to highlight the destination device number, then press **MENU/SELECT** or **PTT**.



The handset shows **Connecting to HANDSET X...** (**HANDSET** represents the handset name, **X** represents the destination handset number). When the connection is made, both your and the destination device screens display **Press and hold [PTT] to talk**.

- Press and hold **PTT**. A chirp indicates your microphone is on. Speak towards the device. Your voice is broadcast to the destination device. While you are speaking, your handset shows **PTT To handset: X**.



- Release **PTT** after speaking. Both devices beep once again and the screens show **Press and hold [PTT] to talk**, then you can press and hold **PTT** to continue speaking or the destination device can respond (see **Answer a PTT call** on page 49).
- To end the PTT call, press **/ OFF/CANCEL** or place the handset in the telephone base or charger. The handset shows **Push to talk Ended**.



## Push-to-talk (PTT)

### PTT call to multiple devices

---

When there are multiple handsets registered to the phone system, PTT supports one-to-group calls. PTT supports a maximum of one-to-four calls when one to five handsets are registered, and a maximum of one-to-three calls when six or more handsets are registered. The first four registered handsets will be able to use this feature. Other handsets can only use PTT for one-to-one calls.

#### To call multiple devices:

1. You have three ways to call multiple devices. When the handset is not in use:
  - ▶ Press and hold **PTT** until the handset shows **Connecting to group...**
  - ▶ Press **PTT**. Press ▼**CID** or ▲**DIR** to choose **Group**. Press **MENU/SELECT** or press **PTT** and your handset shows **Connecting to group...**
  - ▶ Press **PTT**. Press **TONEX** followed by **#** (pound key). The handset shows **Connecting to group....**

When the connection is made, both the caller and the destination parties hear a beep. The speakerphones on all other devices automatically activate.

2. You need to press and hold **PTT** when you want to speak. Speak towards the handset. Your voice is broadcast to all devices.
3. Release **PTT** after speaking.
4. Any extension can reply (see **Answer a PTT call** on page 49).



Note: After **PTT** on the handset is released, the PTT call remains open for a short time. If no one presses **PTT** on the handset within ten seconds, the PTT call ends automatically.



## Push-to-talk (PTT)

### Answer a PTT call

---

You can respond to a PTT call, as described below.

1. When your device receives a PTT call, it beeps and shows **Press and hold [PTT] to talk**.
2. When the other party is speaking, your speakerphone light is on, and your device shows **PTT From HS X To HS X** (the first **X** represents the initiating handset number, and the second **X** represents your handset number; a maximum of four handset numbers appear).
3. When your speakerphone light is off (the screen shows **Press and hold [PTT] to talk**), press and hold PTT on your handset. You will hear a chirp. Speak towards the device.
  - While you are speaking, your device shows **PTT To handset: X** (**X** represents the handset numbers of one or more destination handsets; a maximum of four handset numbers appear).
  - Your voice is broadcast to all destination devices.

After speaking, release **PTT**. Your device will beep. After the beep, if your speakerphone light is off, you can press and hold PTT to continue speaking.

### Change a one-to-one PTT call to an intercom call

---

You can convert a one-to-one PTT session to an intercom call.

1. When your device shows **Press and hold [PTT] to talk**, press **MENU/SELECT**. The screen shows **Intercom**.
2. Press **MENU/SELECT**. Your device displays **Calling other handset** or **Calling HANDSET X**. The destination device briefly shows **Push to talk Ended** and then **Other handset is calling** or **HANDSET X is calling**. The destination device rings.
3. Press **\ PHONE/FLASH** or any dialing keys (**0-9, #** or **TONEx**) on the destination device to answer the intercom call. Both devices now show **Intercom**.
4. To end the intercom call, press **∕ OFF/CANCEL** on your handset or place the handset in the telephone base or charger. Both screens show **Intercom ended**.



## Push-to-talk (PTT)

### Answer an incoming call during a PTT call

---

When you receive an outside call during PTT, there is an alert tone.

- ▶ During a one-to-one PTT, press **\ PHONE/FLASH** on the initiating or destination handset. The PTT call ends automatically and the outside call is answered.
- ▶ During a one-to-group PTT call, press **\ PHONE/FLASH** on the initiating handset. The PTT call ends automatically and the outside call is answered.
- ▶ During a one-to-group PTT call, press **\ PHONE/FLASH** on any one of the destination handsets. That device answers the outside call. The PTT call continues for the rest of the PTT participants.
- ▶ To leave the PTT call without answering the incoming call, press **/ OFF/CANCEL**. The telephone continues to ring.

### Make an outgoing call during PTT call

---

- ▶ During a one-to-one PTT call, press **\ PHONE/FLASH** to get a dial tone. The PTT call ends automatically.
- ▶ During a one-to-group PTT call, press **\ PHONE/FLASH** on the initiating handset. The PTT call ends automatically and you get a dial tone.
- ▶ During a one-to-group PTT call, press **\ PHONE/FLASH** on any one of the destination handsets. That device gets a dial tone. The PTT call continues for the rest of the PTT participants.



## Push-to-talk (PTT)

### End or leave a PTT call

---

For one-to-one PTT calls, both initiating and destination devices can end the PTT call. For PTT calls to multiple devices, the initiating device can end the PTT call. If any one of the destination devices leaves the PTT call, the call continues until all participants or the initiator hangs up.

Press **⏏ OFF/CANCEL** on the handset. The screen shows **Push to talk Ended**.

-OR-

Place the handset in the telephone base or charger, then the handset returns to idle mode.



Note: After **PTT** is released, the PTT call remains open for a short time. If no one presses **PTT** within ten seconds, the PTT call ends automatically.



## About the directory

### Shared directory

---

The directory is shared by all handsets. Changes made to the directory from any device apply to all.



Note:

- ▶ Only one handset can review the directory at a time. If another device tries to enter the directory, the screen shows **Not available at this time**.
- ▶ Directory entries can also be saved to the allow list or block list. See **Allow list** on page 84 and **Block list** on page 79.
- ▶ When Smart call blocker is on, calls with numbers saved in the directory will get through and ring on your telephone. If a number saved in the directory is also saved in the block list, calls from this number will be blocked.



### Capacity

---

The directory can store up to 50 entries, with a maximum of 15 alphanumeric characters (including spaces) for names and 30 digits for telephone numbers. A convenient search feature can help you find and dial numbers quickly (page 56).

If you try to save an entry when there are already 50 entries, the screen shows **Directory full**. You cannot store a new number until you delete one.



# Create directory entries

## Create a new directory entry

1. Press **MENU/SELECT** in idle mode to enter the main menu.
2. Press **▼CID** or **▲DIR** to scroll to **Directory**, then press **MENU/SELECT**.
3. Press **▼CID** or **▲DIR** to highlight **Add contact**.
4. Press **MENU/SELECT**.
5. Use the dialing keys to enter a telephone number (up to 30 digits) when prompted.
  - ▶ Press **▼CID** or **▲DIR** to move the cursor to the left or right.
  - ▶ Press **MUTE/DELETE** to erase a digit.
  - ▶ Press and hold **MUTE/DELETE** to erase all digits.
  - ▶ Press and hold **REDIAL/PAUSE** to enter a three-second dialing pause (a **p** appears).

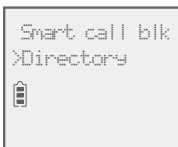

### -OR-

Copy a number from the redial list by pressing **REDIAL/PAUSE**, then **▼CID** or **▲DIR**, or pressing **REDIAL/PAUSE** repeatedly to locate the number. Press **MENU/SELECT** to copy the number.

6. Press **MENU/SELECT** to move on to the name.
  - ▶ The screen shows **Number already saved** if the number is already in the directory. You cannot save the same number twice.
7. Use the dialing keys to enter a name (up to 15 characters) when prompted. Each time you press a key, the character on that key appears. Additional key presses produce other characters on that key. See the chart on next page.
  - ▶ Press **▼CID** or **▲DIR** to move the cursor to the left or right.
  - ▶ Press **0** to add a space.
  - ▶ Press **MUTE/DELETE** to erase a character.
  - ▶ Press and hold **MUTE/DELETE** to erase all characters.
  - ▶ Press **-tone X** to change the next letter to upper or lower case.





# Create directory entries



Note: The first letter of every word is a capital letter. The remaining letters in a word start as lower case letters, as shown in the chart below.

Dialing keys	Characters by number of key presses										
	1	2	3	4	5	6	7	8	9	10	11
1	1	.	-	'	(	)	*	#	&	/	,
2	A	B	C	a	b	c	2				
3	D	E	F	d	e	f	3				
4	G	H	I	g	h	i	4				
5	J	K	L	j	k	l	5				
6	M	N	O	m	n	o	6				
7	P	Q	R	S	p	q	r	s	7		
8	T	U	V	t	u	v	8				
9	W	X	Y	Z	w	x	y	z	9		
0	space	0									
*											
#											

- Press **MENU/SELECT** to store your new directory entry. There is a confirmation tone and the screen shows **Saved to directory**. To change the entry later, see page 58.

## Add a predialed telephone number to the directory

You can save a predialed telephone number to the directory.

- Enter the telephone number when in idle mode.
- Follow the steps in **Edit a directory entry** on page 58.



# Review the directory

## Review directory entries

---

1. Press **▲DIR** when in idle mode. The summary screen shows briefly and then the first entry in the directory shows.

**-OR-**

Press **MENU/SELECT** when in idle mode, then press **▼CID** or **▲DIR** to scroll to **Directory**. Press **MENU/SELECT** twice.

2. Press **▼CID** or **▲DIR** to browse through the directory. Entries appear alphabetically by the first letter in the name.



Notes:

- ▶ If the telephone number in the directory exceeds 15 digits, **<X** appears in front of the telephone number. Press **TONE X** to move towards the end of the telephone number or press **#** (pound key) to move towards the beginning of the telephone number.
- ▶ If there are no directory entries when you press **▲DIR** in idle mode, **Directory empty** appears briefly on the screen, followed by **Add contact?**. If you would like to add a new contact, press **MENU/SELECT** and refer to page 53 for instructions on creating a new directory entry. Otherwise, press **↵OFF/CANCEL** to cancel.



# Search the directory

## Search by name

---

1. Press **▲DIR** in idle mode to show the first listing in the directory.
2. When an entry appears, press the dialing keys (**0-9**) to start a name search. The directory shows the first name beginning with the first letter associated with the dialing key, if there is an entry in the directory beginning with that letter. Press **▼CID** or **▲DIR** to scroll through the directory.
3. To see other names starting with the letters on the same dialing key, keep pressing the key. The names appear in alphabetical order.

For example, if you have the names **Jennifer**, **Jessie**, **Kevin** and **Linda** in your directory:

- If you press **5 (JKL)** once, you see **Jennifer**. Press **▼CID** and you see **Jessie**.
- If you press **5 (JKL)** twice, you see **Kevin**.
- If you press **5 (JKL)** three times, you see **Linda**.
- If you press **5 (JKL)** four times, you see **5** and then the directory entry beginning with 5 or the next closest entry after 5.
- If you press **5 (JKL)** five times, you see **Jennifer** again.



### Notes

- If there is no name matching the first letter of the key you press, the directory shows a name matching the following letters of the key.
- If you press a key (**0-9**) and no name starts with any of the letters on that key, the directory shows the entry matching the next letter in the directory.



## Dial, delete or edit directory entries

To dial, delete or edit a directory entry (name and number), the entry must be displayed on the screen. Use **Review the directory** (page 55) or **Search by name** (page 56) to show an entry.

### Display dial

---

To dial a displayed number from the directory, press  
**\ PHONE/FLASH** or **🔊/SPEAKER**.

### Delete a directory entry

---

To delete the displayed directory entry, press  
**MUTE/DELETE**. Press **MENU/SELECT** to confirm.  
There is a confirmation tone and the screen  
shows **Contact deleted**. You cannot retrieve a  
deleted entry.

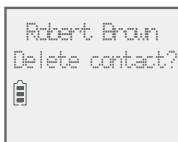



## Dial, delete or edit directory entries

**Edit a directory entry**

1. When a directory entry displays, press **MENU/SELECT**. The screen shows **EDIT NUMBER** along with the phone number to be edited. If you only want to edit the name, skip to Step 3.
2. To edit the number:
  - ▶ Press the dialing keys to add digits.
  - ▶ Press ▼**CID** or ▲**DIR** to move the cursor to the left or right.
  - ▶ Press **MUTE/DELETE** to erase a digit.
  - ▶ Press and hold **MUTE/DELETE** to erase all digits.
  - ▶ Press and hold **REDIAL/PAUSE** to add a three-second dialing pause (a **p** appears).
3. Press **MENU/SELECT** to move on to the name. The screen shows **EDIT NAME** along with the name to be edited.
4. To edit the name:
  - ▶ Press the dialing keys to add characters (page 54).
  - ▶ Press ▼**CID** or ▲**DIR** to move the cursor to the left or right.
  - ▶ Press **0** to add a space.
  - ▶ Press **MUTE/DELETE** to erase a character.
  - ▶ Press and hold **MUTE/DELETE** to erase all characters.
  - ▶ Press **tone** **X** to change the next letter to upper or lower case.
5. Press **MENU/SELECT** to save the entry. There is a confirmation tone and the screen shows **Saved to directory**.

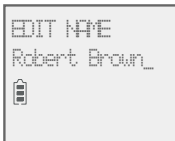

Note: If the telephone number has more than 11 digits, **EDIT NUMBER** will not be displayed on the screen.



## Directory Speed dial

The telephone system has nine speed dial locations (2-9, 0) and a voicemail access location  **1** where you can store the telephone numbers you wish to dial more quickly. You can store up to 30 digits in each location. Speed dial assignments can only be selected from the existing directory entries. The voicemail access number must

be manually entered. In the directory, speed dial locations are indicated by their number on the bottom of the screen.



Speed dial location

### Assign a speed dial number

1. When the telephone is idle, press **MENU/SELECT**.
2. Press **▼CID** or **▲DIR** to scroll to **Directory**. Press **MENU/SELECT**.
3. Press **▼CID** or **▲DIR** to scroll to **Speed dial**. Press **MENU/SELECT**.
4. Press **▼CID** or **▲DIR** to choose your desired speed dial location (**0** or **2-9**), then press **MENU/SELECT**. The screen briefly shows **Copy from Directory...** and then displays the directory list.
5. Press **▼CID** or **▲DIR** to scroll to the phone number you wish to assign to the selected speed dial location.
6. Press **MENU/SELECT** to save the setting and return to the previous menu. There is a confirmation tone and the screen returns to the speed dial list.

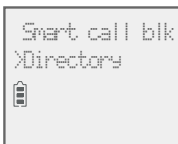

### -OR-

1. When the telephone is idle, press and hold any dialing keys (**0** or **2-9**).
2. Press **▼CID** or **▲DIR** to choose your desired speed dial location (**0** or **2-9**), then press **MENU/SELECT**. The screen briefly shows **Copy from Directory...** and then displays the directory list.



## Directory Speed dial

3. Press ▼ **CID** or ▲ **DIR** to scroll to the phone number you wish to assign to the selected speed dial location.
4. Press **MENU/SELECT** to save the setting and return to the previous menu. There is a confirmation tone and the screen returns to the speed dial list.

### Assign your voicemail speed dial number

---

To assign your voicemail speed dial number to location  **1**, see page 27.

### Reassign a speed dial number

---

1. When the telephone is idle, press **MENU/SELECT**.
2. Press ▼ **CID** or ▲ **DIR** to scroll to **Directory**. Press **MENU/SELECT**.
3. Press ▼ **CID** or ▲ **DIR** to scroll to **Speed dial**. Press **MENU/SELECT**.
4. Press ▼ **CID** or ▲ **DIR** to choose the location you wish to reassign, then press **MENU/SELECT** to show the directory entry.
5. Press **MENU/SELECT** again.
6. Scroll to **Change SD** and then press **MENU/SELECT**. The screen briefly shows **Copy from Directory...** and then displays the directory list.
7. Press ▼ **CID** or ▲ **DIR** to scroll to the phone number you wish to reassign to the selected speed dial location.
8. Press **MENU/SELECT** to save the setting and return to the speed dial list. There is a confirmation tone.





## Directory Speed dial

### Delete a speed dial number

---

1. When the telephone is idle, press **MENU/SELECT**.
2. Press ▼**CID** or ▲**DIR** to scroll to **Directory**. Press **MENU/SELECT**.
3. Press ▼**CID** or ▲**DIR** to scroll to **Speed dial**. Press **MENU/SELECT**.
4. Press ▼**CID** or ▲**DIR** to scroll to the location you wish to delete the speed dial number from, then:
  - Press **MUTE/DELETE** to delete the displayed speed dial number. There is a confirmation tone and the screen shows **Speed dial empty** before returning to the speed dial list.

#### -OR-

- i. Press **MENU/SELECT** to show the directory entry.
- ii. Press **MENU/SELECT** again.
- iii. Scroll to **Clear SD** and then press **MENU/SELECT** to delete the displayed speed dial number. There is a confirmation tone and the screen shows **Speed dial empty** before returning to the speed dial list.

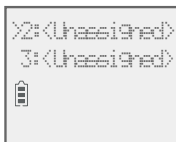



## Directory Speed dial

### Make a call using speed dial

---

When in idle mode, press and hold the dialing key (**0** or **2-9**) corresponding to the assigned location you wish to call.

**-OR-**

1. Press **MENU/SELECT** when in idle mode.
2. Press ▼ **CID** or ▲ **DIR** to scroll to **Directory**, then press **MENU/SELECT**.
3. Press ▼ **CID** or ▲ **DIR** to scroll to **Speed dial**, then press **MENU/SELECT**.
4. Press ▼ **CID** or ▲ **DIR** to scroll to the desired location (**0** or **2-9**) and then press \ **PHONE/FLASH** or 🔊 **/SPEAKER**.

### Check your voicemail using speed dial

---

When in idle mode, press and hold  **1** to dial the voicemail number you have set. See page 27 to set your voicemail speed dial number.



## About caller ID

This product supports caller ID services offered by most telephone service providers. Caller ID allows you to see the name, number, date and time of calls. The available caller ID information will appear after the first or second ring.

### Information about caller ID with call waiting

---

Caller ID with call waiting lets you see the name and telephone number of the caller before answering the call, even while on another call.

It may be necessary to change your telephone service to use this feature. Contact your telephone service provider if:

- ▶ You have both caller ID and call waiting, but as separate services (you may need to combine these services).
- ▶ You have only caller ID service, or only call waiting service.
- ▶ You don't subscribe to caller ID or call waiting services.

There are fees for caller ID services. In addition, services may not be available in all areas.

This product can provide information only if both you and the caller are in areas offering caller ID service and if both telephone service providers use compatible equipment. The time and date, along with the call information, are from the telephone service provider.

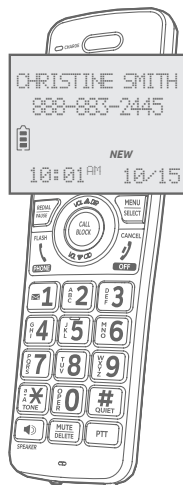

Caller ID information may not be available for every incoming call. Callers may intentionally block their names and/or telephone numbers. You can only view a maximum of 15 digits of every caller ID log entry. To view caller ID log entries with numbers between 16 and 24 digits, you must save the entry to the directory (see page 69).



Note: You can use this product with regular caller ID service, or you can use this product's other features without subscribing to caller ID or combined caller ID with call waiting service.



# Caller ID log

## How the caller ID log works

---

The telephone stores caller ID information about the last 50 incoming calls. Entries are stored in reverse chronological order. The phone deletes the oldest entry when the log is full to make room for new calls. This information is common to all handsets, so changes made using any handset are reflected in all other devices. If you answer a call before the information appears on the screen, it does not show in the caller ID log.



Note: Each entry may have up to 24 digits for the phone number and 15 characters for the name.

## Missed (new) call indicator

---

When a handset is in idle mode and has new or missed calls, its screen shows **XX Missed calls**.

All new and missed entries are counted as missed calls. Each time you review a new caller ID log entry (indicated by **NEW** on the screen), the number of missed calls decreases by one.

If you do not want to review the missed calls one by one, but still want to keep them in the caller ID log, you can press and hold **⏏/CANCEL** for four seconds when the handset is idle. You will hear a confirmation tone. All the entries in the caller ID log become old (reviewed already), and the missed calls message goes away.

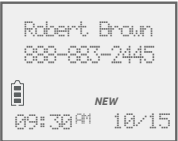



# Caller ID operation

## Memory match

If the incoming telephone number matches the last 7 digits of a telephone number in your directory, the name that appears on the screen matches the corresponding name in your directory.

For example, if Christine Smith calls, her name appears as **Chris** if this is how you entered it into your directory.



Note: The number shown in the caller ID log will be in the format sent by the telephone service provider. The telephone service provider usually delivers ten-digit phone numbers (area code plus telephone number). If the telephone number of the caller does not match a number in your directory, the name will appear as it is delivered by the telephone service provider.

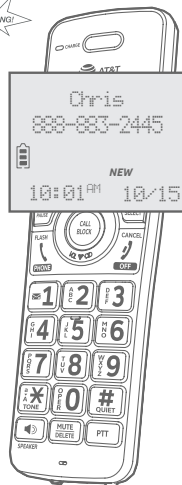



# Caller ID operation

## Review the caller ID log

Review the caller ID log to find out who called, to return the call, or to copy the caller's name and number into your directory. **Caller ID log empty** appears if there are no records in the caller ID log.

1. When the handset is in idle mode, press **▼CID** to review the caller ID log in reverse chronological order starting with the most recent call.

**-OR-**

Review the caller ID log by pressing **MENU/SELECT**. Press **▼CID** or **▲DIR** to scroll to **Caller ID log**, then press **MENU/SELECT** twice to select **Review**.

2. Press **▼CID** or **▲DIR** to scroll through the list.
3. Press **↵OFF/CANCEL** to exit the caller ID log.

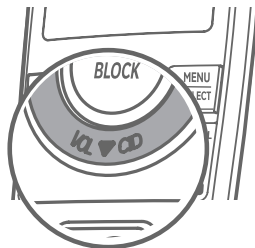

You hear a double beep when the list reaches the beginning or end of the caller ID log.



Note: Only one handset can review the caller ID log at a time. If another device tries to enter the directory or caller ID log, it shows **Not available at this time**.

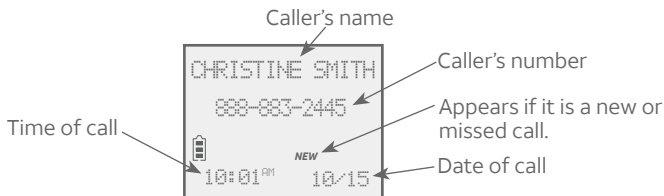



# Caller ID operation

## View dialing options

---

The incoming caller ID log entries have 10 digits (the area code plus the seven-digit number). You can add 1 in front of the telephone number before you dial in the caller ID log or store to the directory.

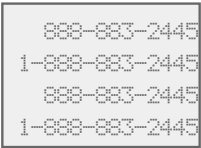

While reviewing the caller ID log, press **#** (pound key) or **1** repeatedly if you need to add or remove 1 in front of the telephone number before dialing or saving it in the directory.

Press **#** (pound key)  
or press **1**

When the number is in the correct format for dialing, press **\ PHONE/FLASH** or **📞/SPEAKER** to call the number.

To save the number to the directory, allow list, block list or star name list, see page 69, page 86, page 81 and page 90.



## Caller ID operation

### Dial a caller ID log entry

---

1. When in the caller ID log, press ▼**CID** or ▲**DIR** to browse.
2. Press \ **PHONE/FLASH** or 📞/**SPEAKER** to dial the displayed entry.

### Delete caller ID log entries

---

#### To delete an entry:

- ▶ Press **MUTE/DELETE** to delete the shown entry.

#### To delete all entries:

1. Press **MENU/SELECT** when in idle mode.
2. Press ▼**CID** or ▲**DIR** to scroll to **Caller ID log**, then press **MENU/SELECT**.
3. Press ▼**CID** or ▲**DIR** to scroll to **Del all calls**, then press **MENU/SELECT**.
4. When the screen shows **Delete all calls?**, press **MENU/SELECT** to confirm. There is a confirmation tone and the screen returns to the previous menu.





# Caller ID operation

## Save a caller ID log entry to the directory

---

1. When in the caller ID log, press **▼CID** or **▲DIR** to browse.
2. When the desired entry displays, press **MENU/SELECT**.
3. Press **MENU/SELECT** to choose **Directory**.
4. When the screen displays **EDIT NUMBER**, use the dialing keys to edit the number.
  - ▶ Press **▼CID** or **▲DIR** to move the cursor to the left or right.
  - ▶ Press **MUTE/DELETE** to backspace and erase a digit.
  - ▶ Press and hold **MUTE/DELETE** to erase the entire entry.
  - ▶ Press and hold **REDIAL/PAUSE** to insert a three-second dialing pause (a **p** appears).
5. Press **MENU/SELECT** to move to the name.
6. When the screen displays **EDIT NAME**, use the dialing keys (page 54) to edit the name.
  - ▶ Press **▼CID** or **▲DIR** to move the cursor to the left or right.
  - ▶ Press **0** to add a space.
  - ▶ Press **MUTE/DELETE** to erase a character.
  - ▶ Press and hold **MUTE/DELETE** to erase all characters.
  - ▶ Press **#** (pound key) to move the last word to the front. For example, **Johnson Charlie** becomes **Charlie Johnson** when you press **#** (pound key).
  - ▶ Press **TONE✕** to change the next letter to upper or lower case.
7. Press **MENU/SELECT** when done. The screen shows **Saved to directory**.



### Notes:

- ▶ You may need to change how a caller ID number is dialed if the entry does not appear in the correct format (see **View dialing options** on page 67).
- ▶ If the caller's name you received from the telephone service provider is all in capital letters, the first letter of every word remains a capital letter, while other letters become lower case. However, the next letter after the prefix "Mac", "Mc", "D", "C" or "O", is kept as a capital letter. For example, the "D" in "MacDonald" is kept as a capital letter. Another exception is that "VAN DER" will be changed to "Van der".
- ▶ If the telephone number from the caller ID information has already been saved in the directory under a different name, the new name will overwrite the old one.
- ▶ If you save a blocked number in the caller ID log to the directory, the original name from the caller ID information will be saved.



## Caller ID operation

### Save a caller ID log entry to the allow list

---

1. When in the caller ID log, press **▼CID** or **▲DIR** to browse.
2. When the desired entry displays, press **MENU/SELECT**.
3. Press **▼CID** or **▲DIR** to choose **Allow list**, then press **MENU/SELECT**.
4. When the screen displays **EDIT NUMBER**, use the dialing keys to edit the number.
  - Press **▼CID** or **▲DIR** to move the cursor to the left or right.
  - Press **MUTE/DELETE** to backspace and erase a digit.
  - Press and hold **MUTE/DELETE** to erase the entire entry.
  - Press and hold **REDIAL/PAUSE** to insert a three-second dialing pause (a **p** appears).
5. Press **MENU/SELECT** to move to the name.
6. When the screen displays **EDIT NAME**, use the dialing keys (page 54) to edit the name.
  - Press **▼CID** or **▲DIR** to move the cursor to the left or right.
  - Press **0** to add a space.
  - Press **MUTE/DELETE** to erase a character.
  - Press and hold **MUTE/DELETE** to erase all characters.
  - Press **#** (pound key) to move the last word to the front. For example, **Johnson Charlie** becomes **Charlie Johnson** when you press **#** (pound key).
  - Press **TONEX** to change the next letter to upper or lower case.
7. Press **MENU/SELECT** when done. The screen shows **Saved to allow list**.

### Save a caller ID log entry to the block list

---

1. When in the caller ID log, press **▼CID** or **▲DIR** to browse.
2. When the desired entry displays, press **MENU/SELECT**.
3. Press **▼CID** or **▲DIR** to choose **Block list**, then press **MENU/SELECT**.
4. When the screen displays **EDIT NUMBER**, use the dialing keys to edit the number.



## Caller ID operation

- ▶ Press **▼CID** or **▲DIR** to move the cursor to the left or right.
  - ▶ Press **MUTE/DELETE** to backspace and erase a digit.
  - ▶ Press and hold **MUTE/DELETE** to erase the entire entry.
  - ▶ Press and hold **REDIAL/PAUSE** to insert a three-second dialing pause (a **p** appears).
5. Press **MENU/SELECT** to move to the name.
  6. When the screen displays **EDIT NAME**, use the dialing keys (page 54) to edit the name.
    - ▶ Press **▼CID** or **▲DIR** to move the cursor to the left or right.
    - ▶ Press **0** to add a space.
    - ▶ Press **MUTE/DELETE** to erase a character.
    - ▶ Press and hold **MUTE/DELETE** to erase all characters.
    - ▶ Press **#** (pound key) to move the last word to the front. For example, **Johnson Charlie** becomes **Charlie Johnson** when you press **#** (pound key).
    - ▶ Press **TONE~~X~~** to change the next letter to upper or lower case.
  7. Press **MENU/SELECT** when done. The screen shows **Saved to block list**.

### Save a caller ID log entry to the star name list

---

1. When in the caller ID log, press **▼CID** or **▲DIR** to browse.
2. When the desired entry displays, press **MENU/SELECT**.
3. Press **▼CID** or **▲DIR** to choose **Star name list**, then press **MENU/SELECT**.
4. When the screen displays **Star this name?** and the caller's name, press **MENU/SELECT** to confirm. The screen shows **Saved to star name list**.

Star this name?  
Bairiver Elene





## Reasons for missing caller ID information

There are occasions when other information or no information shows for various reasons:

On-screen message	Reason
PRIVATE NUMBER	The caller prefers not to show the phone number.
PRIVATE NAME	The caller prefers not to show the name.
PRIVATE CALLER	The caller prefers not to show the phone number and name.
UNKNOWN NUMBER	Your telephone service provider cannot determine the caller's number.
UNKNOWN NAME	Your telephone service provider cannot determine the caller's name.
UNKNOWN CALLER	<p>Your telephone service provider cannot determine the caller's name and telephone number.</p> <p>Calls from other countries may also generate this message.</p>



## About Smart call blocker\*

If you have subscribed to caller ID service, then you can use Smart call blocker to filter robocalls, telemarketing calls and unwanted calls, while allowing welcome calls to get through.

You can set up your lists of welcome callers and unwelcome callers. Smart call blocker allows calls from your welcome callers to get through, and it blocks calls from your unwelcome callers.

For other unknown calls, you can allow these calls, block these calls, or forward these calls to the answering system.

With some easy configurations, you can set to only filter robocalls by asking the callers to press the pound key (#) before the calls are put through to you.

You can also set Smart call blocker to screen incoming calls by asking the callers to record their names and press the pound key (#). After your caller completes the request, your telephone rings and announces the caller's name. You can then choose to block or answer the call, or you can forward the call to the answering system. If the caller does not respond or record his/her name, the call is blocked from ringing through. When you add your welcome callers to your directory or allow list, they will bypass all screening and ring directly to your handsets.



### Notes:

- ▶ Smart call blocker is on, once you install your telephone. It allows all incoming calls to get through and ring by default. You can change the Smart call blocker settings to screen incoming calls. For more details, see **Set profile** (page 77).
- ▶ With call screening active, Smart call blocker screens and filters all incoming calls from numbers or names that are not yet saved in your directory, allow list, block list, or star name list. You can easily add incoming phone numbers to your allow list and block list. This allows you to build up your lists of allowed and blocked numbers, and Smart call blocker will know how to deal with these calls when they come in again.
- ▶ To turn off Smart call blocker, see **Set Smart call blocker on/off** on page 77.

\* Includes licenced Qaltel™ technology.

Qaltel™ is a trademark of Truecall Group Limited.



# About Smart call blocker

## Call categories

---

Calls are classified into four categories:

### Welcome calls

Welcome calls are calls with telephone numbers saved in your allow list or directory, and not in your block list. Welcome calls also include calls with caller names saved in your star name list.



Note: There are many organizations like schools, medical offices, and pharmacies that use robocalls to communicate important information to you. Robocall uses an autodialer to deliver pre-recorded messages. By entering the name of the organizations into the star name list, it ensures these calls will ring through when you only know the caller names but not their numbers.

### Unwelcome calls

Unwelcome calls are calls with telephone numbers saved in your block list, and you want to block their calls.

### Calls without numbers

Calls without numbers are calls that are “out of area” or with numbers set to “Private”.

### Uncategorized calls

Uncategorized calls include calls with absent caller ID number, calls with numbers that are not in your directory, allow list, or block list, or calls with caller ID names that are not in your star name list.



Note: The allow list stores up to 200 entries, the block list stores up to 1,000 entries, and the star name list stores up to 10 names.



# About Smart call blocker

## Call controls

- ▶ Smart call blocker is set to on, and to allow all incoming calls by default. When Smart call blocker is on, the first ring of all incoming calls will be muted.
- ▶ If your directory, allow list, star name list and block list are empty when Smart call blocker is on, and you have set to screen calls, the telephone will screen all incoming calls and asks callers to announce their names or press the pound key (#).
- ▶ If Smart call blocker is off, all incoming calls ring, including numbers saved in the block list.
- ▶ If QUIET mode is on, and Smart call blocker is on and in screening mode, all screened calls will be sent to the answering system after screening.

Smart call blocker handles calls in the following ways:

Call category		Call handling / Set profile options
<b>Welcome calls</b>	<ul style="list-style-type: none"> <li>▶ Numbers saved in allow list.</li> <li>▶ Numbers saved in directory.</li> <li>▶ Numbers not found in block list.</li> <li>▶ Caller ID names saved in star name list.</li> </ul>	The telephone rings when there is an incoming call with number saved in your allow list or directory, but not in your block list. Robocalls with caller names saved in your star name list will also ring.
<b>Unwelcome calls</b>	<ul style="list-style-type: none"> <li>▶ Numbers saved in block list.</li> </ul>	The telephone does not ring when there is an incoming call with number saved in your block list, and the call will be rejected.



# About Smart call blocker

Call category		Call handling / Set profile options
<b>Unknown calls</b>	<ul style="list-style-type: none"> <li>Calls without numbers               <ul style="list-style-type: none"> <li>Numbers that are “out of area” or set to “Private”.</li> </ul> </li> </ul>	<p>You can select one of the following five profile options for handling all unknown calls.</p> <p><b>Screen unknown</b> The telephone plays the screening announcement, and then ask the caller to say his/her name before the call rings on your telephone. You can then answer the call, and hear the caller’s name announced. You can decide whether to accept or reject the call, or to forward the call to the answering system.</p> <p><b>Screen robot</b> The telephone plays the screening announcement, and then ask the caller to press the pound key (#) before the call rings on your telephone. You can then answer the call.</p> <p><b>Allow unknown</b> (default settings) The telephone allows these calls to get through and ring. The caller’s number, even if it is available, will not be saved to the allow list.</p> <p><b>Unknown to answering system</b> The telephone forwards these calls to the answering system without ringing.</p> <p><b>Block unknown</b> The telephone rejects these calls with block announcement without ringing. The caller’s number, even if it’s available, will not be saved to the block list.</p>
	<ul style="list-style-type: none"> <li>Uncategorized calls               <ul style="list-style-type: none"> <li>With absent caller ID number.</li> <li>Numbers not found in directory.</li> <li>Numbers not found in allow list.</li> <li>Numbers not found in block list.</li> <li>With caller ID names not found in star name list</li> </ul> </li> </ul>	



Note: You can set to screen, allow, or block all unknown calls without numbers, or unknown calls with numbers not saved in your Directory, Allow list or Star name list. You can also send these calls to the answering system. **Allow unknown** is the default profile setting. To change the setting, see **Set profile** on page 77.



# Call block settings

## Set Smart call blocker on/off

The Smart call blocker feature is set to on by default.

1. Press **CALL BLOCK** on the handset when it is not in use, and then press **MENU/SELECT** to select **SCB On/Off**.

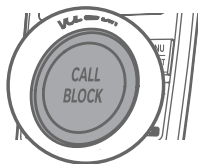

**-OR-**

Press **MENU/SELECT** to enter the main menu when the handset is not in use. Press **▼CID** or **▲DIR** to scroll to **Smart call blk**, then press **MENU/SELECT** twice.

2. Press **▼CID** or **▲DIR** to highlight **On** or **Off**, then press **MENU/SELECT** to save the setting. You hear a confirmation tone.



Note: If you set **SCB On/Off** to **Off**, all settings under **Set profile** (see below) will be invalid.

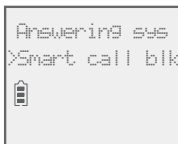

## Set profile

There are five profile setting options, which allows you to quickly set up Smart call blocker.

1. Press **CALL BLOCK** in idle mode.

**-OR-**

Press **MENU/SELECT** to enter the main menu when the handset is not in use. Press **▼CID** or **▲DIR** to scroll to **Smart call blk**, then press **MENU/SELECT**.

2. Press **▼CID** or **▲DIR** to scroll to **Set profile**, then press **MENU/SELECT**.
3. Press **▼CID** or **▲DIR** to select one of the following options, then press **MENU/SELECT**.
  - ▶ **Screen unknown** – screen any calls without numbers or with numbers not saved in the Directory, Allow list, or Star name list.
    - This profile setting sets the telephone to screen all unknown calls and asks the callers to say their names before putting the calls through to you. See **Screen unknown calls** on page 98.





## Call block settings

- ▶ **Screen robot** - screen robocalls.
  - This profile setting sets the telephone to screen all unknown calls and asks the callers to press the pound key (#) before putting the calls through to you. See **Screen robocalls** on page 101.
- ▶ **Allow unknown** (default setting) - allow all unknown calls to ring, except calls with numbers saved in the block list.
  - This profile setting sets the telephone to allow all unknown calls to get through and ring. Calls with numbers saved in the block list will be rejected.
- ▶ **UnknownToAns.S** - forward all unknown calls to the answering system.
  - This profile setting sets the telephone to forward all unknown calls to the answering system.
- ▶ **Block unknown** - block all unknown calls.
  - This profile setting sets the telephone to block all unknown calls.

After selecting a profile setting, make sure you have not turned off Smart call blocker. Refer to the **Set Smart call blocker on/off** section (page 77) to turn it on.



Notes:

- ▶ If you set **SCB On/Off** to **Off**, selected setting under **Set profile** will be invalid, and all incoming calls will ring, including calls with numbers in your block list.
- ▶ There may be robocalls that you do not want to miss. For example, robocalls with announcements or notices from schools or pharmacies. You can set up your star name list with these caller names to allow their calls to get through to you. See **Star name list** on page 89.



# Call block settings

## Block list

---

Add numbers that you want to prevent their calls from ringing through. The block list stores up to 1,000 entries.

### Add a block entry:

1. Press **CALL BLOCK** on the handset when it is not in use.  
**-OR-**  
 Press **MENU/SELECT** to enter the main menu when the handset is not in use. Press ▼**CID** or ▲**DIR** to scroll to **Smart call blk**, then press **MENU/SELECT**.
2. Press ▼**CID** or ▲**DIR** to scroll to **Block list**, and then press **MENU/SELECT**.
3. Press ▼**CID** or ▲**DIR** to scroll to **Add new entry**, then press **MENU/SELECT**.
4. When the screen displays **ENTER NUMBER**, use the dialing keys to enter a number (up to 30 digits).
  - ▶ Press ▼**CID** or ▲**DIR** to move the cursor to the left or right.
  - ▶ Press **MUTE/DELETE** to erase a digit.
  - ▶ Press and hold **MUTE/DELETE** to erase all digits.
  - ▶ Press and hold **REDIAL/PAUSE** to enter a three-second dialing pause (a **p** appears).



### -OR-

Copy a number from the redial list by pressing **REDIAL/PAUSE**. Then, press ▼**CID**, ▲**DIR** or **REDIAL/PAUSE** repeatedly to find the desired number. Press **MENU/SELECT** to copy the number.

5. Press **MENU/SELECT** to move on to the name.
  - ▶ The screen shows **Number already saved** if the number is already in the block list. You cannot save the same number twice.



# Call block settings

- When the screen displays **ENTER NAME**, use the dialing keys to enter a name (up to 15 characters). Press a key repeatedly until the desired character appears. The first character of every word is capitalized.
  - Press **▼CID** or **▲DIR** to move the cursor to the left or right.
  - Press **0** to add a space.
  - Press **MUTE/DELETE** to erase a character.
  - Press and hold **MUTE/DELETE** to erase all characters.
  - Press **-tone X** to change the next letter to upper or lower case.
- Press **MENU/SELECT** to store your block entry.



## Notes:

- Numbers saved in your directory can also be saved to the block list.
- If you save a block entry that has already been saved to the allow list, the entry in the allow list will be removed.

## Review block list:

- Press **CALL BLOCK** on the handset when it is not in use.

**-OR-**

Press **MENU/SELECT** to enter the main menu when the handset is not in use. Press **▼CID** or **▲DIR** to scroll to **Smart call blk**, then press **MENU/SELECT**.

- Press **▼CID** or **▲DIR** to scroll to **Block list**, and then press **MENU/SELECT**.
- Press **MENU/SELECT** to choose **Review**.
- Press **▼CID** or **▲DIR** to browse through the block entries.



Note: **Block list is empty** appears if there are no block entries.



## Call block settings

### Save a caller ID log entry to block list:

1. Search for the desired caller ID log entry (see **Review the caller ID log** on page 66).
2. When the desired entry displays, press **MENU/SELECT**.
3. Press **▼CID** or **▲DIR** to scroll to **Block list**, then press **MENU/SELECT**.
4. The handset displays **EDIT NUMBER**. Use the dialing keys to edit the number, when necessary.
  - Press **▼CID** or **▲DIR** to move the cursor to the left or right.
  - Press **MUTE/DELETE** on the handset to backspace and erase a digit.
  - Press and hold **MUTE/DELETE** to erase the entire entry.
  - Press and hold **REDIAL/PAUSE** to insert a three-second dialing pause (a **p** appears).
5. Press **MENU/SELECT** to move to the name. The screen displays **EDIT NAME**.
6. Use the dialing keys to add or edit the name.
  - Press **▼CID** or **▲DIR** to move the cursor to the left or right.
  - Press **0** to add a space.
  - Press **MUTE/DELETE** to erase a character.
  - Press and hold **MUTE/DELETE** to erase all characters.
  - Press **#** (pound key) to move the last word to the front. For example, **Johnson Charlie** becomes **Charlie Johnson** when you press **#** (pound key).
  - Press **TONEX** to change the next letter to upper or lower case.
7. Press **MENU/SELECT** when done and the screen shows **Saved to block list**.



# Call block settings

## Edit a block entry:

1. Search for the desired entry in the block list (see **Review block list** on page 80).
2. When the desired entry displays, press **MENU/SELECT**. The screen displays **EDIT NUMBER** along with the phone number to be edited. If you only want to edit the name, skip to Step 4.
3. To edit the number:
  - ▶ Use the dialing keys to enter digits.
  - ▶ Press ▼**CID** or ▲**DIR** to move the cursor to the left or right.
  - ▶ Press **MUTE/DELETE** on the handset to erase a digit.
  - ▶ Press and hold **MUTE/DELETE** to erase all digits.
  - ▶ Press and hold **REDIAL/PAUSE** to enter a three-second dialing pause (a **p** appears).
4. Press **MENU/SELECT** to move on to the name. The screen displays **EDIT NAME** along with the name to be edited.
5. To edit the name:
  - ▶ Use the dialing keys to enter characters.
  - ▶ Press ▼**CID** or ▲**DIR** to move the cursor to the left or right.
  - ▶ Press **0** to add a space.
  - ▶ Press **MUTE/DELETE** to erase a character.
  - ▶ Press and hold **MUTE/DELETE** to erase all characters.
6. Press **MENU/SELECT** to save the entry. The screen displays **Saved to block list**.

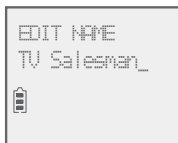



## Call block settings

### Delete a block entry:

1. Search for the desired entry in the block list (see **Review block list** on page 80).
2. When the desired entry displays, press **MUTE/DELETE** on the handset. The screen shows **Delete entry?**.
3. Press **MENU/SELECT** to confirm. The screen show **Entry deleted**, and the next entry displays. You cannot retrieve a deleted entry.

### Delete all block entries:

1. Press **CALL BLOCK** on the handset when it is not in use.  
**-OR-**  
Press **MENU/SELECT** to enter the main menu when the handset is not in use. Press ▼ **CID** or ▲ **DIR** to scroll to **Smart call blk**, then press **MENU/SELECT**.
2. Press ▼ **CID** or ▲ **DIR** to scroll to **Block list**, and then press **MENU/SELECT**.
3. Press ▼ **CID** or ▲ **DIR** to highlight **Delete all**, then press **MENU/SELECT**. The screen shows **Delete all in block list?**.
4. Press **MENU/SELECT** again to confirm. The screen displays **Deleted**. There is a confirmation tone.



# Call block settings

## Allow list

---

Add numbers that you want to allow their calls to get through to you. The allow list stores up to 200 entries.

### Add an allow entry:

1. Press **CALL BLOCK** on the handset when it is not in use.  
**-OR-**  
Press **MENU/SELECT** to enter the main menu when the handset is not in use. Press ▼**CID** or ▲**DIR** to scroll to **Smart call blk**, then press **MENU/SELECT**.
2. Press ▼**CID** or ▲**DIR** to scroll to **Allow list**, and then press **MENU/SELECT**.
3. Press ▼**CID** or ▲**DIR** to scroll to **Add new entry**, then press **MENU/SELECT**.
4. When the screen displays **ENTER NUMBER**, use the dialing keys to enter a number (up to 30 digits).
  - Press ▼**CID** or ▲**DIR** to move the cursor to the left or right.
  - Press **MUTE/DELETE** to erase a digit.
  - Press and hold **MUTE/DELETE** to erase all digits.
  - Press and hold **REDIAL/PAUSE** to enter a three-second dialing pause (a **p** appears).**-OR-**  
Copy a number from the redial list by pressing **REDIAL/PAUSE**. Then, press ▼**CID**, ▲**DIR** or **REDIAL/PAUSE** repeatedly to find the desired number. Press **MENU/SELECT** to copy the number.
5. Press **MENU/SELECT** to move on to the name.
  - The display shows **Number already saved** if the number is already in the allow list. You cannot save the same number twice.



# Call block settings

6. When the screen displays **ENTER NAME**, use the dialing keys to enter a name (up to 15 characters). Press a key repeatedly until the desired character appears. The first character of every word is capitalized.
 
  - ▶ Press **▼CID** or **▲DIR** to move the cursor to the left or right.
  - ▶ Press **0** to add a space.
  - ▶ Press **MUTE/DELETE** to erase a character.
  - ▶ Press and hold **MUTE/DELETE** to erase all characters.
  - ▶ Press **-tone X** to change the next letter to upper or lower case.
7. Press **MENU/SELECT** to store your allow entry.



## Notes:

- ▶ Numbers saved in your directory can also be saved to the allow list.
- ▶ If you save an allow entry that has already been saved to the block list, the entry in the block list will be removed.

## Review allow list:

1. Press **CALL BLOCK** on the handset when it is not in use.  
**-OR-**  
 Press **MENU/SELECT** to enter the main menu when the handset is not in use. Press **▼CID** or **▲DIR** to scroll to **Smart call blk**, then press **MENU/SELECT**.
2. Press **▼CID** or **▲DIR** to scroll to **Allow list**, and then press **MENU/SELECT**.
3. Press **MENU/SELECT** to choose **Review**.
4. Press **▼CID** or **▲DIR** to browse through the allow entries.



Note: **Allow list is empty** appears if there are no allow entries.



## Call block settings

### Save a caller ID log entry to allow list:

1. Search for the desired caller ID log entry (see **Review the caller ID log** on page 66).
2. When the desired entry displays, press **MENU/SELECT**.
3. Press **▼CID** or **▲DIR** to scroll to **Allow list**, then press **MENU/SELECT**.
4. The handset displays **EDIT NUMBER**. Use the dialing keys to edit the number, when necessary.
  - ▶ Press **▼CID** or **▲DIR** to move the cursor to the left or right.
  - ▶ Press **MUTE/DELETE** on the handset to backspace and erase a digit.
  - ▶ Press and hold **MUTE/DELETE** to erase the entire entry.
  - ▶ Press and hold **REDIAL/PAUSE** to insert a three-second dialing pause (a **p** appears).
5. Press **MENU/SELECT** to move to the name. The screen displays **EDIT NAME**.
6. Use the dialing keys to add or edit the name.
  - ▶ Press **▼CID** or **▲DIR** to move the cursor to the left or right.
  - ▶ Press **0** to add a space.
  - ▶ Press **MUTE/DELETE** to erase a character.
  - ▶ Press and hold **MUTE/DELETE** to erase all characters.
  - ▶ Press **#** (pound key) to move the last word to the front. For example, **Johnson Charlie** becomes **Charlie Johnson** when you press **#** (pound key).
  - ▶ Press **TONEX** to change the next letter to upper or lower case.
7. Press **MENU/SELECT** when done and the screen shows **Saved to allow list**.



# Call block settings

## Edit an allow entry:

1. Search for the desired entry in the allow list (see **Review allow list** on page 85).
2. When the desired entry displays, press **MENU/SELECT**. The screen displays **EDIT NUMBER** along with the phone number to be edited. If you only want to edit the name, skip to Step 4.
3. To edit the number:
  - ▶ Use the dialing keys to enter digits.
  - ▶ Press ▼**CID** or ▲**DIR** to move the cursor to the left or right.
  - ▶ Press **MUTE/DELETE** on the handset to erase a digit.
  - ▶ Press and hold **MUTE/DELETE** to erase all digits.
  - ▶ Press and hold **REDIAL/PAUSE** to enter a three-second dialing pause (a **p** appears).
4. Press **MENU/SELECT** to move on to the name. The screen displays **EDIT NAME** along with the name to be edited.
5. To edit the name:
  - ▶ Use the dialing keys to enter characters.
  - ▶ Press ▼**CID** or ▲**DIR** to move the cursor to the left or right.
  - ▶ Press **0** to add a space.
  - ▶ Press **MUTE/DELETE** to erase a character.
  - ▶ Press and hold **MUTE/DELETE** to erase all characters.
6. Press **MENU/SELECT** to save the entry. The screen displays **Saved to allow list**.





## Call block settings

### Delete an allow entry:

1. Search for the desired entry in the allow list (see **Review allow list** on page 85).
2. When the desired entry displays, press **MUTE/DELETE** on the handset. The screen shows **Delete entry?**.
3. Press **MENU/SELECT** to confirm. The screen show **Entry deleted**, and the next entry displays. You cannot retrieve a deleted entry.

### Delete all allow entries:

1. Press **CALL BLOCK** on the handset when it is not in use.  
**-OR-**  
Press **MENU/SELECT** to enter the main menu when the handset is not in use. Press ▼ **CID** or ▲ **DIR** to scroll to **Smart call blk**, then press **MENU/SELECT**.
2. Press ▼ **CID** or ▲ **DIR** to scroll to **Allow list**, and then press **MENU/SELECT**.
3. Press ▼ **CID** or ▲ **DIR** to highlight **Delete all**, then press **MENU/SELECT**. The screen shows **Delete all in allow list?**.
4. Press **MENU/SELECT** again to confirm. The screen displays **Deleted**. There is a confirmation tone.



# Call block settings

## Star name list

There are many organizations like schools, medical offices, and pharmacies that use robocalls to communicate important information to you. Robocall uses an autodialer to deliver pre-recorded messages. By entering the name of the organizations into the star name list, it ensures these calls will ring through when you only know the caller names but not their numbers.

If the first 15 characters of the incoming caller ID's name match a name saved in your star name list, the call will get through and ring. The star name list stores up to 10 names.

### Add a star name entry:

1. Press **CALL BLOCK** on the handset when it is not in use.  
**-OR-**  
 Press **MENU/SELECT** to enter the main menu when the handset is not in use. Press ▼**CID** or ▲**DIR** to scroll to **Smart call blk**, then press **MENU/SELECT**.
2. Press ▼**CID** or ▲**DIR** to scroll to **Star name list**, and then press **MENU/SELECT**.
3. Press ▼**CID** or ▲**DIR** to scroll to **Add new entry**, then press **MENU/SELECT**.
4. When the screen displays **ENTER NAME**, use the dialing keys to enter a name (up to 15 characters). Press a key repeatedly until the desired character appears. The first character of every word is capitalized.
 
  - ▶ Press ▼**CID** or ▲**DIR** to move the cursor to the left or right.
  - ▶ Press **0** to add a space.
  - ▶ Press **MUTE/DELETE** to erase a character.
  - ▶ Press and hold **MUTE/DELETE** to erase all characters.
  - ▶ Press **TONE X** to change the next letter to upper or lower case.
5. Press **MENU/SELECT** to store your star name entry. The display shows **Name already saved** if the name is already in the star name list. You cannot save the same name twice.



# Call block settings

## Review star name list:

1. Press **CALL BLOCK** on the handset when it is not in use.  
**-OR-**  
 Press **MENU/SELECT** to enter the main menu when the handset is not in use. Press **▼CID** or **▲DIR** to scroll to **Smart call blk**, then press **MENU/SELECT**.
2. Press **▼CID** or **▲DIR** to scroll to **Star name list**, and then press **MENU/SELECT**.
3. Press **MENU/SELECT** to choose **Review**.
4. Press **▼CID** or **▲DIR** to browse through the star name entries.



Note: **Star name list is empty** appears if there are no star name entries.

## Save a caller ID log entry to star name list:

1. Search for the desired caller ID log entry (see **Review the caller ID log** on page 66).
2. When the desired entry displays, press **MENU/SELECT**.
3. Press **▼CID** or **▲DIR** to scroll to **Star name list**, then press **MENU/SELECT**.
4. The handset displays **Star this name?**, and the caller ID name of the caller.
5. Press **MENU/SELECT**, and the screen shows **Saved to star name list**.





## Call block settings

### Edit a star name entry:

1. Search for the desired entry in the star name list (see **Review star name list** on page 90).
2. When the desired entry displays, press **MENU/SELECT**. The screen displays **EDIT NAME** along with the name to be edited.
3. To edit the name:
  - ▶ Use the dialing keys to enter characters.
  - ▶ Press ▼**CID** or ▲**DIR** to move the cursor to the left or right.
  - ▶ Press **0** to add a space.
  - ▶ Press **MUTE/DELETE** to erase a character.
  - ▶ Press and hold **MUTE/DELETE** to erase all characters.
4. Press **MENU/SELECT** to save the entry. The screen displays **Saved to star name list**.

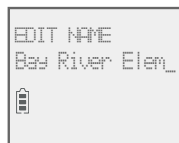
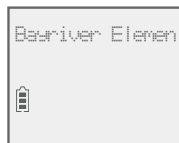

### Delete a star name entry:

1. Search for the desired entry in the star name list (see **Review star name list** on page 90).
2. When the desired entry displays, press **MUTE/DELETE** on the handset. The screen shows **Delete entry?**.
3. Press **MENU/SELECT** to confirm. The screen show **Entry deleted**, and the next entry displays. You cannot retrieve a deleted entry.



## Call block settings

### Delete all star name entries:

1. Press **CALL BLOCK** on the handset when it is not in use.

**-OR-**

Press **MENU/SELECT** to enter the main menu when the handset is not in use. Press ▼ **CID** or ▲ **DIR** to scroll to **Smart call blk**, then press **MENU/SELECT**.

2. Press ▼ **CID** or ▲ **DIR** to scroll to **Star name list**, and then press **MENU/SELECT**.
3. Press ▼ **CID** or ▲ **DIR** to highlight **Delete all**, then press **MENU/SELECT**. The screen shows **Delete all in star name list?**.
4. Press **MENU/SELECT** again to confirm. The screen displays **Deleted**. There is a confirmation tone.



# Call block settings

## Screening announcements

---

If you have set profile to screen all unknown calls (**Screen unknown**) or screen robocalls (**Screen robot**), the callers of the following incoming call categories will hear a screening announcement.

- ▶ Calls that are “out of area” or with numbers set to “Private”.
- ▶ Calls with numbers that are not on your directory, allow list, or block list, or with absent caller ID number.
- ▶ Calls with caller ID names that are not on your star name list.

There are two default screening announcements for screening unknown calls and screening robocalls.

**Screening with caller name** - *“Hello. Calls to this number are being screened by Smart call blocker. Please say your name after the tone, then press pound.”*

- This default announcement is played if you have set profile to screen all unknown calls.

-OR-

**Screening without caller name** - *“Hello. Calls to this number are being screened by Smart call blocker. If you’re a family member, friend or invited caller, please press pound to be connected. If you’re a solicitor, please hang up now.”*

- This default announcement is played if you have set profile to screen robocalls.

You can use these announcements, or record your own name to replace “*this number*” in the announcements. Please refer to **Record your name for all screening announcements** on page 95.



Note: For details of Smart call blocker’s profile setting, see **Set profile** on page 77.



# Call block settings

## Play your current announcement of screening with caller name:

1. Press **CALL BLOCK** on the handset when it is not in use.  
**-OR-**  
Press **MENU/SELECT** to enter the main menu when the handset is not in use. Press ▼**CID** or ▲**DIR** to scroll to **Smart call blk**, then press **MENU/SELECT**.
2. Press ▼**CID** or ▲**DIR** to scroll to **Screening annnc**, then press **MENU/SELECT**.
3. Press ▼**CID** or ▲**DIR** to scroll to **Play annnc**, then press **MENU/SELECT**.
4. Press **MENU/SELECT** again to select **w/ Caller name**.

```
Uncategorized
>Screening annnc
```

```
Rec your name
>Play annnc
```



```
PLAY ANNCC
>w/ Caller name
```



## Play your current announcement of screening without caller name:

1. Press **CALL BLOCK** on the handset when it is not in use.  
**-OR-**  
Press **MENU/SELECT** to enter the main menu when the handset is not in use. Press ▼**CID** or ▲**DIR** to scroll to **Smart call blk**, then press **MENU/SELECT**.
2. Press ▼**CID** or ▲**DIR** to scroll to **Screening annnc**, then press **MENU/SELECT**.
3. Press ▼**CID** or ▲**DIR** to scroll to **Play annnc**, then press **MENU/SELECT**.
4. Press ▼**CID** or ▲**DIR** to scroll to **w/o Caller name**, then press **MENU/SELECT**.

```
Uncategorized
>Screening annnc
```



```
Rec your name
>Play annnc
```



```
PLAY ANNCC
>w/o Caller name
```





## Call block settings

### Record your name for all screening announcements:

1. Press **CALL BLOCK** on the handset when it is not in use.  
-OR-  
Press **MENU/SELECT** to enter the main menu when the handset is not in use. Press ▼**CID** or ▲**DIR** to scroll to **Smart call blk**, then press **MENU/SELECT**.
2. Press ▼**CID** or ▲**DIR** to scroll to **Screening annnc**, then press **MENU/SELECT**.
3. Press **MENU/SELECT** to select **Rec your name**. The system announces, *"Record after the tone. Press 5 when you are done."*
4. Speak towards the handset to record your name. Press 5 to end recording.

To listen to the announcement with your recorded name again, scroll to **Play annnc** and press **MENU/SELECT**.

### Reset all your screening announcements:

1. Press **CALL BLOCK** on the handset when it is not in use.  
-OR-  
Press **MENU/SELECT** to enter the main menu when the handset is not in use. Press ▼**CID** or ▲**DIR** to scroll to **Smart call blk**, then press **MENU/SELECT**.
2. Press ▼**CID** or ▲**DIR** to scroll to **Screening annnc**, then press **MENU/SELECT**.
3. Press ▼**CID** or ▲**DIR** to scroll to **Reset annnc**, then press **MENU/SELECT**. The screen shows **Reset to default annnc?**. Press **MENU/SELECT** again to confirm. The screen shows **Annnc. reset to default** before returning to the previous menu.  
-OR-  
While an announcement is playing, press **MUTE/DELETE**. The screen shows **Annnc. Deleted** before returning to the previous menu.



Your name will be deleted from all the screening announcements, and the telephone will use the default screening announcements described on page 93.



## Allowed calls

If Smart call blocker is on, the following types of incoming calls can get through to you and ring on your telephone system:

- ▶ Calls with numbers saved in your allow list.
- ▶ Calls with numbers saved in your directory, but not on your block list.
- ▶ Calls with caller ID names saved in your star name list.



### Notes:

- ▶ When Smart call blocker is off, all incoming calls will ring on your telephone system, including calls with numbers saved in the block list.
- ▶ **Allow unknown** is the default profile setting. If you have not selected another profile, all unknown calls will ring. However, the caller's numbers, if available, will not be saved to the allow list. If you want to save the caller's number to your allow list or block list, you can retrieve the number from caller ID log and save it to the allow list or block list. See **Save a caller ID log entry to the block list** on page 81 and **Save a caller ID log entry to the allow list** on page 86. If you want to retrieve the name from caller ID log and save it to the star name list. See **Save a caller ID log entry to the star name list** on page 90.



## Blocked calls

If Smart call blocker is on, incoming calls with numbers saved in your block list will not ring. The telephone plays the block announcement *“Calls to this number are being screened by Smart call blocker. The number you are calling is not accepting your call. Please hang up.”* to the caller, and the call will be terminated.

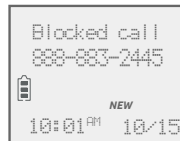

### Notes:

- ▶ When Smart call blocker is off, all incoming calls will ring on your telephone system, including calls with numbers saved in the block list.
- ▶ If you have set profile to **Block unknown**, all unknown calls will be rejected. However, the caller's numbers, if available, will not be saved to the block list. If you want to save the caller's number to the block list, you can retrieve the number from caller ID log and save it to the block list. See **Save a caller ID log entry to the block list** on page 81. You can also retrieve the number and save it to your allow list. See **Save a caller ID log entry to the allow list** on page 86. If you want to retrieve the name from caller ID log and save it to the star name list. See **Save a caller ID log entry to the star name list** on page 90.
- ▶ The telephone can respond to remote access code while it is playing the block announcement. This allows you to access your answering system from an unknown number remotely. See **Remote access** on page 123.



## Screen unknown calls

If Smart call blocker is on, and you have set profile to screen unknown calls, the telephone plays a screening announcement to the caller when receiving the following incoming calls. It asks the caller to respond before putting the call through to you.

- ▶ Incoming calls with numbers that are “out of area” or with numbers set to “Private”;
- ▶ Incoming calls with absent caller ID numbers;
- ▶ Incoming calls with numbers that are not in your directory, allow list, nor block list; or
- ▶ Incoming calls with names that are not in your star name list.

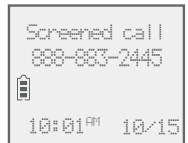
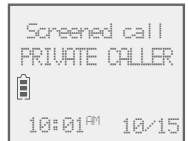

### Screen calls and ask for caller names

When screening a call, the telephone announces to the caller, *“Hello. Calls to this number are being screened by Smart call blocker. Please say your name after the tone, then press pound.”* After the caller completes the request, the telephone announces to the caller *“Please wait a moment while your call is connected.”* The telephone starts ringing and announces the caller’s name. The telephone screen displays **Screened call** and you can pick up the call. The telephone will then ask whether you want to answer or reject the call, or to forward the call to the answering system.



#### Notes:

- ▶ You can set Smart call blocker to screen and filter all unknown calls. You can easily add incoming phone numbers to your allow list and block list. This allows you to build up your lists of allowed and blocked numbers, and Smart call blocker will know how to deal with these calls when they come in again.
- ▶ The telephone announces to the caller with *“Hello. Calls to this number are being screened by Smart call blocker...”* If you have recorded your name in the screening announcements, your recorded name will replace *“this number”* in the announcements. See **Screening announcement** on page 93.
- ▶ If the caller hangs up before the call is screened, or without leaving his/her name while the call is being screened, the call will be logged as missed call in the caller ID log.
- ▶ While a call is being screened, you can press **PHONE/FLASH** or **END CALL/SPEAKER** to stop screening and answer the call.



## Screen unknown calls

- ▶ After the telephone screened a call, and is ringing and announcing the caller's name, you can press **OFF/CANCEL** to mute the ringer, or press **CALL BLOCK** to reject the call directly.
- ▶ After you picked up a screened call and the telephone is announcing the screening options, you can press **OFF/CANCEL** to hang up the call.
- ▶ If Smart call blocker is on and you receive a call waiting call:
  - Smart call blocker will not screen a call waiting call without number while on a call. You can press **PHONE/FLASH** or **SPEAKER** to take the new call.
  - After you have picked up a screened call, the telephone checks whether the call waiting number is in the directory, block list or allow list. It also checks whether the caller name is in the star name list. After that, The telephone then displays the caller ID information or "Blocked call" accordingly. You can press **PHONE/FLASH** or **SPEAKER** to take the new call, or press **CALL BLOCK** on the handset to block it.
  - While the telephone is screening a call, the new call will be ignored and logged as missed call in the caller ID log.
- ▶ Robocalls are unable to respond to the screening announcement, and therefore, will not get through and ring. If you want to allow some robocalls to get through, save their names in the star name list. See page 89.
- ▶ The telephone can respond to remote access code while it is playing the screening announcement. This allows you to access your answering system from an unknown number remotely. See **Remote access** on page 123.

## Screened call options

---

After the telephone screen a call and starts ringing, the screen displays **Screened call**. Press **PHONE/FLASH** or **SPEAKER** to pick up the call.

After you pick up the call, the telephone announces "Call from..." and the caller's name, and then announces, "To answer the call, press 1. To answer and always allow this number, press 2. To block this number, press 3. To send this call to the answering system, press 4. To repeat these options, press \*".

### Allow this call once:

- ▶ Press **1** to answer the call. The telephone number will not be added to your allow list.



## Screen unknown calls

### Always allow this call:

- Press **2** to answer the call. The telephone number will be added to your allow list.

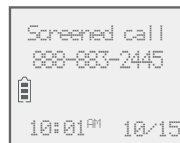

### Block this call:

- Press **3** or **CALL BLOCK** to block the call. The telephone plays the block announcement "*The number you are calling is not accepting your call. Please hang up.*" to the caller. The telephone number will be added to your block list.

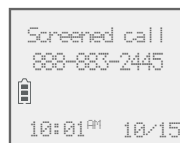

### Send this call to the answering system:

- Press **4** to forward the call to the answering system.

### End this call:

- If you do not want to take the call, press **1 OFF/CANCEL** to end the call.



#### Notes:

- For calls that are "out of area", "Private", or without caller ID, only options **1** and **4** will be available. The telephone announces "*To answer the call, press 1. To send this call to the answering system, press 4. To repeat these options, press \*.*"
- If you select option **4** to send the call to the answering system, the caller can leave a message even if the answering system is off.



## Screen robocalls

If Smart call blocker is on, and you have set profile to screen robocalls, the telephone plays a screening announcement to the caller when receiving the following incoming calls. It asks the caller to press the pound key (#) before putting the call through to you.

- ▶ Incoming calls with numbers that are “out of area” or with numbers set to “Private”;
- ▶ Incoming calls with absent caller ID numbers;
- ▶ Incoming calls with numbers that are not in your directory, allow list, nor block list; or
- ▶ Incoming calls with names that are not in your star name list.

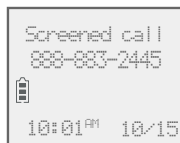
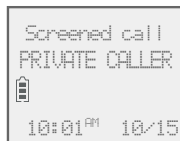

### Screen calls without asking for caller names

When screening a call, the telephone announces to the caller, *“Hello. Calls to this number are being screened by Smart call blocker. If you’re a family member, friend or invited caller, please press pound to be connected. If you’re a solicitor, please hang up now.”* After the caller presses the pound key (#), the telephone announces to the caller *“Please wait a moment while your call is connected.”* The telephone starts ringing, and you can answer the call.

This option is suitable for you to filter calls that uses autodialers to deliver pre-recorded messages, for example, robocalls and telemarketing calls.



#### Notes:

- ▶ The telephone announces to the caller with *“Hello. Calls to this number are being screened by Smart call blocker...”* If you have recorded your name in the screening announcements, your recorded name will replace *“this number”* in the announcements. See **Screening announcement** on page 93.
- ▶ If the caller hangs up before the call is screened, or without leaving his/her name while the call is being screened, the call will be logged as missed call in the caller ID log.
- ▶ While a call is being screened, you can press **PHONE/FLASH** or **END CALL/SPEAKER** to stop screening and answer the call.



## Screen robocalls

- ▶ If Smart call blocker is on and you receive a call waiting call:
  - Smart call blocker will not screen a call waiting call without number while on a call. You can press **\ PHONE/FLASH** or **📞/SPEAKER** to take the new call.
  - After you have picked up a screened call, the telephone checks whether the call waiting number is in the directory, block list or allow list. It also checks whether the caller name is in the star name list. After that, The telephone then displays the caller ID information or “Blocked call” accordingly. You can press **\ PHONE/FLASH** or **📞/SPEAKER** to take the new call, or press **CALL BLOCK** on the handset to block it.
  - While the telephone is screening a call, the new call will be ignored and logged as missed call in the caller ID log.
- ▶ Robocalls are unable to respond to the screening announcement, and therefore, will not get through and ring. If you want to allow some robocalls to get through, save their names in the star name list. See page 89.
- ▶ The telephone can respond to remote access code while it is playing the screening announcement. This allows you to access your answering system from an unknown number remotely. See **Remote access** on page 123.



## Option while on a call

When you are on a call and speaking to the caller, and you do not want to continue the call, you can press the **CALL BLOCK** button on the handset to end the call. The telephone plays the block announcement “*The number you are calling is not accepting your call. Please hang up.*” to the caller, and the call will be terminated. The caller’s number will be added to your block list.

- Press **CALL BLOCK** on the handset. The screen displays **Block and end?** and the caller’s number, if available. Press **MENU/SELECT** to end the call.



### Notes:

- The caller’s number, if available, will be saved to the block list. The screen displays **Added to block list** after pressing **CALL BLOCK** on the handset. If caller’s number is not available, the screen displays **No number to block.**
- You can press **CALL BLOCK** on the handset to end the call even if Smart call blocker is turned off.

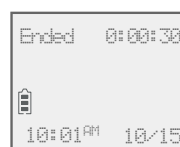
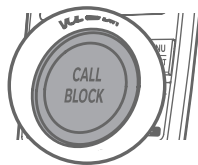



# Answering system settings

Use the answering system menu of a system handset to set up the announcement message, turn on or off the answering system or message alert tone, activate call screening, or change the number of rings, remote access code or message recording time. If you turn off the answering system and you change any setting in the answering system setup menu, the answering system automatically turns on again.



1. When the device is in idle mode, press **MENU/SELECT** to enter the main menu.
2. Press ▼ **CID** or ▲ **DIR** to scroll to **Answering sys**, then press **MENU/SELECT**.

## Announcement

Your outgoing announcement plays when calls are answered by the answering system.

The telephone has a default outgoing announcement, *"Hello. Please leave a message after the tone."* You can use this announcement, or record your own.

You can record an announcement up to 90 seconds. The system does not record any announcement shorter than two seconds.

### To play your current outgoing announcement:

1. When the handset is in idle mode, press **MENU/SELECT** to enter the main menu.
2. Press ▼ **CID** or ▲ **DIR** to scroll to **Answering sys**, then press **MENU/SELECT**.
3. Press **MENU/SELECT** again to select **Announcement**.
4. Press ▼ **CID** or ▲ **DIR** to scroll to **Play annc**, then press **MENU/SELECT**.

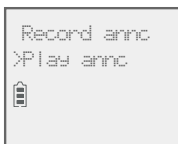



# Answering system settings

## To record a new outgoing announcement:

1. When the handset is in idle mode, press **MENU/SELECT** to enter the main menu.
2. Press **▼CID** or **▲DIR** to scroll to **Answering sys**, then press **MENU/SELECT**.
3. Press **MENU/SELECT** again to select **Announcement**.
4. Press **MENU/SELECT** to select **Record annnc**. The system announces, *"Record after the tone. Press 5 when you are done."*
5. Speak towards the handset to record your announcement. Press **5** to end recording. Your recorded announcement plays.



To listen to the recorded announcement again, scroll to **Play annnc** and press **MENU/SELECT**.

## To reset your outgoing announcement:

1. When the handset is in idle mode, press **MENU/SELECT** to enter the main menu.
2. Press **▼CID** or **▲DIR** to scroll to **Answering sys**, then press **MENU/SELECT**.
3. Press **MENU/SELECT** again to select **Announcement**.
4. Press **▼CID** or **▲DIR** to scroll to **Reset annnc**, then press **MENU/SELECT**. The screen shows **Reset to default annnc?**. Press **MENU/SELECT** again to confirm. The screen shows **Annnc. reset to default** before returning to the previous menu.

**-OR-**

Press **▼CID** or **▲DIR** to scroll to **Play annnc**, then press **MENU/SELECT**. While the announcement is playing, press **MUTE/DELETE** to delete the announcement. The screen shows **Annnc. Deleted** before returning to the previous menu.

When your announcement is deleted, the system answers calls with the default announcement described on page 104. You cannot delete the default announcement.



# Answering system settings

## Answer on/off

By default, the answering system is on and ready to record messages. You can turn the answering system off, but if you do so, the answering system does not answer calls and record incoming messages.

### To turn the answering system on or off:

#### Using a cordless handset:

1. When the handset is in idle mode, press **MENU/SELECT** to enter the main menu.
2. Press **▼CID** or **▲DIR** to scroll to **Answering sys**, then press **MENU/SELECT**.
3. Press **▼CID** or **▲DIR** to scroll to **Answer ON/OFF**, then press **MENU/SELECT**.
4. Press **▼CID** or **▲DIR** to highlight **On** or **Off**, then press **MENU/SELECT** to save the setting. You hear a confirmation tone.

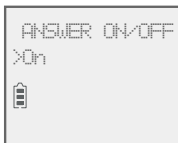

When the answering system is on, the handset shows **ANS ON**.

#### Using the telephone base:

- Press **⓪/ANS ON/OFF** to turn the answering system on or off. If the answering system is turned on, it announces, "Calls will be answered." If the answering system is turned off, it announces, "Calls will not be answered."

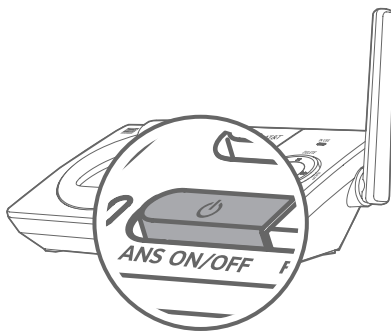

When the answering system is on, the light next to **⓪/ANS ON/OFF** will be on.



Note: If the answering system is off and there is an incoming call, the system answers after ten rings and announces, "Please enter your remote access code." For more information about remote access, see page 123.



# Answering system settings

## Voice guide

This feature is an alternative way for you to do the basic setup of the answering system. You can follow the voice guide to record your own announcement, set the number of rings, and set the message alert tone.

This feature is only available on the cordless handset.

1. Press **MENU/SELECT** on the handset when it is not in use.
2. Press **▼CID** or **▲** to scroll to **Answering sys**, then press **MENU/SELECT**.
3. Press **▼CID** or **▲DIR** to scroll to **Voice guide**, then press **MENU/SELECT**. You hear a voice prompt, *"This voice guide will assist you with the basic setup of your answering system."*
4. Setup your answering system by inputting designated numbers, as instructed in the voice guide.

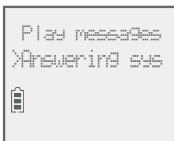

### Notes:

- ▶ You can press **/OFF/CANCEL** to quit the voice guide at any time.
- ▶ If the system does not receive any input, it will announce *"Sorry, I still have not received any input. If you want to restart the voice guide, please enter the menu and select Voice guide under Answering system. Good bye."*
- ▶ After a power outage, the handset prompts you to set the date and time, and Smart call blocker. After these settings are done or skipped, the handset prompts if you want to set up the answering system via **voice guide**. Press **MENU/SELECT** to start the setup.
- ▶ If the answering system is off and there is an incoming call, the system answers after ten rings and announces, *"Please enter your remote access code."* For more information about remote access, see page 123.



# Answering system settings

## Call screening

Use this feature to choose whether incoming messages can be heard over the speaker when they are being recorded. If you turn call screening on, you hear the incoming message. While monitoring an incoming message, you can answer the call by pressing **\ PHONE/FLASH** on the handset.

### To change the setting:

1. When the handset is in idle mode, press **MENU/SELECT** to enter the main menu.
2. Press **▼CID** or **▲DIR** to scroll to **Answering sys**, then press **MENU/SELECT**.
3. Press **▼CID** or **▲DIR** to scroll to **Ans sys setup**, then press **MENU/SELECT**.
4. Press **MENU/SELECT** to select **Call screening**.
5. Press **▼CID** or **▲DIR** to choose **On** or **Off**.
6. Press **MENU/SELECT** to save the setting. You hear a confirmation tone.



Note: For more information on call screening, see page 108.





# Answering system settings

## Number of rings

You can set the answering system to answer an incoming call after two, three, four, five or six rings. You can also select toll saver. If toll saver is selected, the answering system answers a call after two rings when you have new messages, and after four rings when there are no new messages. This feature allows you to check for new messages and avoid paying long distance charges when calling from out of your local area. By default, the answering system answers an incoming call after four rings.

### To set the number of rings:

1. When the handset is in idle mode, press **MENU/SELECT** to enter the main menu.
2. Press ▼ **CID** or ▲ **DIR** to scroll to **Answering sys**, then press **MENU/SELECT**.
3. Press ▼ **CID** or ▲ **DIR** to scroll to **Ans sys setup**, then press **MENU/SELECT**.
4. Press ▼ **CID** or ▲ **DIR** to scroll to **# of rings**, then press **MENU/SELECT**.
5. Press ▼ **CID** or ▲ **DIR** to choose among **2, 3, 4, 5, 6** or **Toll saver**.
6. Press **MENU/SELECT** to save the setting. You hear a confirmation tone.

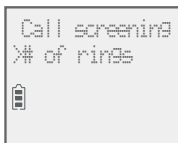

#### Notes:

- ▶ If you subscribe to voicemail service through your telephone service provider, see **Answering system and voicemail indicators** on page 113.
- ▶ If you set the number of rings for the answering system as two or three rings, the caller ID announce feature may not have enough time to announce the caller's full information.
- ▶ If Smart call blocker is on, the first ring of all incoming calls will be muted.



# Answering system settings

## Remote access code

---

To access your answering system remotely from any touch-tone phone, you need to enter a two-digit number (00-99). By default, the remote access code is **19**.

### To change the remote access code:

1. When the handset is in idle mode, press **MENU/SELECT** to enter the main menu.
2. Press ▼**CID** or ▲**DIR** to scroll to **Answering sys**, then press **MENU/SELECT**.
3. Press ▼**CID** or ▲**DIR** to scroll to **Ans sys setup**, then press **MENU/SELECT**.
4. Press ▼**CID** or ▲**DIR** to scroll to **Remote code**, then press **MENU/SELECT**.
5. Use the dialing keys to enter a two-digit number. Press **MUTE/DELETE** to backspace and delete a digit.
6. Press **MENU/SELECT** to save the setting. You hear a confirmation tone.

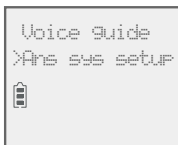



# Answering system settings

## Message alert tone

When the message alert tone is set to **On**, and there is at least one new message, the telephone base beeps every ten seconds. By default, the message alert tone is set to off.

There is no audible alert at the handset.

### To change the setting:

1. When the handset is in idle mode, press **MENU/SELECT** to enter the main menu.
2. Press ▼ **CID** or ▲ **DIR** to scroll to **Answering sys**, then press **MENU/SELECT**.
3. Press ▼ **CID** or ▲ **DIR** to scroll to **Ans sys setup**, then press **MENU/SELECT**.
4. Press ▼ **CID** or ▲ **DIR** to scroll to **Msg alert tone**, then press **MENU/SELECT**.
5. Press ▼ **CID** or ▲ **DIR** to choose **On** or **Off**.
6. Press **MENU/SELECT** to save the setting. You hear a confirmation tone.

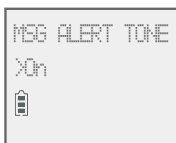

Notes:

- ▶ The message alert tone beeps only if all the following conditions are met:
  - Answering system is on.
  - Message alert tone setting is on.
  - There are new messages.
- ▶ To temporarily turn off the message alert tone, see page 117.



# Answering system settings

## Message recording time

---

You can set the recording time allowed for incoming messages. The message length is three minutes by default.

### To change the setting:

1. When the handset is in idle mode, press **MENU/SELECT** to enter the main menu.
2. Press ▼**CID** or ▲**DIR** to scroll to **Answering sys**, then press **MENU/SELECT**.
3. Press ▼**CID** or ▲**DIR** to scroll to **Ans sys setup**, then press **MENU/SELECT**.
4. Press ▼**CID** or ▲**DIR** to scroll to **Recording time**, then press **MENU/SELECT**.
5. Press ▼**CID** or ▲**DIR** to choose **3 minutes**, **2 minutes** or **1 minute**, then press **MENU/SELECT** to save the setting. You hear a confirmation tone.

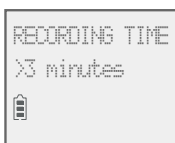



## About the answering system

### Answering system and voicemail indicators

Your telephone has separate indicators for two different types of voice messages: those left on its built-in digital answering system and those left at your telephone service provider's voicemail (fees may apply). Your telephone's built-in digital answering system messages and voicemail messages are separate. Each alerts you to new messages differently.

- ▶ If **OO** and **XX New messages** show on the handset and the message window, there are new messages in the built-in answering system. To listen to messages recorded on your digital answering system, press **►/■/PLAY/STOP** on the telephone base (page 118).
- ▶ If **✉** and **New voicemail** display on the handset, your telephone service provider is indicating that it has new voicemail for you. To listen to your voicemail, dial an access number provided by your telephone service provider, followed by a security code or PIN.

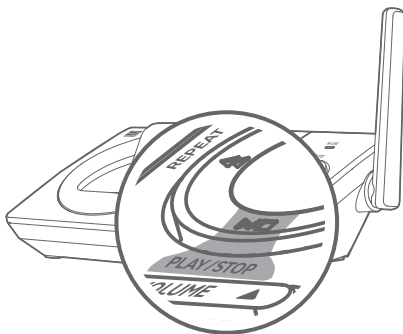

Some telephone service providers bundle or combine multiple services like voicemail and call waiting, so you may not be aware that you have voicemail. To check what services you have and how to access them, contact your telephone service provider.

To use your voicemail service rather than the answering system, turn off the answering system. To use the answering system rather than your voicemail service, contact your telephone service provider to deactivate your voicemail service.



Note: After reviewing all new messages, the number of old messages appears on the message counter.



## About the answering system

### **Using the answering machine and voicemail together**

---

You can also use your telephone answering system and voicemail together by setting your built-in answering system to answer before voicemail answers, as described below. To learn how to program your voicemail settings, contact your telephone service provider. If you are on a call, or the answering system is busy recording a message and you receive another call, the second caller can leave a voicemail message.

Set your answering system to answer calls at least two rings earlier than your voicemail is set to answer. For example, if your voicemail answers after six rings, set your answering system to answer after four rings. Some voicemail providers may program the delay before answering calls in seconds instead of rings. In this case, allow six seconds per ring when determining the appropriate setting.



## About the answering system

### Message capacity

---

The answering system can record up to 99 messages, depending on the length of each message. Individual messages can be up to three minutes, and the maximum recording time is approximately 22 minutes. The actual recording time depends on individual message characteristics. Messages remain available for replay until you delete them.

When there are new messages (including memos) on the answering system, the number of messages stored shows in the message counter.

If the answering system has less than three minutes of recording time left, it announces, *“Less than three minutes to record,”* before message playback at the handset or the telephone base. **Rec mem low** displays on the device screen in idle mode. When you turn on the answering system at the telephone base, it announces, *“Calls will be answered. Less than three minutes to record.”*

If the memory is full, the answering system announces, *“Memory is full,”* before message playback. The device screen displays **Rec mem full** in idle mode. Once the memory is full, you cannot turn the answering system back on if it has been turned off, nor can you record new messages until old ones have been deleted. **Memory full** displays if you want to turn on the answering system on the handset but there is no memory.

### Voice prompts

---

The system provides voice prompts to guide you through the setup procedures on your handsets, message playback, remote access and recording outgoing announcements. The system also provides basic answering system setup via voice guide to record your own announcement, set the number of rings, and set the message alert tone.



## About the answering system

### Call screening

---

#### To screen a call at the telephone base:

If the answering system and call screening are on (see **Call screening** on page 108), the announcement and the incoming message broadcast at the telephone base when a call is answered by the answering system.

Options while a message is being recorded:

- Press **▼VOLUME** or **▲VOLUME** on the telephone base to adjust the call screening volume.
- Press **▶/■/PLAY/STOP** to temporarily silence the call screening.
- Press **▶/■/PLAY/STOP** to temporarily turn on the call screening if call screening is set to off.

#### To screen a call at the handset:

While a message is being recorded, the handset shows

**To screen call, press [SELECT].** Press **MENU/SELECT** to screen the call.

Options while a message is being recorded:

- Press **VOL▼CID** or **VOL▲DIR** on the handset to adjust the call screening volume.
- Press **⏏/OFF/CANCEL** to temporarily silence the call screening.
- Press **MENU/SELECT** to temporarily turn on the call screening if call screening is set to off.
- Press **🔊/SPEAKER** to broadcast the announcement and the incoming message through the speakerphone. Press again to turn off the speakerphone.



## About the answering system

### Call intercept

---

While screening a call, you can stop recording and speak to the caller by pressing **\ PHONE/FLASH**.

### Base ringer

---

Press **▲ VOLUME** or **▼ VOLUME** on the telephone base to adjust the ringer volume when the telephone is not in use.

You hear a sample of the ringer while adjusting the volume. The telephone base announces, “*Base ringer is off*,” when you set the volume to **0**.

### Temporarily turning off the message alert tone

---

If the message alert tone is turned on, the telephone base beeps every ten seconds when there are new messages. Pressing any telephone base key (except **🔍 FIND HS**) temporarily silences the message alert tone.

However, if you press a key at the telephone base to silence the message alert tone, the telephone base will also perform the corresponding key function. For example, if you press **X/DELETE** when in idle mode to temporarily turn off the message alert tone, there is a voice prompt directing you to press **X/DELETE** again to delete all old messages. The message alert tone is temporarily off. Only press **X/DELETE** a second time if you wish to erase all old messages in your answering system.

The message alert tone resumes when you receive another message.



# Message playback

If you have new messages, you hear only the new messages in chronological order. If there are no new messages, the system plays back all old messages (in chronological order). If there are both new and old messages, you have the option of playing the new or old messages on the cordless handset. The message counter flashes indicating the number of new messages saved.

When playback begins, the total number of messages is announced. Before each message, you hear the day and time of the recording. If the date and time are not set, you hear, *"Time and date not set,"* before playback. After the last message, you hear, *"End of messages."* If the recording time is less than three minutes, you hear, *"Less than three minutes to record"* before playback (see **Message capacity** on page 115).

## To listen to messages at the telephone base:

Press ►/■/**PLAY/STOP** on the telephone base to listen to the messages. The system announces the number of messages, then begins playback. Press ►/■/**PLAY/STOP** again to end the message playback.

## To listen to messages on a cordless handset:

1. When the handset is in idle mode, press **MENU/SELECT** to enter the main menu.
2. Press **MENU/SELECT** again to select **Play messages**.
  - ▶ If there are new and old messages, press ▼**CID** or ▲**DIR** to select **Play new msgs** or **Play old msgs**, then press **MENU/SELECT**.
  - ▶ If there are only new or only old messages, they will play automatically.

The system announces the number of messages, then begins playback. The message sequence is shown on the handset. If there are no recorded messages, the handset shows **No messages** and you hear, *"You have no message."*

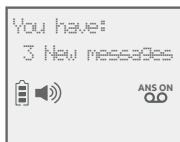



# Message playback

## Options during playback

---

When a message is playing, you can adjust the playback volume, skip, repeat, pause or delete the message.

### When messages are playing on the telephone base:

- ▶ Press **▲VOLUME** or **▼VOLUME** to adjust the message playback volume.
- ▶ Press **▶/SKIP** to skip to the next message.
- ▶ Press **◀/REPEAT** to repeat the message. Press twice to hear the previous message.
- ▶ Press **X/DELETE** to delete the message.
- ▶ Press **▶/■/PLAY/STOP** to stop the playback.

### When messages are playing on the handset:

- ▶ Press **VOL ▼ CID** or **VOL ▲ DIR** to adjust the message playback volume.
- ▶ Press **6** to skip to the next message.
- ▶ Press **4** to repeat the message. Press twice to hear the previous message.
- ▶ Press **MUTE/DELETE** to delete the message.
- ▶ Press **5** or **/ OFF/CANCEL** to stop the playback.
- ▶ Press **📞/SPEAKER** to switch between speakerphone mode and handset mode.
- ▶ Press **\ PHONE/FLASH** to stop playback. The screen shows **Call back?**, then press **MENU/SELECT** or **\ PHONE/FLASH** to call back the caller if the caller's number is available. If the dialing format used is not correct, then use the following option to choose the correct dialing format before calling back the caller.
- ▶ Press **MENU/SELECT** to pause playback and show the caller ID information if available. From here, you can press **/ OFF/CANCEL** to resume playback, or press **#** (pound key) repeatedly to show the desired dialing option (page 67), then press **MENU/SELECT** or **\ PHONE/FLASH** to call back the caller. If you do not call back within ten seconds, message playback resumes automatically.



Note: The current equalizer settings remains unchanged until a new setting is selected.



# Message playback

## Delete all old messages

You can only delete old (reviewed) messages. You cannot delete new messages until you review them. You cannot retrieve deleted messages.

### To delete all old messages on the telephone base:

1. When the telephone is idle, press **X/DELETE**. The system announces, *"To delete all old messages, press DELETE again."*
2. Press **X/DELETE** again. The system announces, *"All old messages deleted."*

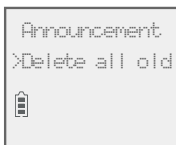

### To delete all old messages on the handset:

1. Press **MENU/SELECT** when in idle mode to enter the main menu.
2. Press **▼CID** or **▲DIR** to scroll to **Answering sys.** Press **MENU/SELECT**.
3. Press **▼CID** or **▲DIR** to highlight **Delete all old**, then press **MENU/SELECT**. The screen shows **Delete all old messages?**
4. Press **MENU/SELECT** again to confirm. The screen displays **Deleting...** and then **All old msgs deleted!**. There is a confirmation tone.





# Recording and playing memos

Memos are your own recorded messages used as reminders for yourself or others using the same answering system. Play and delete them in the same way as incoming messages.

## Record a memo

1. When the handset is in idle mode, press **MENU/SELECT** to enter the main menu.
2. Press ▼ **CID** or ▲ **DIR** to scroll to **Answering sys.** Press **MENU/SELECT**.
3. Press ▼ **CID** or ▲ **DIR** to highlight **Record memo**, then press **MENU/SELECT**. The system announces, *"Record after the tone. Press 5 when you are done."* You can record a memo for up to four minutes.
4. Speak towards the handset to record a memo.
5. Press **5** to stop recording. The system announces, *"Recorded."* The system does not save memos shorter than two seconds.



## Play back a memo

Play memos the same way as messages. See **Message playback** on page 118.



# Base message counter displays

The base message counter shows the total number of answering system messages. See the following table for other message counter displays.

## Message counter displays

0	No messages.
0 (flashing)	You need to set the date and time (page 23).
1-99	Total number of old messages and memos, or message number currently playing during old message playback.
1-99 (flashing)	Total number of messages and memos. The number flashes when there are new or missed messages. After a power failure, the number in the message counter flashes to indicate that you need to set the clock.
1-99 & F (alternating)	Memory is full. You must delete some messages before recording new messages.
....	The system is answering a call, recording a message or memo, or is being reached remotely. The telephone line is in use.
0-6	Shows for two seconds while adjusting the telephone base ringer volume.
1-8	Shows for two seconds while adjusting the telephone base speaker volume.



# Remote access

You can reach your answering system remotely by dialing your home telephone number from any touch-tone telephone.

## To remotely reach your answering system:

1. Dial your telephone number from any touch-tone telephone.
2. When the system answers, enter the two-digit remote access code (**19** is the default code. See page 110 to change it).
  - The system automatically announces the number of new or old messages (if any), and then begins to play them.
3. You can also enter the following remote commands:

Remote commands	Actions
<b>1</b>	Press to listen to all messages.
<b>2</b>	Press to listen to new messages only.
<b>3</b>	Press to delete the current message (during playback).
<b>33</b>	Press twice to delete all old messages.
<b>4</b>	Press to repeat the current message (during playback).
<b>5</b>	Press to stop any operation (including recording).
<b>*5</b>	Press to listen to a list of remote commands.
<b>6</b>	Press to skip to the next message (during playback).
<b>*7</b>	Press to record a new announcement.
<b>8</b>	Press to end remote access (the call will be terminated).
<b>0</b>	Press to turn the answering system on or off.

4. Hang up or press **8** to end the calls.



## Remote access

Cut out and carry the remote access wallet card at the back of this user's manual for quick reference.



Notes:

- ▶ If you do not enter a valid remote access code, the system answers the call automatically.
- ▶ If you pause for more than four seconds during remote access, you hear a help menu listing all features and commands. If there is no command for another 20 seconds, the call ends automatically.
- ▶ If the memory is full, the answering system answers after ten rings and announces, *"Memory is full. Enter the remote access code."* Enter your remote access code to access the messages and announcements.
- ▶ The telephone can respond to remote access code while it is playing the screening announcement or block announcement. This allows you to access your answering system from an unknown number remotely. See **Smart call blocker** on pages 73-103.



# Adding and registering handsets/headsets/speakerphones

Your telephone can support up to 12 DECT 6.0 cordless handsets, headsets or speakerphones. You can purchase additional handsets (AT&T model CL80119, sold separately) or up to ten cordless handsets and two cordless headsets or speakerphones (sold separately). Visit <https://telephones.att.com/accessories> for a list of compatible DECT 6.0 cordless headsets or speakerphones. Each new handset, headset or speakerphone must be registered to the telephone base before use. You must register each handset, headset or speakerphone separately.

To register a cordless headset or speakerphone to this telephone system, please refer to the corresponding user's manual for details. To register a cordless handset, see below.

The handsets provided within your product box are already registered as **HANDSET 1**, and so forth. Additional handsets are assigned numbers in the sequential order they are registered (up to **HANDSET 12**).

## Register a handset to the telephone base

1. Before you begin registration, make sure the handset is out of the telephone base or charger and shows **To register HS, see manual.**
2. Put the handset you wish to register on the telephone base cradle.
3. The handset shows **Registering.... Please wait** and the **IN USE** light on the telephone base turns on. **HANDSET X Registered** appears on the handset screen (**HANDSET** represents the handset name, **X** represents the handset number). The handset beeps and the **IN USE** light turns off. The handset is now registered with the telephone base.

To register HS,  
see manual.



Registering...  
Please wait



HANDSET X  
Registered





## Adding and registering handsets/headsets/speakerphones

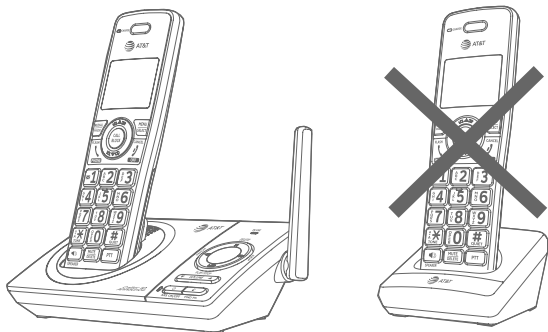

If registration fails, the system will automatically try to register again. If registration fails after the third try, **Registration failed** appears on the screen for a few seconds, and then **To register HS, see manual**. This may take up to five minutes to occur. Please start again from Step 1.



Note: You cannot register a handset if any other system handset is in use.



## Deregistering handsets

You may need to deregister your handsets if:

- ▶ You have 12 registered handsets and need to replace a handset.

**-OR-**

- ▶ You wish to change the designated handset number of your registered handsets.



You must first deregister ALL handsets, and then register each handset you wish to use again, one at a time.

**Please read carefully through all the instructions on this page before beginning the deregistration process.**

### **Deregister all handsets from the telephone base**

---

In addition to the cordless handsets, this operation will also deregister all cordless headsets or speakerphones registered to your telephone base.

1. Make sure that all handsets are out of the telephone base and chargers before you begin deregistration.
2. Press and hold  **FIND HS** on the telephone base for about ten seconds (until the **IN USE** light starts to flash). Release  **FIND HS**.
3. Immediately press  **FIND HS** while the **IN USE** light is still flashing. (If the light stops flashing, start again with Step 1.)
4. It takes up to ten seconds to complete the deregistration process. Before registering the handset again, wait for the cordless handset screen to display **To register HS, see manual**.
5. To register the handset(s) to the telephone base again, follow the registration instructions on pages 125-126.

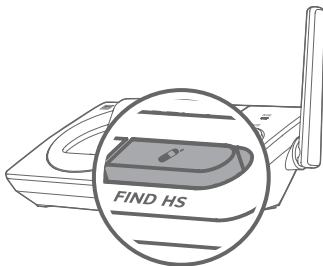



# Deregistering handsets









Notes:

- ▶ If the deregistration process fails, you may need to reset the system and try again. To reset, unplug the power from the telephone base and plug it back in.
- ▶ You cannot deregister the handsets if any other system handset is in use.
- ▶ Even if the battery is depleted, you can still deregister the handsets by following the steps mentioned above. After the handset is charged for at least ten minutes, the screen shows **To register HS, see manual.**



## Alert tones and lights

## Handset screen icons

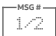
	<b>Battery status</b> - battery is charging (animated display).
	<b>Battery status</b> - low battery (flashing); place the handset in telephone base or charger to recharge.
	<b>Speakerphone</b> - the speakerphone is in use.
	<b>Ringer off</b> - the handset ringer is off.
	<b>New voicemail</b> - you have new voicemail from your telephone service provider.
<b>ANS ON</b>	<b>Answering system on</b> - the answering system is turned on to answer calls.
	<b>Message</b> - new message in the built-in answering system.
<b>NEW</b>	<b>New caller ID log</b> - new and missed calls.
<b>MUTE</b>	<b>MUTE</b> - the handset microphone is off.
	<b>Message counter</b> - number of message playing/total number of messages.





## Alert tones and lights

**Handset alert tones**

<b>One short beep</b>	Tone of each key press, if key tone is turned on.
<b>One long beep</b>	Indication to begin recording a message, memo or announcement.
<b>Two short beeps</b>	You are pressing ▼ <b>CID</b> or ▲ <b>DIR</b> on a cordless handset when the volume is already at its highest or lowest setting. <b>-OR-</b> Call waiting tone. <b>-OR-</b> Error tone.
<b>Confirmation tone (three rising tones)</b>	The system has completed the command successfully.
<b>Four beeps</b>	The other party has ended your intercom call. <b>-OR-</b> The handset has gone out of range from the base during a call.
<b>Four short beeps</b>	Low battery warning.

**Telephone base alert tones**

<b>One long beep</b>	Indicates the start of message recording during call screening or the end of a message playback session.
<b>Four short beeps</b>	Registration failure tone.
<b>Beeps every ten seconds</b>	Message alert.
<b>Fast ringer tone</b>	You are setting the ringer volume by pressing the ▲ <b>VOLUME</b> or ▼ <b>VOLUME</b> key on the telephone base.



## Alert tones and lights

## Lights

## IN USE

- ▶ On when the handset is in use, or when the answering system is answering an incoming call.
- ▶ On when a handset is being registered.
- ▶ Flashes quickly when there is an incoming call or when handsets are being deregistered.
- ▶ Flashes when another telephone is in use on the same line.

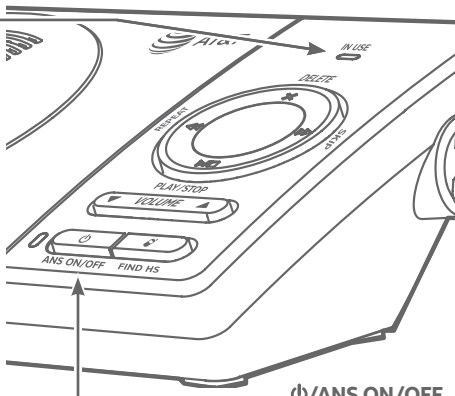

**⏻/ANS ON/OFF**

On when the answering system is on.

**CHARGE** light

On when the handset is charging in the telephone base or charger.

Extra large display

Big lighted buttons

**🔊/SPEAKER**

On when the speakerphone is on.

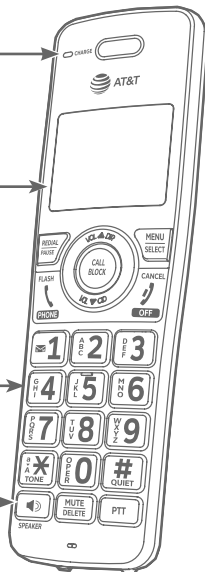



## Screen display messages

## Screen messages

Added to allow list	An entry has been added to the allow list.
Added to block list	An entry has been added to the block list.
Added to star name list	An entry has been added to the star name list.
Allow unknown calls to ring	You have selected the <b>Allow unknown</b> profile option in Smart call blocker.
Block all unknown calls	You have selected the <b>Block unknown</b> profile option in Smart call blocker.
Block list is empty	There are no block list entries.
Blocked call	An incoming call is blocked.
Call transferred	You have transferred an outside call to another device.
Caller ID log empty	There are no entries in the caller ID log.
Calling HANDSET X (for systems with 3 or more handsets)	The handset is calling another handset (for intercom calls). The handset is transferring an outside call to another handset.
Calling other handset (for systems with 2 handsets)	The handset is calling the other handset (for intercom calls).
CID Ann ON/OFF on all HS and BS	The caller ID announce features has been turned on or off on all handsets and on the telephone base.
Contact deleted	A directory entry is deleted.
Directory empty	There are no directory entries.
Directory full	The directory is full. You cannot save any new entries unless you delete some current entries.
Ended	You have just ended a call.
Forward unknown calls to AnsSys	You have selected the <b>UnknownToAns.S</b> profile option in Smart call blocker.



## Screen display messages

## Screen messages

HANDSET X is calling (for systems with 3 or more handsets)	Another system handset is calling.
Incoming call	There is a call coming in
Intercom	The device is on an intercom call.
Intercom ended	The intercom call has just ended.
INTERCOM TO: (for systems with 3 or more handsets)	You have started the intercom process, and need to enter the number of the device you wish to call.
Line in use	An extension phone, or one of the devices is in use.
Low battery	The battery is low. You should charge the battery.
Microphone ON	Mute is off so the other party can hear your voice.
Muted	The microphone is off. The other party cannot hear you.
New voicemail	There are new voicemail messages from your telephone service provider.
No answer. Try again	The device(s) you are trying to transfer a call to is out of range, off hook, or has no power.
No battery	The handset in the charger has no battery installed.
No caller info	The caller information is unavailable.
No Incoming PTT	The incoming PTT function is turned off. The handset will not receive PTT calls.
No line	There is no telephone line connection.
Not available at this time	Someone else is already using the directory or caller ID log.
Number already saved	The telephone number you have entered is already in the directory or call block list.
Out of range OR No PWR at base	The telephone base has lost power, or the handset is out of range.



## Screen display messages

## Screen messages

** Paging **	The cordless handset is paged by the telephone base.
Phone	The handset is on a call.
Place in charger	The battery is very low. The handset should be charged.
Quiet mode on	QUIET mode is on.
Quiet mode is off	QUIET mode is turned off.
Rec mem full	The system recording time is full.
Rec mem low	The system recording time is low.
Registering... Please wait	The handset is registering to the telephone base.
Registration failed	The handset registration is not successful.
Ringer off	The ringer is turned off.
Ringer muted	The ringer is off temporarily while the device is ringing.
Saved to directory	An entry has been successfully saved to the directory.
Screen all Robocalls	You have selected the <b>Screen robot</b> profile option in Smart call blocker.
Screen all unknown calls	You have selected the <b>Screen Unknown</b> profile option in Smart call blocker.
Screened call	The Smart call blocker feature of the telephone has screened a call and is putting the call through to you.
Setting up Ans sys...	The handset is playing voice guide to set up the answering system.
Smart call blk screening	The telephone is screening an incoming call.
Speaker	The handset speakerphone is in use.



## Screen display messages

## Screen messages

Voice Guide set Smart call blk?	After you install your telephone or power returns following a power outage, the handset will prompt you to set the date and time. After the date and time setting is done or skipped, the handset will then prompt if you want to set up the Smart call blocker feature via voice guide.
TRANSFER TO: (for systems with 3 or more handsets)	You have started transferring a call, and need to enter the desired device number or choose all devices.
Transferring call...	The handset is transferring an outside call to the other handset.
To register HS, see manual.	Screen display before handset registration.
To screen call, press [SELECT]	Press <b>MENU/SELECT</b> to activate call screening.
Unable to call. Try again	<p>You try to join a call when there are already four handsets on that call.</p> <p>You try to make an outside call when another device is transferring a call with the intercom feature.</p>
XX Missed calls	There are new calls in the caller ID log.
XX New messages	There are new messages in the answering system.



## Troubleshooting

If you have difficulty with your phone, please try the following suggestions. For Customer Service, visit our website at **<https://telephones.att.com>** or call **1 (800) 222-3111**. In Canada, dial **1 (866) 288-4268**.

### **My telephone doesn't work at all.**

- ▶ Make sure the power cord is securely plugged in.
- ▶ Make sure you plug the battery connector securely into the cordless handset.
- ▶ Make sure you plug the telephone line cord securely and firmly into the telephone base and the telephone wall jack.
- ▶ Charge the battery in the cordless handset for at least ten hours. For optimum daily performance, return the cordless handset to the telephone base or charger when not in use.
- ▶ If the battery is depleted, it may take approximately 30 minutes to charge the handset before it shows **Low battery**. See page 13 for details.
- ▶ Reset the telephone base. Unplug the electrical power. Wait for approximately 15 seconds, then plug it back in. Allow up to one minute for the cordless handset and telephone base to reset.
- ▶ You may need to purchase a new battery. Please refer to **Battery installation and charging** in this user's manual on pages 13-15.

### **The display shows No line. I cannot get a dial tone.**

- ▶ Try all the suggestions, as mentioned above.
- ▶ If the previous suggestions do not work, disconnect the telephone line cord from your telephone and connect the telephone line cord to another telephone.
  - ▶ If there is no dial tone on that other telephone either, your telephone line cord may be defective. Install a new telephone line cord.
  - ▶ If changing the telephone line cord does not help, the wall jack (or the wiring to this wall jack) may be defective. Try using a different wall jack in your home to connect your **CL82219/CL82229/CL82319/CL82419/CL82519** telephone, or contact your telephone service provider (charges may apply).



# Troubleshooting

## **I cannot dial out.**

- ▶ Try all the suggestions, as mentioned above.
- ▶ Make sure you have a dial tone before dialing. The cordless handset may take a second or two to find the telephone base and produce a dial tone. This is normal. Wait an extra second before dialing.
- ▶ Eliminate any background noise. Noise from a television, radio or other appliances may cause the phone to not dial out properly. If you cannot eliminate the background noise, first try muting the cordless handset before dialing, or dialing from another room with less background noise.
- ▶ If other phones in your home are having the same problem, contact your telephone service provider (charges may apply).

## **My cordless handset isn't performing normally.**

- ▶ Make sure you plug the power cord securely into the telephone base. Plug the power adapter into a different working electrical outlet without a wall switch.
- ▶ Move the cordless handset closer to the telephone base. You may have moved out of range.
- ▶ Reset the telephone base. Unplug the electrical power. Wait for 15 seconds, then plug it back in. Allow up to one minute for the cordless handset and telephone base to reset.
- ▶ Other electronic products such as HAM radios and other DECT phones, can cause interference with your cordless phone. Try installing your phone as far away as possible from these types of electronic devices.

## **Out of range OR No pwr at base appears on my cordless handset.**

- ▶ Ensure you plug the telephone base in properly and the power is on.
- ▶ Place the cordless handset in the telephone base for one minute to allow the cordless handset and base to synchronize.
- ▶ Move the cordless handset closer to the telephone base. You may have moved out of range.



## Troubleshooting

- ▶ Reset the telephone base. Unplug the electrical power. Wait for 15 seconds, then plug it back in. Allow up to one minute for the cordless handset and telephone base to reset.
- ▶ Other electronic products such as HAM radios and other DECT phones, can cause interference with your cordless phone. Try installing your phone as far away as possible from these types of electronic devices.

### **The batteries do not hold a charge.**

- ▶ If the cordless handset is in the telephone base or charger and the charge light is not on, refer to **The charge light is off** (page 141).
- ▶ Charge the battery in the cordless handset for at least ten hours. For optimum daily performance, return the cordless handset to the telephone base or charger when not in use.
- ▶ If the battery is depleted, it may take approximately 30 minutes to charge the handset before it shows **Low battery**. Refer to the table on page 13 for details.
- ▶ You may need to purchase a new battery. Please refer to **Battery installation and charging** in this user's manual on pages 13-15.



## Troubleshooting

### **I get noise, static, or weak signals even when I'm near the telephone base.**

- ▶ If you subscribe to high-speed Internet service (DSL - digital subscriber line) through your telephone line, you must install a DSL filter between the telephone line cord and the telephone wall jack (page 11). The filter prevents noise and caller ID problems as a result of DSL interference. Please contact your DSL service provider for more information about DSL filters.
- ▶ You may be able to improve the performance of your cordless phone by installing your new telephone base as far as possible from any other existing cordless telephone system that may already be installed.
- ▶ Other electronic products such as HAM radios and other DECT phones, can cause interference with your cordless phone. Try installing your phone as far away as possible from these types of electronic devices.
- ▶ Do not install this phone near a microwave oven or on the same electrical outlet. You may experience decreased performance while the microwave oven is operating.
- ▶ If you plug your phone in with a modem or a surge protector, plug the phone (or modem/surge protector) into a different location. If this does not solve the problem, relocate your phone or modem farther apart from one another, or use a different surge protector.
- ▶ Move your phone to a higher location. The phone may have better reception in a high area.
- ▶ If other phones in your home are having the same problem, contact your telephone service provider (charges may apply).



## Troubleshooting

### **I experience poor sound quality when using the handset speakerphone.**

- ▶ For increased sound quality while using the handset speakerphone, place the handset on a flat surface with the dial pad facing up.

### **I hear other calls while using my phone.**

- ▶ Disconnect the telephone base from the telephone jack, and plug in a different telephone. If you still hear other calls, call your telephone service provider.

### **My cordless handset does not ring when I receive a call.**

- ▶ Make sure that the ringer is not off. Refer to **Ringer volume** on page 21 in this user's manual.
- ▶ Make sure you plug in the telephone line cord securely into the telephone base and the telephone jack. Make sure you plug in the power cord securely.
- ▶ The cordless handset may be too far from the telephone base.
- ▶ Charge the battery in the cordless handset for at least ten hours. For optimum daily performance, return the cordless handset to the telephone base or charger when not in use.
- ▶ You may have too many extension phones on your telephone line to allow all of them to ring simultaneously. Try unplugging some of the other phones.
- ▶ The layout of your home or office may be limiting the operating range. Try moving the telephone base to another location, preferably to a higher location.
- ▶ If other phones in your home are having the same problem, contact your telephone service provider (charges may apply).
- ▶ Test a working phone at the phone jack. If another phone has the same problem, contact your telephone service provider (charges may apply).
- ▶ Other electronic products can cause interference with your cordless phone. Try installing your phone as far away as possible from electronic devices such as television sets, VCRs, or other cordless telephones.



## Troubleshooting

- Remove the battery. Install the battery again and place the cordless handset into the telephone base. Wait for the cordless handset to reestablish its connection with the telephone base. Allow up to one minute for this to take place.
- Your line cord may be defective. Try installing a new line cord.

### **My calls cut in and out while I'm using my cordless handset.**

- Other electronic products such as HAM radios and other DECT phones, can cause interference with your cordless phone. Try installing your phone as far away as possible from these types of electronic devices.
- Do not install this phone near a microwave oven or on the same electrical outlet. You may experience decreased performance while the microwave oven is operating.
- If you plug your phone in with a modem or surge protector, plug the phone (or modem/surge protector) into a different location. If this does not solve the problem, relocate your phone or modem farther apart from one another, or use a different surge protector.
- Move your telephone base to a higher location. The phone may have better reception when installed in a high area.
- If other phones in your home are having the same problem, contact your telephone service provider (charges may apply).

### **The charge light is off.**

- Make sure you plug the power and line cords in correctly and securely.
- Unplug the electrical power. Wait for 15 seconds, then plug it back in. Allow up to one minute for the cordless handset and telephone base to reset.
- Clean the cordless handset, charger and telephone base charging contacts each month with a pencil eraser or cloth.
- The battery may not be connected to the handset or is missing completely. Ensure that the battery is installed properly.



# Troubleshooting

## My caller ID isn't working.

- ▶ Caller ID is a subscription service. You must subscribe to this service from your telephone service provider for this feature to work on your phone.
- ▶ The caller may not be calling from an area that supports caller ID.
- ▶ Both your and your caller's telephone service providers must use caller ID compatible equipment.
- ▶ If you subscribe to high-speed Internet service (DSL - digital subscriber line) through your telephone line, you must install a DSL filter between the telephone line cord and the telephone wall jack (page 11). The filter prevents noise and caller ID problems resulting from DSL interference. Please contact your DSL service provider for more information about DSL filters.

## System does not receive caller ID when on a call.

- ▶ Make sure you subscribe to caller ID with call waiting features from your telephone service provider. Caller ID features works only if both you and the caller are in areas offering caller ID service, and if both telephone service providers use compatible equipment.

## System screens all my incoming calls.

- ▶ You may have selected the **Screen unknown** or **Screen robot** profile setting for Smart call blocker (see page 73). The telephone asks callers to announce their names or press the pound key (#). We recommend that you add the phone numbers of your family members and friends, and desired businesses to your **Directory** (see page 52) or **Allow list** (see page 84), or add their names to the **Star name list** (see page 89). This will avoid Smart call blocker to screen their calls.
- ▶ To turn Smart call blocker off, see **Set Smart call blocker on/off** on page 77.



## Troubleshooting

### **While screening a call, the telephone suddenly stops screening and connects to the call.**

- ▶ Another handset may have picked up the screening call.
- ▶ If you have other telephone system sharing the same telephone line, and someone picks up the call on the other telephone system while the screening is in progress, the screening process will be terminated and connect you to the caller.

### **My telephone blocks calls from someone I know.**

- ▶ You may have saved the caller's number in your block list. To remove the number from the block list, see **Delete a block entry** on page 83.

### **Blocking all unknown calls.**

- ▶ If you want to block all unknown calls without numbers and calls with numbers or names that are not in your directory, allow list or star name list, select the **Block unknown** profile setting. See **Set profile** on page 77.

### **Forwarding all unknown calls to the answering system.**

- ▶ If you want to forward all unknown calls without numbers and calls with numbers or names that are not in your directory, allow list or star name list to the answering system, select the **UnknownToAns.S** profile setting. See **Set profile** on page 77.

### **Incomplete messages.**

- ▶ If a caller leaves a very long message, part of it may be lost when the system disconnects the call after the maximum recording time you have set.
- ▶ If the caller pauses for longer than seven seconds, the system stops recording and disconnects the call.
- ▶ If the system's memory becomes full during a message, the system stops recording and disconnects the call.
- ▶ If the caller's voice is very soft, the system may stop recording and disconnect the call.



# Troubleshooting

## Difficulty hearing messages.

- ▶ Press **▲ VOLUME** to increase the telephone base speaker volume.
- ▶ Press **VOL ▲ DIR** to adjust the message playback volume on a handset.

## System does not answer after the correct number of rings.

- ▶ Make sure that the answering system is on. **ANS ON** should show on the handset and the **📞/ANS ON/OFF** light on the telephone base should be on.
- ▶ If toll saver is activated, the number of rings changes to two when you have new messages stored (page 109).
- ▶ If the memory is full or the system is off, the system will answer after ten rings.
- ▶ In some cases, the answering system is affected by the ringing system used by your telephone service provider.
- ▶ If you subscribe to voicemail service, change the number of rings so that your answering system answers before your voicemail (page 109). To determine how many rings activate your voicemail, contact your telephone service provider.
- ▶ If there is a fax machine connected to the same telephone line, try disconnecting the fax machine. If that solves the problem, consult your fax machine documentation for information on compatibility with answering systems.

## System does not respond to remote commands.

- ▶ Make sure to enter your remote access code correctly (page 110).
- ▶ Make sure you are calling from a touch-tone phone. When you dial a number, you should hear tones. If you hear clicks, the phone is not a touch-tone telephone and cannot activate the answering system.
- ▶ The answering system may not detect the remote access code while your announcement or message is playing. Try waiting until the announcement or message is over, or press command code **5** to stop the operation before entering other codes.



## Troubleshooting

- ▶ There may be interference on the phone line you are using. Press dialing keys firmly.

### **System does not record messages.**

- ▶ Make sure the answering system is on. **ANS ON** should show on the handset and the **ANS ON/OFF** light on the telephone base should be on.
- ▶ Make sure the memory of the answering system is not full.
- ▶ If you subscribe to voicemail service, change the number of rings so that your answering system answers before your voicemail (page 109). To determine how many rings activate your voicemail, contact your telephone service provider.
- ▶ If there is a fax machine connected to the same telephone line, try disconnecting the fax machine. If that solves the problem, consult your fax machine documentation for information on compatibility with answering systems.

### **System announces, “Time and day not set.”**

- ▶ You need to reset the system clock (page 23).

### **Outgoing announcement is not clear.**

- ▶ When you record your announcement, make sure you speak in a normal tone of voice, about nine inches from the handset.
- ▶ Make sure there is no background noise (TV, music, etc.) while recording.

### **New voicemail and show on the screens, and I don’t know why.**

- ▶ Your telephone has both a built-in answering system and voicemail indication. If **New voicemail** and  appear on the screens, then your telephone has received a signal from your telephone service provider that you have a voicemail message waiting for you to retrieve from them. Contact your telephone service provider for more information on how to access your voicemail.



# Troubleshooting

## **I cannot retrieve voicemail messages.**

- ▶ Your telephone has both a built-in answering system and voicemail indication. They are independent features and each alerts you to new messages differently (page 113). If you subscribe to voicemail service from your telephone service provider, contact your telephone service provider for more information on how to access your voicemail.

## **I've set my LCD language to Spanish or French and I don't know how to change it back to English.**

- ▶ Press **MENU/SELECT** on your handset in idle mode, then enter **364#**. You hear a confirmation tone.

## **I subscribe to a nontraditional telephone service that uses my computer to establish connections, and my telephone doesn't work.**

- ▶ Make sure your computer is powered on.
- ▶ Make sure your Internet connection is working properly.
- ▶ Make sure that the software is installed and running for your nontraditional telephone service.
- ▶ Make sure to plug your USB telephone adapter into a dedicated USB port on your computer. Do not plug it into a multiple port USB hub (USB splitter) that is not powered.
- ▶ In a few rare instances, the USB port on your computer may not have enough power. Try using a USB hub with its own external power supply.
- ▶ If you are using a firewall, it may prevent access to your nontraditional telephone service provider. Contact your service provider for more information.



# Troubleshooting

## **Common cure for electronic equipment.**

If the telephone does not seem to be responding normally, try putting the cordless handset in the telephone base or charger. If it does not fix the problem, do the following (in the order listed):

1. Disconnect the power to the telephone base.
2. Disconnect the cordless handset battery.
3. Wait a few minutes.
4. Connect power to the telephone base.
5. Remove the battery. Replace the battery and place the cordless handset into the telephone base or charger.
6. Wait for the cordless handset to reestablish its connection with the telephone base. Allow up to one minute for this to take place.



# Maintenance

## Taking care of your telephone

- ▶ Your cordless telephone contains sophisticated electronic parts, so you must treat it with care.
- ▶ Avoid rough treatment.
- ▶ Place the handset down gently.
- ▶ Save the original packing materials to protect your telephone if you ever need to ship it.

## Avoid water

- ▶ You can damage your telephone if it gets wet. Do not use the handset in the rain, or handle it with wet hands. Do not install the telephone base near a sink, bathtub or shower.

## Electrical storms

- ▶ Electrical storms can sometimes cause power surges harmful to electronic equipment. For your own safety, take caution when using electric appliances during storms.

## Cleaning your telephone

- ▶ Your telephone has a durable plastic casing that should retain its luster for many years. Clean it only with a soft cloth slightly dampened with water or mild soap.
- ▶ Do not use excess water or cleaning solvents of any kind.

Remember that electrical appliances can cause serious injury if used when you are wet or standing in water. If the telephone base should fall into water, DO NOT RETRIEVE IT UNTIL YOU UNPLUG THE POWER CORD AND TELEPHONE LINE CORDS FROM THE WALL. Pull the unit out by the unplugged cords.



## For C-UL compliance

In compliance with the bilingual requirements for safety, caution, and warning markings of Canadian Federal and Provincial/Territorial statutes and regulations, the French version of Important safety information is included.

### Mesures de sécurité importantes

---



Ce symbole vous alertera d'informations importantes ou d'instructions d'entretien pouvant apparaître dans ce guide d'utilisation. Respectez toujours les mesures de sécurité et de sécurité de base lorsque vous utilisez ce produit, afin de réduire les risques de blessures, d'incendie, ou d'électrocution.

### Information relative à la sécurité

---

- ▶ Veuillez lire et comprendre toutes les instructions de ce guide d'utilisation. Relectez toutes les inscriptions apparaissant sur le produit.
- ▶ Évitez d'utiliser le téléphone pendant un orage. Il pourrait y avoir un faible risque d'électrocution.
- ▶ N'utilisez pas un téléphone près d'une fuite de gaz. Dans certaines circonstances, une flammèche pourrait se produire lorsque l'adaptateur est branché à une prise de courant, ou lorsque le combiné est déposé sur son chargeur. Ceci est un événement fréquent associé avec la fermeture d'un circuit électrique. L'utilisateur ne devrait pas brancher un téléphone dans une prise de courant, et ne devrait pas déposer un combiné chargé dans le chargeur, si le téléphone se trouve dans un environnement comportant une concentration de gaz inflammables ou ignifuges, à moins de se trouver dans un endroit où la ventilation est adéquate. Une flammèche dans de tels environnements pourrait provoquer une explosion. De tels environnements peuvent comprendre : les endroits où de l'oxygène à des fins médicales est utilisé sans ventilation adéquate; des endroits où se trouvent des gaz industriels (dissolvants de nettoyage, des vapeurs de gazoline, etc.), une fuite de gaz naturel, etc.
- ▶ N'utilisez pas ce produit près de l'eau ou lorsque vous êtes mouillés. Par exemple, ne l'utilisez pas dans des sous-sols humides ou sous la douche, ou près d'une piscine, d'un bain, d'un évier de cuisine, ou d'une cuve de lavage. N'utilisez pas de liquides, ou de vaporisateurs aérosol de nettoyage. Si le produit entre en contact avec du liquide, débranchez immédiatement le fil téléphonique ou le cordon d'alimentation. Ne rebranchez pas le produit avant qu'il soit complètement sec.
- ▶ Installez cet appareil dans un endroit protégé où personne ne peut trébucher sur les cordons d'alimentation ou la ligne téléphonique. Protégez les câbles contre les dommages ou l'abrasion.
- ▶ Si le produit ne fonctionne pas correctement, consultez la section **Dépannage (Troubleshooting)** du guide d'utilisation. Si vous ne pouvez pas régler le problème, ou si le produit est endommagé, consultez la section **Garantie limitée (Limited warranty)** des pages 157-159. N'ouvrez pas ce produit, sauf tel qu'indiqué dans le guide d'utilisation. L'ouverture du produit ou le remontage inadéquat pourrait vous exposer à des tensions dangereuses ou autres dangers.



## Appendix

- Remplacez les piles uniquement tel que décrit dans votre guide d'utilisation (pages 13-15). N'incinérerez pas et ne percez pas les piles — elles contiennent des produits chimiques caustiques.
- L'adaptateur de courant est conçu pour être orienté verticalement ou installé sur le plancher. Les broches ne sont pas conçues pour se maintenir en place si la fiche est branchée dans une prise de courant au plafond, sous la table ou sous une armoire.
- Pour les produits à brancher à une prise de courant, la prise de courant doit être installée près du produit, afin d'assurer une accessibilité sécuritaire à la prise de courant.



### MISES EN GARDE:

- N'utilisez seulement l'adaptateur inclus avec ce produit. Pour obtenir une pièce de rechange, visitez notre site Web au

**<https://telephones.att.com>** ou composez le  
**1-800-222-3111**. Au Canada, composez le **1-866-288-4268**.



**ATTENTION:** Afin de prévenir les risques d'incendie ou d'explosion de la pile, remplacez la pile avec une pile du même type. Jetez les piles épuisées en respectant les instructions.

- Débrancher les lignes téléphoniques avant le remplacement des piles.

Évitez d'utiliser la batterie dans les conditions suivantes:

- des températures extrêmes faibles ou élevées auxquelles une batterie peut être soumise pendant l'utilisation, le stockage ou le transport.
- remplacement d'une batterie par un type incorrect pouvant supprimer une protection.
- mise au rebut d'une batterie dans un feu ou dans un four chaud, ou écrasement mécanique ou coupure d'une batterie, susceptible de provoquer une explosion.
- maintien d'une batterie dans un environnement à très haute température pouvant provoquer une explosion ou la fuite de liquide ou de gaz inflammables.
- batterie soumise à une pression de l'air extrêmement faible pouvant provoquer une explosion ou la fuite de liquide ou de gaz inflammables.
- N'utilisez que la pile de rechargeable incluse ou une pile de rechange (modèle BT183342/BT283342). Pour commander, visitez notre site Web  
**<https://telephones.att.com>** ou composez le  
**1-800-222-3111**. Au Canada, composez le **1-866-288-4268**.
- La plaque signalétique appliquée est située au bas ou à proximité du produit.



## Spécifiquement en rapport avec les téléphones sans fil

---

- ▶ Confidentialité : Les mêmes caractéristiques qui rendent les téléphones sans fil si pratiques créent également des restrictions. Les appels téléphoniques sont transmis entre le socle du téléphone et le combiné par le biais d'ondes radio, et il se peut que vos conversations téléphoniques soient interceptées par d'autres équipements de réception d'ondes radio au sein de la portée du téléphone sans fil. Pour cette raison, vous ne devez pas considérer les conversations sur un téléphone sans fil comme étant aussi confidentielles que celles d'un téléphone à cordon.
- ▶ Alimentation électrique : La base de ce téléphone sans fil doit être branchée à une prise de courant électrique fonctionnelle. La prise électrique ne doit pas être contrôlée par un interrupteur mural. Les appels ne peuvent pas être effectués à partir du combiné si la base n'est pas branchée, si elle est hors fonction ou si le courant électrique est coupé.
- ▶ Interférences potentielles aux téléviseurs : Certains téléphones sans fil fonctionnent sur des fréquences pouvant causer des interférences aux téléviseurs et magnétoscopes. Pour réduire ou prévenir de tels parasites, ne pas déposer la base du téléphone sans fil à proximité d'un téléviseur ou magnétoscope, ni directement sur celui-ci. Si votre téléviseur affiche des interférences, éloignez le téléphone sans fil de celui-ci afin de réduire les parasites.
- ▶ Piles rechargeables : Ce produit comporte des piles rechargeables à l'hydrure métallique de nickel. Usez de prudence lorsque vous manipulez de telles piles et veillez à ne pas les court-circuiter avec des matériaux conducteurs, tels que des bagues, bracelets et clés. La pile ou le conducteur peut surchauffer et vous brûler. Respectez la polarité adéquate entre les piles et le chargeur de piles.
- ▶ Piles rechargeables à l'hydrure métallique de nickel : Jetez ces piles de manière sécuritaire. N'incinerez pas et ne percez pas les piles. Comme pour les autres piles du même type, si elles sont brûlées ou percées, des matières corrosives peuvent s'en échapper, ce qui risque de causer des brûlures ou autres blessures corporelles.



Le sceau de l'organisme de recyclage RBRC sur les piles à l'hydrure métallique de nickel signifie que le fabricant de cet appareil participe volontairement au programme industriel visant à reprendre et recycler ce type de piles lorsqu'elles ne servent plus, au sein du territoire des États-Unis et du Canada. Vous devez apporter ces piles chez un détaillant participant ou le centre de recyclage le plus près de chez vous. Ou vous pouvez composer le 1-800-8-BATTERY<sup>MD</sup> afin de connaître les endroits qui acceptent les piles à l'hydrure métallique de nickel mortes.

RBRC Seal et 1-800-8-BATTERY<sup>MD</sup> sont des marques déposées de Call2recycle, Inc.



## For C-UL compliance

### **Mesures préventives pour les utilisateurs de stimulateurs cardiaques implantés dans l'organisme**

---

Stimulateurs cardiaques (ne s'applique qu'aux téléphones sans fil numériques) :

L'organisme 'Wireless Technology Research, LLC (WTR)', une firme de recherche indépendante, a mené une évaluation pluridisciplinaire des interférences entre les téléphones sans fil portatifs et les stimulateurs cardiaques implantés dans l'organisme. Appuyée par l'Administration des aliments et drogues (FDA) des États-unis, la firme WTR recommande aux médecins :

#### **Avis aux détenteurs de stimulateurs cardiaques:**

- ▶ Ils doivent tenir le téléphone sans fil à une distance d'au moins six pouces du stimulateur cardiaque.
- ▶ Ils ne doivent PAS placer le téléphone sans fil directement sur le stimulateur cardiaque, tel que dans une poche de chemise, lorsque celui-ci est en fonction.
- ▶ Ils doivent utiliser le téléphone sans fil en l'appuyant sur l'oreille qui se trouve dans la direction opposée au stimulateur cardiaque.

L'étude effectuée par l'organisme WRS n'a pas identifié de risque pour les détenteurs de simulateurs cardiaques causé par les gens qui utilisent un téléphone sans fil à proximité de ceux-ci.

### **Mode ECO**

---

Lorsque le socle communique avec le combiné, le mode ECO sera activé automatiquement. Ceci réduit la consommation d'énergie selon la distance entre le socle du téléphone et le combiné.

### **Spécifiquement en rapport avec les répondeurs téléphoniques**

---

Enregistrement deux voies : Cet appareil n'émet pas de bips d'avertissement qui permettent de prévenir l'autre partie que vous enregistrez la conversation. Pour assurer votre conformité aux règlements fédéraux ou provinciaux en rapport avec les enregistrements des conversations téléphoniques, vous devriez informer l'autre partie lorsque vous activez l'enregistrement.

## **CONSERVEZ CES INSTRUCTIONS**

---



## FCC Part 68 and ACTA

This equipment complies with Part 68 of the FCC rules and with technical requirements adopted by the Administrative Council for Terminal Attachments (ACTA). The label on the back or bottom of this equipment contains, among other things, a product identifier in the format US:AAAEQ##TXXXX. This identifier must be provided to your telephone service provider upon request.

The plug and jack used to connect this equipment to premises wiring and the telephone network must comply with the applicable Part 68 rules and technical requirements adopted by ACTA. A compliant telephone cord and modular plug is provided with this product. It is designed to be connected to a compatible modular jack that is also compliant. An RJ11 jack should normally be used for connecting to a single line and an RJ14 jack for two lines. See the installation instructions in the user's manual.

The Ringer Equivalence Number (REN) is used to determine how many devices you may connect to your telephone line and still have them ring when you are called. The REN for this product is encoded as the 6th and 7th characters following the US: in the product identifier (e.g., if ## is 03, the REN is 0.3). In most, but not all areas, the sum of all RENs should be five (5.0) or less. For more information, please contact your telephone service provider.

This equipment must not be used with Party Lines. If you have specially wired alarm dialing equipment connected to your telephone line, ensure the connection of this equipment does not disable your alarm equipment. If you have questions about what will disable the alarm equipment, consult your telephone service provider or a qualified installer.

If this equipment is malfunctioning, it must be unplugged from the modular jack until the problem has been corrected. Repairs to this telephone equipment can only be made by the manufacturer or its authorized agents. For repair procedures, follow the instructions outlined under the Limited warranty.

If this equipment is causing harm to the telephone network, the telephone service provider may temporarily discontinue your telephone service. The telephone service provider is required to notify you before interrupting service. If advance notice is not practical, you will be notified as soon as possible. You will be given the opportunity to correct the problem and the telephone service provider is required to inform you of your right to file a complaint with the FCC. Your telephone service provider may make changes in its facilities, equipment, operation, or procedures that could affect the proper functioning of this product. The telephone service provider is required to notify you if such changes are planned.

If this product is equipped with a corded or cordless handset, it is hearing aid compatible.

If this product has memory dialing locations, you may choose to store emergency telephone numbers (e.g., police, fire, medical) in these locations. If you do store or test emergency numbers, please:

- ▶ Remain on the line and briefly explain the reason for the call before hanging up.
- ▶ Perform such activities in off-peak hours, such as early morning or late evening.



## FCC Part 68 and ACTA

### **Industry Canada**

This device contains licence-exempt transmitter(s)/receiver(s) that comply with Innovation, Science and Economic Development Canada's licence-exempt RSS(s). Operation is subject to the following two conditions:

(1) This device may not cause interference.

(2) This device must accept any interference, including interference that may cause undesired operation of the device.

Privacy of communications may not be ensured when using this telephone.

The term "IC:" before the certification/registration number only signifies that the Industry Canada technical specifications were met.

The Ringer Equivalence Number (REN) for this terminal equipment is 0.1. The REN indicates the maximum number of the maximum number of devices allowed to be connected to a telephone interface. The termination of an interface may consist of any combination of devices subject only to the requirement that the sum of the RENs of all the devices not exceed five.

This product meets the applicable Innovation, Science and Economic Development Canada technical specifications.



## Appendix

# FCC Part 15

NOTE: This equipment has been tested and found to comply with the requirements for a Class B digital device under Part 15 of the Federal Communications Commission (FCC) rules. These requirements are intended to provide reasonable protection against harmful interference in a residential installation. This equipment generates, uses and can radiate radio frequency energy and, if not installed and used in accordance with the instructions, may cause harmful interference to radio communications. However, there is no guarantee that interference will not occur in a particular installation. If this equipment does cause harmful interference to radio or television reception, which can be determined by turning the equipment off and on, the user is encouraged to try to correct the interference by one or more of the following measures:

- ▶ Reorient or relocate the receiving antenna.
- ▶ Increase the separation between the equipment and receiver.
- ▶ Connect the equipment into an outlet on a circuit different from that to which the receiver is connected.
- ▶ Consult the dealer or an experienced radio/TV technician for help.

WARNING: Changes or modifications to this equipment not expressly approved by the party responsible for compliance could void the user's authority to operate the equipment.

This device complies with Part 15 of the FCC Rules. Operation is subject to the following two conditions: (1) this device may not cause harmful interference, and (2) this device must accept any interference received, including interference that may cause undesired operation. Privacy of communications may not be ensured when using this telephone.

To ensure safety of users, the FCC/ISED has established criteria for the amount of radio frequency energy that can be safely absorbed by a user or bystander according to the intended usage of the product. This product has been tested and found to comply with the FCC/ISED criteria. The handset may be safely held against the ear of the user. The telephone base shall be installed and used such that parts of the user's body other than the hands are maintained at a distance of approximately 20 cm (8 inches) or more.

This Class B digital apparatus complies with Canadian requirement:  
CAN ICES-3 (B)/NMB-3(B)



# California Energy Commission battery charging testing instructions

This telephone is set up to comply with the energy-conserving standards right out of the box. These instructions are intended for California Energy Commission (CEC) compliance testing only. When the CEC battery charging testing mode is activated, all telephone functions, except battery charging, will be disabled.

## To activate the CEC battery charging testing mode:

1. Unplug the telephone base power adapter from the power outlet. Make sure all handsets are inserted with charged batteries before proceeding.
2. While you press and hold  **FIND HS**, plug the telephone base power adapter back to the power outlet.
3. After about 20 seconds, when the **IN USE** light starts flashing, release  **FIND HS** and then press it again within two seconds.



The process takes up to one minute to complete. When the phone successfully enters the CEC battery charging testing mode, the **IN USE** light turns off and all handsets display **To register HS, see manual**. You hear a confirmation tone.

When the phone fails to enter this mode, repeat the steps mentioned above.

**Note:** The telephone base will be powered up as normal if you fail to press  **FIND HS** within two seconds in Step 3.

## To deactivate the CEC battery charging testing mode:

1. Unplug the telephone base power adapter from the power outlet, then plug it back in. The telephone base is powered up as normal.
2. Register your handsets back to the telephone base. See pages 125-126 for handset registration instructions.



## Limited warranty

The AT&T brands are used under license. This product is covered by a one-year limited warranty. Any replacement or warranty service, and all questions about this product, should be directed to our website at

**<https://telephones.att.com>** or call **1 (800) 222-3111**. In Canada, dial **1 (866) 288-4268**.

### **1. What does this limited warranty cover?**

The manufacturer of this AT&T Product, Advanced American Telephones, warrants to the holder of a valid proof of purchase (“Consumer” or “you”) that the Product and all accessories provided by Advanced American Telephones in the sales package (“Product”) are free from material defects in material and workmanship, pursuant to the following terms and conditions, when installed and used normally and in accordance with operation instructions. This limited warranty extends only to the Consumer for Products purchased and used in the United States of America and Canada.

### **2. What will Advanced American Telephones do if the Product is not free from material defects in materials and workmanship during the limited warranty period (“Materially Defective Product”)?**

During the limited warranty period, Advanced American Telephones’ authorized service representative will replace, at Advanced American Telephones’ option, without charge, a Materially Defective Product. If we choose to replace this Product, we may replace it with a new or refurbished Product of the same or similar design. Advanced American Telephones will return replacement Products to you in working condition.

Advanced American Telephones will retain defective parts, modules, or equipment. Replacement of Product, at Advanced American Telephones’ option, is your exclusive remedy. You should expect the replacement to take approximately 30 days.

### **3. How long is the limited warranty period?**

The limited warranty period for SynJ® and Syn248® products is TWO (2) YEARS from the date of purchase, while all other products limited warranty period is ONE (1) YEAR from the date of purchase. If we replace a Materially Defective Product under the terms of this limited warranty, this limited warranty also applies to replacement Products for a period of either (a) 90 days from the date the replacement Product is shipped to you or (b) the time remaining on the original one-year limited warranty, whichever is longer.



## Limited warranty

### 4. What is not covered by this limited warranty?

This limited warranty does not cover:

- ▶ Product that has been subjected to misuse, accident, shipping or other physical damage, improper installation, abnormal operation or handling, neglect, inundation, fire, water or other liquid intrusion; or
- ▶ Product that has been damaged due to repair, alteration or modification by anyone other than an authorized service representative of Advanced American Telephones; or
- ▶ Product to the extent that the problem experienced is caused by signal conditions, network reliability or cable or antenna systems; or
- ▶ Product to the extent that the problem is caused by use with non-Advanced American Telephones electrical accessories; or
- ▶ Product whose warranty/quality stickers, Product serial numbers plates or electronic serial numbers have been removed, altered or rendered illegible; or
- ▶ Product purchased, used, serviced, or shipped for repair from outside the United States, or used for commercial or institutional purposes (including but not limited to Products used for rental purposes); or
- ▶ Product returned without valid proof of purchase (see 2 below); or
- ▶ Charges for installation or set up, adjustment of customer controls, and installation or repair of systems outside the unit.

### 5. How do you get warranty service?

To obtain warranty service in the United States of America, visit

**<https://telephones.att.com>** or call **1 (800) 222-3111**. In Canada, dial **1 (866) 288-4268**.

NOTE: Before calling for service, please check the user's manual. A check of the Product controls and features may save you a service call.

Except as provided by applicable law, you assume the risk of loss or damage during transit and transportation and are responsible for delivery or handling charges incurred in the transport of Product(s) to the service location. Advanced American Telephones will return replaced Product under this limited warranty to you, transportation, delivery or handling charges prepaid. Advanced American Telephones assumes no risk for damage or loss of the Product in transit.



## Limited warranty

### 6. What must you return with the **PRODUCT** to get warranty service?

1. Return the entire original package and contents including the Product to the Advanced American Telephones service location along with a description of the malfunction or difficulty;
2. Include “valid proof of purchase” (sales receipt) identifying the Product purchased (Product model) and the date of purchase or receipt; and
3. Provide your name, complete and correct mailing address and telephone number.

### 7. Other limitations

This warranty is the complete and exclusive agreement between you and Advanced American Telephones. It supersedes all other written or oral communications related to this Product. Advanced American Telephones provides no other warranties for this Product. The warranty exclusively describes all of Advanced American Telephones’ responsibilities regarding the Product. There are no other express warranties. No one is authorized to make modifications to this limited warranty and you should not rely on any such modification.

**State/Provincial Law Rights:** This warranty gives you specific legal rights, and you may also have other rights which vary from state to state.

**Limitations:** Implied warranties, including those of fitness for a particular purpose and merchantability (an unwritten warranty that the Product is fit for ordinary use) are limited to one year from date of purchase. Some states/provinces do not allow limitations on how long an implied warranty lasts, so the above limitation may not apply to you.



In no event shall Advanced American Telephones be liable for any indirect, special, incidental, consequential, or similar damages (including, but not limited to lost profits or revenue, inability to use the Product, or other associated equipment, the cost of substitute equipment, and claims by third parties) resulting from the use of this Product. Some states/provinces do not allow the exclusion or limitation of incidental or consequential damages, so the above limitation or exclusion may not apply to you.

**Please retain your original sales receipt as proof of purchase.**



Appendix

# Technical specifications

RF frequency band		1921.536MHz — 1928.448MHz
Channels		5
Telephone base voltage (AC voltage, 60Hz)		96 — 130 Vrms
 	Telephone base voltage (AC adapter output)	6VDC @0.4A Max. PS1 or LPS
	Charger voltage (AC adapter output)	6VDC @0.4A Max. PS1 or LPS
Handset battery		2.4V Ni-MH battery
Operating times*		Talk time (handset): up to 7 hours Standby: up to 5 days

\* Operating times vary depending on your actual use and the age of the battery.

## DECT 6.0 digital technology

The AT&T DECT 6.0 products offer unsurpassed range performance and sound clarity. This is achieved through a unique antenna design and advances in noise-filtering technology. An independent laboratory has confirmed that AT&T DECT 6.0 products perform up to 45% better in range competitions against similarly equipped phones of the leading competition. Now, calls can be taken in the basement, backyard and garage with exceptional sound quality.

## Telephone operating range

This cordless telephone operates within the maximum power allowed by the Federal Communications Commission (FCC). Even so, this handset and telephone base can communicate over a certain distance — which can vary with the locations of the telephone base and handset, the weather, and the construction of your home or office.

## Redefining long range coverage and clarity

This telephone base comes with an antenna which gives much better clarity and covers a longer range than before.

## HD audio

HD audio improves sound quality by expanding and rebuilding frequencies that are lost with traditional phone calls. There is no additional telephone service requirement to use HD audio. It is designed to work with standard telephone service. Your system will automatically enhance all received sound with HD audio.

## Simulated full-duplex handset speakerphone

The simulated full-duplex speakerphone on your handset allows both ends of a call to speak and be heard at the same time. Optimal performance is subject to external factors and individual usage.



# Index

## A

---

- Alert tones
  - handset 130
  - telephone base 130
- Allow list 84–88
- Announcement 104
- Answer an incoming call
  - during an intercom call 44
  - during PTT 50, 51
- Answering calls 34
- Answering system 104–124
- Assign a speed dial number 59
- Auto off 34

## B

---

- Battery charging 13
- Battery installation 13, 14
- Blind transfer 41
- Block list 79–83

## C

---

- Call transfer 45
- Caller ID announce 25
- Caller ID (CID)
  - add entries to phone
    - directory 69, 70
  - delete entries 68
  - dial entries 68
  - review entries 66
- Calls without numbers 76
- Chain dialing 39
- Charger installation 11, 12
- Clear voicemail indication 28
- Clock 23

## D

---

- Day and time 23
- Delete
  - a caller ID log entry 68
  - a directory entry 57
  - a speed dial number 61, 62
- Dialing
  - from a record in the caller ID history 68
  - from the directory 57
- Directory
  - dial a number 57
  - edit entries 58
  - name search 56
  - new entries 53
- Display dial 57
- DSL 11, 18

## E

---

- Ending a call 34

## H

---

- Handset
  - handset locator 42
  - quick reference guide 5–8
  - ringer tone 22
  - ringer volume 21
  - screen icons 129
  - speakerphone 35
  - temporary ringer silencing 35
  - voicemail indicator 27
- HD audio 160



## I

---

Important safety  
    information 1–3  
Installation 1, 2, 3, 4  
Intercom 43–45

## L

---

Last number redial 35  
LCD language  
    reset LCD language 24  
Lights 131  
Limited warranty 157–159

## M

---

Maintenance 148  
Make an outgoing call during  
    PTT 50  
Making calls 34  
Memory match 65  
Message  
    alert tone 111  
    counter display 122  
    playback 118–120  
Mute 38

## N

---

Names  
    enter into directory 53  
    search 56  
Number of rings 109

## O

---

On-hook dialing (predialing) 34  
Outgoing announcement 104

## P

---

Paging tone 42  
Power adapter 12  
Predialing 34  
Push-to-talk 46–51

## Q

---

Quick reference guide 5–10  
Quiet mode 33

## R

---

Reassign a speed dial  
    number 60  
Receiving calls 34  
Recharging 15  
Redial 35  
Remote access 123–124  
Ringer silencing 35  
Ring tone options 22

## S

---

Screen display  
    messages 132–134  
Screen robocalls 101–102  
Screen unknown calls 98–100  
Smart call blocker 73–103  
    allowed calls 96  
    allow list 84–88  
    blocked calls 97  
    block list 79–83  
    option while on a call 103  
    screening  
        announcement 93–95  
    screen robocalls 101–102



# Index

- screen unknown calls 98–100
- Set profile 77–78
- set Smart call blocker
  - on/off 77
- star name list 89–92
- Speakerphone 35
- Speed dial
  - delete a number 61, 62
  - edit a number 60
  - enter a number 59
- Star name list 89–92

## T

---

- Technical specifications 160
- Telephone base
  - quick reference guide 10
- Temporary ringer silencing 35
- Time 23
- Troubleshooting 136–147

## U

---

- Uncategorized calls 76
- Unknown calls 76
- Unwelcome calls 75

## V

---

- Visual message waiting
  - indicator 27
- Voice guide 17, 107
- Voicemail 27, 113
  - quick access 60, 62
- Voice prompts 115

- Volume control
  - handset 21, 37, 38, 118
  - telephone base 118

## W

---

- Wall-mount installation 18
- Warranty 157–159
- Welcome calls 75



# Remote access wallet card

Use the following wallet card to help you remember commands to control your answering system from any touch-tone telephone.

Cut along dotted line.



Call your phone number,  
then enter your two-digit  
access code (preset to **19**).

Action	Remote command
--------	----------------

Play all messages.....	1
Play new messages.....	2
Delete the message .....	3
Delete all old messages .....	33
Repeat or go back.....	4
Stop .....	5
Help menu .....	*5

Fold here.

Skip the message.....	6
Record announcement.....	*7
End remote access call .....	8 (or hang up)
Turn system off or on .....	0

**Models:** CL82219/CL82229/CL82319/CL82419/CL82519

**Type:** DECT 6.0 cordless telephone/answering system with caller ID  
call waiting

© 2019-2022 Advanced American Telephones. All Rights Reserved.  
AT&T and the AT&T logo are trademarks of AT&T Intellectual Property  
licensed to Advanced American Telephones, San Antonio, TX 78219.  
Printed in China.





**<https://telephones.att.com>**

Company: Advanced American Telephones

Address: 9020 SW Washington Square Road - Ste 555 Tigard, OR 97223, United States.

Phone: 1 (800) 222-3111 in the U.S. or 1 (866) 288-4268 in Canada

© 2019-2022 Advanced American Telephones. All Rights Reserved.

AT&T and the AT&T logo are trademarks of AT&T Intellectual Property licensed to  
Advanced American Telephones, San Antonio, TX 78219.

Qaltel™ is a trademark of Truecall Group Limited.

SynJ® and Syn248® are trademarks of Advanced American Telephones.

The RBRC Seal and 1-800-8-BATTERY® are registered trademarks of Call2recycle, Inc.

Printed in China. Issue 3.0 AT&T 10/22.