

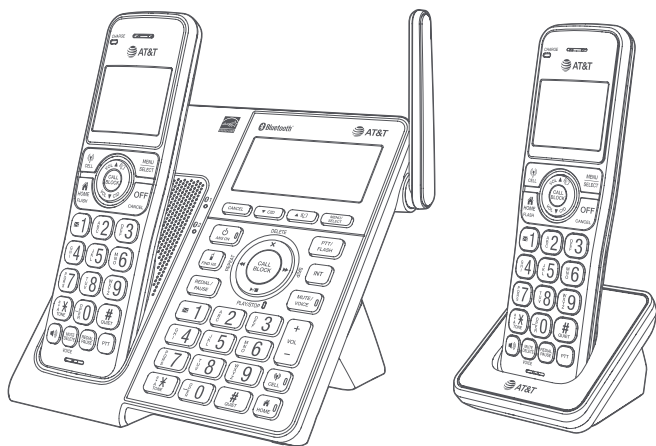

Quick start guide

BL3107/BL3107-2/BL3107-3/
BL3107-4/BL3107-5

DECT 6.0 cordless telephone/
answering system with
BLUETOOTH® wireless technology



Scan the QR code for
support information



Congratulations

on your purchase of this AT&T product. Before using this AT&T product, please read the **Important safety information** section on pages 1-3 of this manual.

Both the model and serial numbers of your AT&T product can be found on the bottom of the telephone base. Save your sales receipt and original packaging in case it is necessary to return your telephone for warranty service.

For customer service, please visit our website at <https://telephones.att.com> or call **1 (800) 222-3111**. In Canada, dial **1 (866) 288-4268**.



Please refer to the online **BL3107/BL3107-2/BL3107-3/BL3107-4/BL3107-5** DECT 6.0 cordless telephone/answering system with **BLUETOOTH®** wireless technology Complete user's manual for a full set of installation and operation instructions at <https://telephones.att.com/manuals>.

Parts checklist

Your telephone package contains the following items.



Quick start guide



Smart call blocker leaflet



Telephone base



Power adapter for telephone base



Cordless handset
(1 for BL3107)
(2 for BL3107-2)
(3 for BL3107-3)
(4 for BL3107-4)
(5 for BL3107-5)



Charger for cordless handset with power adapter installed
(1 for BL3107-2)
(2 for BL3107-3)
(3 for BL3107-4)
(4 for BL3107-5)

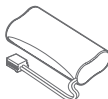

Battery for cordless handset
(1 for BL3107)
(2 for BL3107-2)
(3 for BL3107-3)
(4 for BL3107-4)
(5 for BL3107-5)



Battery compartment cover
(1 for BL3107)
(2 for BL3107-2)
(3 for BL3107-3)
(4 for BL3107-4)
(5 for BL3107-5)



Telephone line cord



Wall-mount bracket

Important safety information



This symbol is to alert you to important operating or servicing instructions that may appear in this user's manual. Always follow basic safety precautions when using this product to reduce the risk of injury, fire, or electric shock.

Safety information

- ▶ Read and understand all instructions in the user's manual. Observe all markings on the product.
- ▶ Use only with UL listed Bluetooth devices.
- ▶ Avoid using a telephone during a thunderstorm. There may be a slight chance of electric shock from lightning.
- ▶ Do not use a telephone in the vicinity of a gas leak. Under certain circumstances, a spark may be created when the adapter is plugged into the power outlet, or when the handset is replaced in its cradle. This is a common event associated with the closing of any electrical circuit. In an inadequately ventilated environment, the user should not plug the phone into a power outlet, nor put a charged handset into the cradle where there are concentrations of flammable or flame-supporting gases. A spark in such an environment could create a fire or explosion. Such environments might include: medical use of oxygen without adequate ventilation; industrial gases (cleaning solvents; gasoline vapors; etc.); a leak of natural gas; etc.
- ▶ Do not use this product near water or when you are wet. For example, do not use it in a wet basement or shower, nor next to a swimming pool, bathtub, kitchen sink and laundry tub. Do not use liquids or aerosol sprays for cleaning. If the product comes in contact with any liquid, unplug any line or power cord immediately. Do not plug the product back in until it has dried thoroughly.
- ▶ Install this product in a protected location where no one can trip over any line or power cords. Protect cords from damage or abrasion.
- ▶ If this product does not operate normally, see the **Troubleshooting** section of the online Complete user's manual. If you cannot solve the problem, or if the product is damaged, refer to the **Limited warranty** section (pages 41 - 43). Do not open this product except as directed in your user's manual. Opening the product or reassembling it incorrectly may expose you to hazardous voltages or other risks.
- ▶ Replace batteries, only as described in your user's manual (Page 6). Do not burn or puncture batteries — they contain caustic chemicals.
- ▶ This power adapter is intended to be correctly oriented in a vertical or floor mount position. The prongs are not designed to hold the plug in place if it is plugged into a ceiling or an under-the-table/cabinet outlet.
- ▶ For pluggable equipment, the socket-outlet shall be installed near the equipment and shall be easily accessible.



CAUTIONS:

- ▶ Use only the power adapter provided with this product. To obtain a replacement, visit our website at <https://telephones.att.com> or call **1 (800) 222-3111**. In Canada, dial **1 (866) 288-4268**.

Important safety information



CAUTION: To prevent risk of fire or battery explosion, replace with the correct battery type. Dispose of used batteries according to the instructions.

- ▶ Disconnect the telephone line from the equipment before open the battery door.
Do not use the battery in following conditions:
 - ▶ High or low extreme temperature during use, storage or transportation.
 - ▶ Replacement of a battery with an incorrect type that can defeat a safeguard.
 - ▶ Disposal of a battery into fire or a hot oven, or mechanically crushing or cutting of a battery, that can result in an explosion.
 - ▶ Leaving a battery in an extremely high temperature surrounding environment that can result in an explosion or the leakage of flammable liquid or gas.
 - ▶ A battery subjected to extremely low air pressure that can result in an explosion or the leakage of flammable liquid or gas.
- ▶ Use only the supplied rechargeable battery or replacement battery (model BT162342/BT262342). To order, visit our website at **<https://telephones.att.com>**, or call **1 (800) 222-3111**. In Canada, dial **1 (866) 288-4268**.
- ▶ The applied nameplate is located at the bottom or near of the product.

Especially about cordless telephones

- ▶ **Privacy:** The same features that make a cordless telephone convenient create some limitations. Telephone calls are transmitted between the telephone base and the handset by radio waves, so there is a possibility that your cordless telephone conversations could be intercepted by radio receiving equipment within range of the cordless handset. For this reason, you should not think of cordless telephone conversations as being as private as those on corded telephones.
- ▶ **Electrical power:** The telephone base of this cordless telephone must be connected to a working electrical outlet which is not controlled by a wall switch. Calls cannot be made from the handset if the telephone base is unplugged, switched off or if the electrical power is interrupted.
- ▶ **Potential TV interference:** Some cordless telephones operate at frequencies that may cause interference to TVs and VCRs. To minimize or prevent such interference, do not place the telephone base of the cordless telephone near or on top of a TV or VCR. If interference is experienced, moving the cordless telephone farther away from the TV or VCR will often reduce or eliminate the interference.
- ▶ **Rechargeable batteries:** This product contains nickel-metal hydride rechargeable batteries. Exercise care in handling batteries in order not to create a short circuit with conductive material such as rings, bracelets, and keys. The battery or

Important safety information

conductor may overheat and cause harm. Observe proper polarity between the battery and the battery charger.

- ▶ Nickel-metal hydride rechargeable batteries: Dispose of these batteries in a safe manner. Do not burn or puncture. Like other batteries of this type, if burned or punctured, they could release caustic material which could cause injury.



The RBRC Seal means that the manufacturer is voluntarily participating in an industry program to collect and recycle nickel-metal hydride rechargeable batteries when taken out of service within the United States. These batteries may be taken to a participating local retailer of replacement batteries or recycling center. You may call 1-800-8-BATTERY® for locations accepting spent Ni-MH batteries.

The RBRC Seal and 1-800-8-BATTERY® are registered trademarks of Call2recycle, Inc.

Precautions for users of implanted cardiac pacemakers

Cardiac pacemakers (applies only to digital cordless telephones):

Wireless Technology Research, LLC (WTR), an independent research entity, led a multidisciplinary evaluation of the interference between portable wireless telephones and implanted cardiac pacemakers. Supported by the U.S. Food and Drug Administration, WTR recommends to physicians that:

Pacemaker patients:

- ▶ Should keep wireless telephones at least six inches from the pacemaker.
- ▶ Should NOT place wireless telephones directly over the pacemaker, such as in a breast pocket, when it is turned ON.
- ▶ Should use the wireless telephone at the ear opposite the pacemaker.

WTR's evaluation did not identify any risk to bystanders with pacemakers from other persons using wireless telephones.

ECO mode

This power conserving technology reduces power consumption for optimal battery performance. The ECO mode activates automatically whenever the handset is synchronized with the telephone base.

Especially about telephone answering systems

Two-way recording: This unit does not sound warning beeps to inform the other party that the call is being recorded. To ensure that you are in compliance with any federal or state regulations regarding recording a telephone call, you should start the recording process and then inform the other party that you are recording the conversation.

SAVE THESE INSTRUCTIONS

Table of contents

Important safety information	1
Install.....	5
Wall-mount installation (optional)	7
Handset overview	8
Telephone base overview.....	11
Screen display overview.....	14
Initial basic settings.....	15
Date and time	16
Smart call blocker setup via voice guide.....	16
Basic answering system setup via voice guide.....	16
Record your own announcement.....	17
Number of rings.....	17
Ringer volume.....	18
LCD language.....	18
Voice language.....	19
Bluetooth®.....	19
Add a Bluetooth® cell phone/headset.....	19
Download a cell phone phonebook.....	20
Connect to Cell™ app.....	20
Remote voice control	21
Operate.....	22
Push-to-talk (PTT).....	23
Phonebook	24
Caller ID.....	25
Caller ID announce.....	25
Review and dial a number in the call log.....	25
Erase missed calls indicator in the call log.....	26
Smart call blocker *§.....	26
What is Smart call blocker?	26
Default scenarios of Smart call blocker handling.....	27
Prerequisite setups.....	27
Other popular scenarios.....	29
Block an incoming call.....	30
Block the caller while on a call.....	31
Unblock a telephone number	31
Answering system.....	32
About answering system and voicemail.....	32
Turn answering system on or off.....	33
Message alert tone.....	33
Call screening.....	33
Message playback.....	34
For C-UL compliance.....	35
FCC Part 68 and ACTA.....	39
FCC Part 15.....	40
Limited warranty.....	41
Technical specifications.....	44

Install

Telephone base

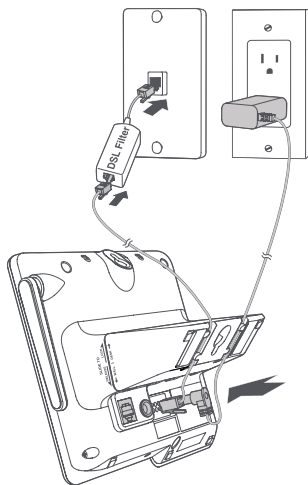

Notes:

- ▶ Plug one end of the telephone line cord into a telephone jack or a DSL filter.
- ▶ If you have DSL high-speed Internet service, a DSL filter (not included) is required.

Charger

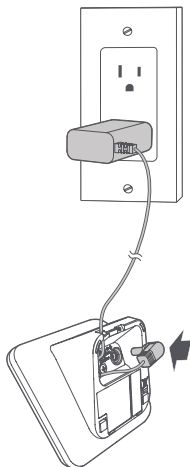

Caution: Use only the power adapter(s) provided with this product. To obtain a replacement, visit our website at

<https://telephones.att.com>

or call **1 (800) 222-3111**. In Canada, dial **1 (866) 288-4268**.

Install

Battery

Install the battery, as shown below.

1

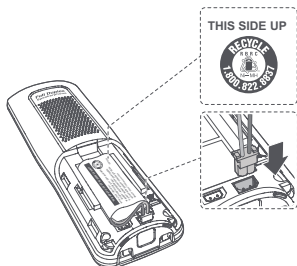

2

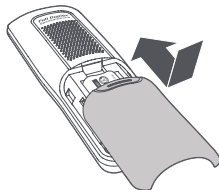

3

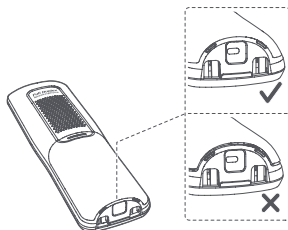

Charge your handset(s) before initial use. The battery is fully charged after 16 hours of continuous charging. The **CHARGE** light on the top of the handset is on during charging.

4

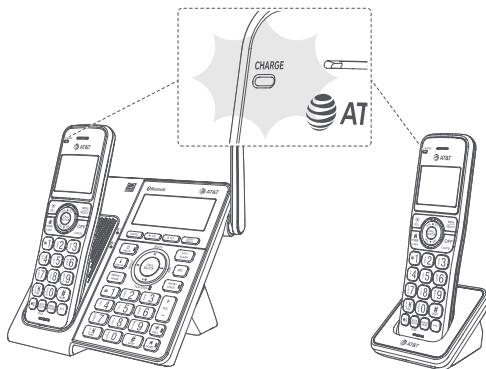

Caution: Use only the supplied rechargeable battery or replacement battery (model BT162342/BT262342).



Wall-mount installation (optional)

- 1 Insert the extended tabs of the wall-mount bracket into the slots at the back of the telephone base. Push the wall-mount bracket upward to lock it securely in place.

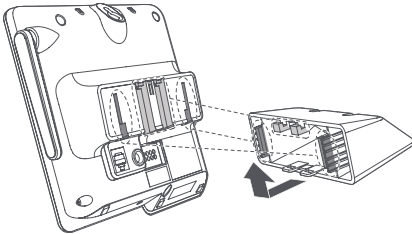

- 2 Plug the telephone line and the power adapter into the telephone base.

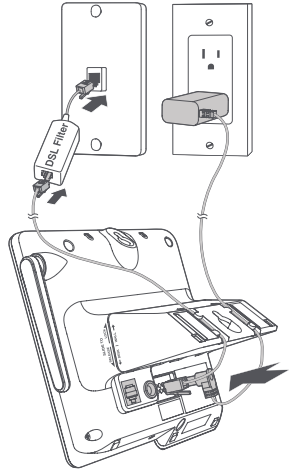

- 3 Align the wall-mounting holes on the telephone base with the standard wall plate and slide the telephone base down until it locks securely.

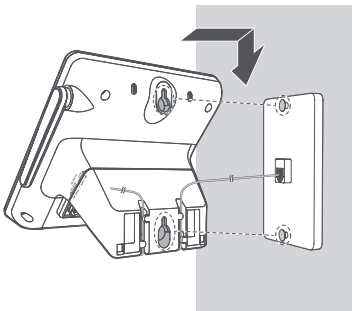

- 4 Plug the telephone line into the wall outlet and plug other end of the power adapter into a power outlet not controlled by a wall switch.





Handset overview

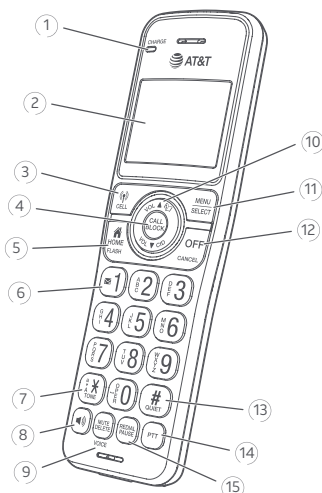



Handset

-
- ① **CHARGE** light › On when the handset is charging in the telephone base or charger.
-
- ② **LCD display**
-
- ③ **CELL** › Press to make a cell call.
› Press to answer a cell call.
-
- ④ **CALL BLOCK** › Press to block the incoming call when the telephone is ringing.
› When on a call, press to block the call.
› Press to show the call block menu when the handset is not in use.
-
- ⑤ **HOME/FLASH** › Press to make a home call.
› Press to answer a home call.
› During a home or cell call, press to answer an incoming call when you receive a call waiting alert.
-
- ⑥ **1** › While reviewing a caller ID log entry, press repeatedly to add or remove 1 in front of the telephone number before dialing or saving it in the phonebook.
› Press and hold to set or to dial your voicemail number.



Handset overview

- ⑦ **TONE ✕/a>A**
- › Press to switch to tone dialing temporarily during a call if you have pulse service.
 - › Press to change the next letter to upper or lower case while entering names.
- OPER 0**
- › Press to insert a space while entering names.
-
- ⑧ 
- › Press to make or answer a home or cell call using the speakerphone.
 - › Press to switch between the speakerphone and the handset.
-
- ⑨ **MUTE/
DELETE/
VOICE**
- › During a call, press to mute the microphone.
 - › When the handset is ringing, press to mute the ringer temporarily.
 - › While reviewing the caller ID log, phonebook, redial list, block list or star name list, press to delete an individual entry.
 - › While predialing, press to delete digits.
 - › When entering names or numbers, press to delete a digit or character.
 - › When entering names or numbers, press and hold to erase all digits or characters.
 - › During message or announcement playback, press to delete the playing message or the recorded announcement.
 - › While connected to one or two cell phones and the system is not in use, press to activate the voice-controlled application of one of the connected cell phones.
 - › Press this key while the system is not in use and has no paired cell phone(s), then the handset will prompt **Pair cell first** to remind you for remote voice control activation.
-
- ⑩ **VOL ▲** 
- › Press to show phonebook entries when the handset is not in use.
 - › Press to scroll up while in menus.
 - › Press to move the cursor to the right while entering names or numbers.
 - › Press to increase the listening volume when on a call.
 - › Press to increase the message playback volume.



Handset overview

- ⑩ **VOL ▼ CID**
- › Press to show caller ID log when the handset is not in use.
 - › Press to scroll down while in menus.
 - › Press to move the cursor to the left while entering names or numbers.
 - › Press to decrease the listening volume when on a call.
 - › Press to decrease the message playback volume.
-
- ⑪ **MENU/
SELECT**
- › Press to show the menu when the handset is not in use.
 - › Press to select an item while in a menu.
 - › Press to save an entry or setting while in a menu.
-
- ⑫ **OFF/CANCEL**
- › During a call, press to hang up.
 - › Press to cancel an operation while in a menu.
 - › Press to return to the previous menu.
 - › Press and hold to exit menu display completely.
 - › Press to mute the ringer temporarily when the handset is ringing.
 - › Press and hold while the telephone is not in use to erase the missed call indicator.
-
- ⑬ **QUIET#
(pound key)**
- › Press repeatedly to display other dialing options when reviewing a caller ID log entry.
 - › Press and hold to enter the **QUIET** mode setting screen, or to deactivate **QUIET** mode.
-
- ⑭ **PTT (PUSH
TO TALK)**
- › Press to initiate a one-to-one or one-to-group broadcast.
 - › Press and hold to broadcast to a group of system devices.
-
- ⑮ **REDIAL/
PAUSE**
- › Press repeatedly to view the last 10 numbers dialed.
 - › Press and hold to insert a dialing pause while entering numbers.



Telephone base overview

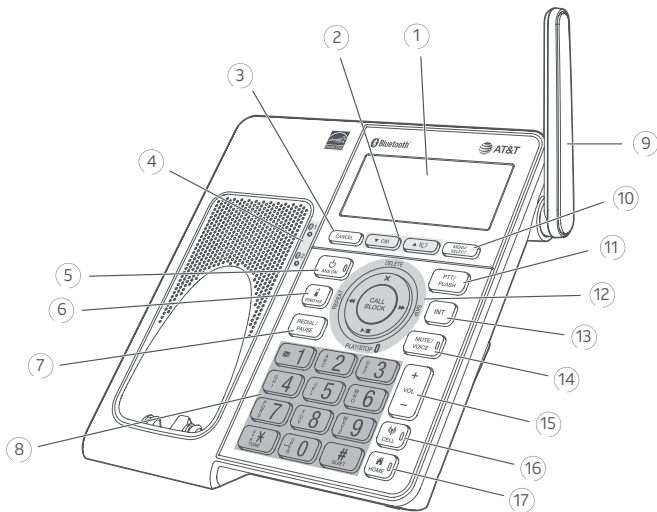

Telephone base

①

LCD display

②

▼ CID

- ▶ Press to show caller ID log when the handset is not in use.
- ▶ Press to scroll down while in menus.
- ▶ Press to move the cursor to the left while entering names or numbers.



- ▶ Press to show phonebook entries when the handset is not in use.
- ▶ Press to scroll up while in menus.
- ▶ Press to move the cursor to the right while entering names or numbers.

③

CANCEL

- ▶ Press to exit without making changes while in a menu.
- ▶ Press and hold to exit menu display completely.
- ▶ Press and hold while the telephone is not in use to erase the missed call indicator.

④

📶 1 Light

- ▶ On when the telephone is paired and connected with a Bluetooth device.
- ▶ Flashes while pairing a Bluetooth device.



Telephone base overview

④	2 Light	<ul style="list-style-type: none">› On when the telephone is paired and connected with a Bluetooth device or headset.› Flashes while pairing a Bluetooth device or headset.
⑤	/ANS ON	<ul style="list-style-type: none">› Press to turn the answering system on or off.
⑥	/FIND HS	<ul style="list-style-type: none">› Press to page all system handsets.
⑦	REDIAL/PAUSE	<ul style="list-style-type: none">› Press repeatedly to view the last 10 numbers dialed.› <u>Press and hold</u> to insert a dialing pause while entering numbers.
⑧	1	<ul style="list-style-type: none">› While reviewing a caller ID log entry, press repeatedly to add or remove 1 in front of the telephone number before dialing or saving it in the phonebook.› <u>Press and hold</u> to set or to dial your voicemail number.
	TONE X/a>A	<ul style="list-style-type: none">› Press to switch to tone dialing temporarily during a call if you have pulse service.› Press to change the next letter to upper or lower case while entering names.
	OPER 0	<ul style="list-style-type: none">› Press to insert a space while entering names.
	QUIET# (pound key)	<ul style="list-style-type: none">› Press repeatedly to display other dialing options when reviewing a caller ID log entry.› <u>Press and hold</u> to enter the QUIET mode setting screen, or to deactivate QUIET mode.
⑨	Antenna	
⑩	MENU/SELECT	<ul style="list-style-type: none">› Press to show the menu when the telephone base is not in use.› Press to confirm or save an entry or setting while in a menu.
⑪	PTT/FLASH	<ul style="list-style-type: none">› Press to display the PTT menu to begin a PTT call.› <u>Press and hold</u> to begin a one-to-group broadcast when the telephone base is not in use.› During a home or cell call, press to answer an incoming call when you receive a call waiting alert.



Telephone base overview

- 12**
- X/DELETE**
- › Press to delete the message currently playing.
 - › Press twice to delete all previously reviewed messages when the phone is not in use.
 - › While reviewing the redial list, phonebook, caller ID log, block list, or star name list, press to delete an individual entry.
 - › Press to delete a digit or a character while entering names or numbers.
 - › Press to delete a digits while predialing.
- ◀/REPEAT**
- › Press to repeat a message.
 - › Press twice to play the previous message.
- ▶/SKIP**
- › Press to skip to the next message.
- ▶/■/PLAY/STOP**
- › Press to play messages.
 - › Press to stop message playback.
- CALL BLOCK**
- › Press to block the incoming call when the telephone is ringing.
 - › When on a call, press to block the call.
 - › Press to show the call block menu when the telephone base is not in use.
-
- 13**
- INT**
- › Press to initiate an intercom conversation or transfer a call.
-
- 14**
- MUTE/VOICE**
- › During a call, press to mute the microphone.
 - › While the telephone base is ringing, press to silence the ringer temporarily.
 - › While connected to one or two cell phones and the system is not in use, press to activate the voice-controlled application of one of the connected cell phones.
 - › Press this key while the system is not in use and has no paired cell phone(s), then the telephone will prompt **Pair cell first** to remind you for remote voice control activation.
-
- 15**
- + VOL -**
- › Press to adjust the volume during message playback.
 - › Press to adjust the listening volume during a call.
 - › Press to adjust the telephone base ringer volume for all lines when the phone is not in use.
-
- 16**
- 📶 CELL**
- › Press to make a cell call.
 - › Press to answer a cell call.
 - › Light flashes quickly when there is an incoming cell call.
 - › Light flashes slowly when a cell call is on hold.



Telephone base overview

17

HOME

- › Press to make a home call.
- › Press to answer a home call.
- › Light flashes quickly when there is an incoming home call.
- › Light flashes slowly when a home call is on hold.
- › During a home or cell call, press to answer an incoming call when you receive a call waiting alert.



Screen display overview



Handset





Telephone base

	The battery icon flashes when the battery is low and needs charging.
	The battery icon animates when the battery is charging.
	The battery icon becomes solid when the battery is fully charged.
	The handset ringer is turned off.
	There are new voicemail received from the telephone service provider.
	Home line is in use.
	Bluetooth device is paired and active.
	Bluetooth device / Cell line is in use.
ANS ON	The answering system is turned on.
ECO	The ECO mode activates automatically to reduce power consumption when the handset is within range from the telephone base.



Screen display overview

NEW	The entry you are reviewing is new in the caller ID log.
	Handset displays the message number currently playing and total number of new/old messages recorded.
	Telephone base message counter displays the total number of messages.



Initial basic settings

After you install your telephone or power returns following a power outage, the handset and telephone base will prompt you to set the date and time. To skip setting the date and time, press **OFF/CANCEL** on the handset or press **CANCEL** on the telephone base.

Voice guide to set Smart call blocker and answering system

After the date and time setting is done or skipped, the telephone base will prompt if you want to set Smart call blocker. Press **MENU/SELECT** to start the Smart call blocker setup via voice guide. To skip the setup, press **CANCEL** twice on the telephone base.

After the Smart call blocker setting is done or skipped, the telephone base will then prompt you want to set up the answering system. Press **MENU/SELECT** to start the answering system setup via voice guide. To skip the setup, press **CANCEL** on the telephone base.

We recommend you program your telephone system before use. The following are a few examples of common features to set before using the telephone. Refer to the **Handset settings**, **Telephone base settings** and **Answering system settings** in the Complete user's manual for detailed instructions on setting all telephone features.



Initial basic settings

Date and time



Note: Set the date/time before using the answering system.

Using a cordless handset or the telephone base:

1. **MENU** -> ▼ / ▲ -> **Set date/time** -> **SELECT**.
2. Enter the month (**MM**), day (**DD**) and year (**YY**) -> **SELECT**.
3. Enter the hour (**HH**) and minute (**MM**).
4. ▼ / ▲ -> **AM** or **PM** -> **SELECT**.

Smart call blocker setup via voice guide

You can follow the voice guide to set up Smart call blocker.

Restart the voice guide:

Using the telephone base:

1. Press **CALL BLOCK** on the telephone base.
 2. ▼ / ▲ -> **SCB settings** -> **SELECT**.
 3. ▼ / ▲ -> **Voice guide** -> **SELECT**.
 4. When you hear the telephone base announces, "Hello! This voice guide will assist you with the basic set up of Smart Call blocker." Follow the voice guide to set or skip the settings.
 - ▶ To screen calls with telephone numbers that are not saved in your phonebook or star name list:-
 - ▶ All the callers will be asked to leave their names before connecting to you, unless you have saved their numbers in phonebook or their names in star name list.
- OR -**
- ▶ Do not screen calls, and allow all incoming calls to get through.
 - ▶ All incoming calls will ring but calls with numbers you have saved in your block list will be rejected.

Basic answering system setup via voice guide

Using the telephone base:

You can follow the voice guide to record your own announcement, set the number of rings and set the message alert tone.



Initial basic settings

Restart the voice guide:

1. Press **MENU**.
2. ▼ / ▲ -> **Answering sys** -> **SELECT**.
3. ▼ / ▲ -> **Voice guide** -> **SELECT**.
4. Set up the answering system by inputting the designated numbers, as instructed.

Record your own announcement

Your outgoing announcement plays when calls are answered by the answering system. You can use the preset announcement to answer calls, or replace it with your own recorded announcement.

Using a cordless handset:

1. **MENU** -> ▼ / ▲ -> **Answering sys** -> **SELECT**.
2. **SELECT** to select **Announcement**.
3. Press **7** to record.
4. Speak towards the handset to record your announcement and press **5** to end recording and save it.

Using the telephone base:

1. Press **MENU** twice.
2. **SELECT** to select **Announcement**.
3. **SELECT** again to select **Record annnc**.
4. Speak towards the telephone base to record your announcement and press **5** to end recording and save it.

Number of rings

You can set the answering system to answer an incoming call after 2, 3, 4, 5, or 6 rings. You can also select toll saver. If you choose toll saver, the answering system answers a call after two rings when you have new messages, or after four rings when there are no new messages. This enables you to check for new messages and avoid paying unnecessary long distance charges if you are calling from out of your local area.

Using a cordless handset or the telephone base:

1. **MENU** -> ▼ / ▲ -> **Answering sys** -> **SELECT**.
2. ▼ / ▲ -> **Ans sys setup** -> **SELECT**.



Initial basic settings

3. ▼ / ▲ -> **# of rings** -> **SELECT**.
4. ▼ / ▲ to choose among **6, 5, 4, 3, 2**, or **Toll saver** -> **SELECT**.

Ringer volume

You can set the ringer volume level to one of the six levels, or turn the ringer off, for incoming home or cell calls. When the ringer is off,  appears on the screen.

Using a cordless handset or the telephone base:

Set ringer volume for incoming home calls:

1. **MENU** -> ▼ / ▲ -> **Ringers** -> **SELECT**.
2. **SELECT** to select **Home volume**.
3. ▼ / ▲ to choose the desire level -> **SELECT**.

Set ringer volume for incoming cell calls:

1. **MENU** -> ▼ / ▲ -> **Ringers** -> **SELECT**.
2. ▼ / ▲ to to select **Cell volume** -> **SELECT**.
3. ▼ / ▲ to choose the desire level -> **SELECT**.

Adjust the telephone base volume:

- ▶ Press **VOL -** or **VOL +** on the base when the phone system is not in use.

LCD language

Using a cordless handset or the telephone base:

1. **MENU** -> ▼ / ▲ -> **Settings** -> **SELECT**.
2. **SELECT** again to select **LCD language**.
3. ▼ / ▲ to choose **English, Français** or **Español** -> **SELECT**.



Note: If you accidentally change the LCD language to French or Spanish, you can reset it back to English without going through the French or Spanish menus.

- ▶ Press **MENU** on the handset or telephone base when it is not in use -> enter ***364#**.

Initial basic settings

Voice language

The voice prompt language is preset to English. You can select English or French to be used for all voice prompts.



Note: This feature is available in Canada version only.

Using a cordless handset or the telephone base:

1. **MENU** -> ▼ / ▲ -> **Settings** -> **SELECT**.
2. ▼ / ▲ to choose **Voice language** -> **SELECT**.
3. ▼ / ▲ to choose **English** or **Français** -> **SELECT**.

Bluetooth®

Add a Bluetooth® cell phone/headset



Note: Your **BL3107/BL3107-2/BL3107-3/BL3107-4/BL3107-5** is compatible with Bluetooth version 2.0 or above devices.

To use a Bluetooth enabled cellular phone or headset with your telephone, you must first pair and connect your Bluetooth cellular phone or headset with the telephone base.

Bluetooth wireless technology operates within a short range (up to 15 feet). Keep the connected device within 15 feet of the telephone base for optimal performance.

Before you begin, make sure that you have cellular coverage and your Bluetooth enabled cell phone is not connected to any other Bluetooth device. Refer to your cell phone user's manual to learn how to search for or add new Bluetooth devices.

To pair and connect a cell phone using the telephone base:

1. **MENU** -> ▼ / ▲ -> **Bluetooth** -> **SELECT**.
2. **SELECT** to select **Add cellular**.
 - ▶ If there are already 2 paired devices on the list, press ▼ or ▲ to select the desired device -> **SELECT**.
3. Place the cell phone next to the telephone base. Turn on the Bluetooth feature of your cell phone and search for or add new devices. Once your cell phone finds your AT&T phone (**AT&T DECT 6.0**), press the appropriate key on your cell phone to continue the pairing process.



4. When the cell phone successfully connects to the telephone, the telephone screen displays the corresponding status icon (📶 1 or 📶 2) and the corresponding device light on the telephone base (📶 1 or 📶 2) turns on.

To pair and connect a headset using the telephone base:

1. Set your headset to discoverable mode.
 - ▶ Refer to the user's manual of your Bluetooth headset on how to pair it to your **BL3107/BL3107-2/BL3107-3/BL3107-4/BL3107-5** telephone.
2. **MENU** -> ▼ / ▲ -> **Bluetooth** -> **SELECT**.
3. ▼ / ▲ -> **Add headset** -> **SELECT**.
4. When the telephone displays **HEADSET FOUND** and the headset name -> **SELECT**.
5. When the headset successfully connects to the telephone, the telephone screen displays the status icon (📶 2) and the device light on the telephone base (📶 2) turns on.

Download a cell phone phonebook

To download a cell phone phonebook using the telephone base:

Before downloading a cell phone phonebook, make sure the cell phone is paired, active, and connected to your **BL3107/BL3107-2/BL3107-3/BL3107-4/BL3107-5**.

1. **MENU** -> ▼ / ▲ -> **Bluetooth** -> **SELECT**.
2. ▼ / ▲ -> **Download PB** -> **SELECT**.
 - ▶ If there are already 2 paired devices on the list, press ▼ or ▲ to select the desired device -> **SELECT** to start downloading.

Connect to Cell™ app

Connect to Cell™ application consists of **Caller ID manager** and **Alerts manager (Mobile notification)**. It extends the flexibility of your **BL3107/BL3107-2/BL3107-3/BL3107-4/BL3107-5** telephone system.

If you are using Bluetooth-enabled cell phones with Android® OS 2.3 or above, you may also download the **Connect to Cell™** application from Google Play® Store. You can also scan the QR code on the right to download the application.





Remote voice control

If you have connected a cell phone to the telephone system, you can activate the voice-controlled application (voice app) of the cell phone, such as Siri®, Google Now™ or S Voice®, using the handset or telephone base.

Compatibility:

The remote voice control feature works with:

Voice-controlled application	Siri	Google Now	S Voice
Operation System (Versions supported)	iOS (8 or above)	Android (4 or above)	Android (4 or above)

Before using the remote voice control feature, make sure you checked the following:

- ▶ Your cell phone is paired and connected to your telephone system via Bluetooth.
- ▶ No Bluetooth applications are running in the background of your cell phone.
- ▶ Keep your cell phone within 15 feet of the telephone base.
- ▶ Do not lock up your cell phone's screen or set passcode for activating the voice app.
- ▶ Make sure you have turned on or logged in to the applications on your cell phone that you will be sending your voice commands, such as GPS, e-mail and social networking accounts.
- ▶ Your cell phone's data or Wi-Fi signal is in full strength and your cell phone can connect to the Internet.
- ▶ Try to activate the voice app on your cell phone to ensure it is in place.

Using a cordless handset or the telephone base:

To activate remote voice control:

1. Press **VOICE**.
-OR-
If you have two connected cell phones -> ▼ / ▲ to select a device.
2. When the telephone base or handset plays the confirmation tone, speak toward the telephone base or handset, and then wait for feedback. Make reply to the voice app's feedback, if necessary.
3. Press **CANCEL** to exit.

Refer to the online Complete user's manual for a list of troubleshooting tips on using Remote voice control feature.



Note: If you press **MUTE/DELETE/VOICE** on the handset or **MUTE/VOICE** on the telephone base while the system is not in use and has no paired cell phone(s), then the handset will prompt **Pair cell first** to remind you for remote voice control activation.

Android® and Google Play® are registered trademarks of Google Inc.

Connect to Cell™ is a trademark of Advanced American Telephones.

Siri® is a registered trademark of Apple Inc.

Google Now™ is a trademark of Google Inc.

S Voice® is a registered mark of Samsung Electronics Co., Ltd.

iOS is a trademark or registered trademark of Cisco in the U.S. and other countries and is used under license.



Operate

Operation	Steps
Making a home or cell call	<p>Using a cordless handset:</p> <ul style="list-style-type: none">▶ Press HOME/FLASH or -> Enter the telephone number.▶ Press CELL -> Enter the telephone number -> SELECT. <p>Using the telephone base:</p> <ul style="list-style-type: none">▶ Press HOME -> Enter the telephone number.▶ Press CELL -> Enter the telephone number -> SELECT.
On-hook dialing (predialing)	<p>Using a cordless handset: Enter the telephone number -> Press HOME/FLASH, CELL or to call.</p> <p>Using the telephone base: Enter the telephone number -> Press HOME or CELL to call.</p>
Answering a home or cell call	<p>Using a cordless handset: Press HOME/FLASH, CELL or .</p> <p>Using the telephone base: Press HOME or CELL.</p>
Ending a call	<p>Using a cordless handset: Press OFF/CANCEL or return the handset to the telephone base or charger.</p> <p>Using the telephone base: Press HOME or CELL.</p>
Handset speakerphone	During a call, press to switch between handsfree speakerphone and normal handset use.
Redial	<p>Using a cordless handset: Press REDIAL/PAUSE repeatedly to select the desired entry -> HOME/FLASH, CELL or to call.</p> <p>Using the telephone base: Press REDIAL/PAUSE repeatedly to select the desired entry -> HOME or CELL to call.</p>



Operate

Operation	Steps
Volume control	Using a cordless handset: Press VOL ▼ to decrease or press VOL ▲ to increase the listening volume during a call. Using the telephone base: Press VOL - to decrease or press VOL + to increase the listening volume during a call.
Call waiting (Requires subscription from telephone)	Press HOME/FLASH on the handset or PTT/FLASH on the telephone base to put current call on hold and to take the new call.



Push-to-talk (PTT)

Operation	Steps
Turn PTT on/off	Using a cordless handset or telephone base: 1. PTT -> ▼ / ▲ -> PTT On/Off -> SELECT . 2. ▼ / ▲ -> On or Off -> SELECT .
PTT call to a single device	Using a cordless handset or telephone base: With one handset: 1. <u>Press and hold</u> PTT . 2. <u>Press and hold</u> PTT again and speak towards the handset or telephone base. 3. Release PTT after speaking. With two or more handsets: 1. PTT -> ▼ / ▲ to select a device -> SELECT . 2. <u>Press and hold</u> PTT again and speak towards the handset or telephone base. 3. Release PTT after speaking.
PTT call to multiple devices	Using a cordless handset or telephone base: 1. <u>Press and hold</u> PTT . 2. <u>Press and hold</u> PTT again and speak towards the handset or telephone base. 3. Release PTT after speaking.



Push-to-talk (PTT)

Operation	Steps
Answer a PTT call	<p>Using a cordless handset or telephone base: When your device receives a PTT call, it beeps and shows Press and hold [PTT] to talk or Press [PTT] Talk.</p> <ol style="list-style-type: none"> 1. <u>Press and hold</u> PTT -> speak towards the handset or telephone base. 2. Release PTT after speaking.
End or leave a PTT call	<p>Using a cordless handset or telephone base:</p> <ul style="list-style-type: none"> › Press OFF/CANCEL or return the handset to the telephone base or charger. <p>Using the telephone base:</p> <ul style="list-style-type: none"> › Press CANCEL on the telephone base.



Phonebook

The phonebook can store up to 1,200 entries, which are shared by all system devices.

Operation	Steps
Adding an entry to the phonebook	<p>Using a cordless handset:</p> <ol style="list-style-type: none"> 1. MENU -> ▼ / ▲ -> Phonebook -> SELECT. 2. SELECT to select Add new entry. 3. Enter a telephone number up to 30 digits -> SELECT. 4. Enter a name up to 15 characters -> SELECT. <p>Using the telephone base:</p> <ol style="list-style-type: none"> 1. MENU -> ▼ / ▲ -> Phonebook -> SELECT. 2. ▼ / ▲ -> Add new entry -> SELECT. 3. Enter a telephone number up to 30 digits -> SELECT. 4. Enter a name up to 15 characters -> SELECT.
Searching/dialing an entry	<ol style="list-style-type: none"> 1. Press ▲ on the handset or telephone base when it is not in use -> ▼ / ▲ to select the desired entry. 2. Press HOME/FLASH or on the handset, or press HOME on the telephone base to call using the home line. <p>-OR-</p> <p>Press CELL on the handset or on the telephone base to call using the cell line.</p>



Phonebook

Operation	Steps
Adding a Caller ID log entry to the phonebook	<p>Using a cordless handset:</p> <ol style="list-style-type: none">1. Press ▼ CID on the handset when it is not in use -> ▼ / ▲ to select the desired entry -> SELECT.2. SELECT again to select To Phonebook.3. Press SELECT twice to save the number and name. <p>Using the telephone base:</p> <ol style="list-style-type: none">1. Press ▼ CID on the telephone base when it is not in use -> ▼ / ▲ to select the desired entry -> SELECT.2. SELECT again to select Phonebook.3. Press SELECT twice to save the number and name.



Caller ID

This product supports caller ID services offered by most telephone service providers. The telephone stores caller ID information of the last 50 incoming calls in the telephone base. This information is common to all devices.

Caller ID announce

When this feature is on and you have an incoming call, the handset and/or base speaks "Call from..." and the name of the caller based on the phonebook or caller ID information. You can turn this feature on or off for the base or each individual handset, or both.

Using a cordless handset or the telephone base:

1. **MENU** -> **▼ / ▲** -> **Caller ID annc** -> **SELECT**.
2. **▼ / ▲** to choose **On** or **Off** -> **SELECT**.

Review and dial a number in the call log

1. Press **▼ CID** on the handset or telephone base when it is not in use -> **▼ / ▲** to scroll through the list.
2. Press **HOME/FLASH** or **📞** on the handset or **HOME** on the telephone base to dial with the home line.
-OR-
Press **📶 CELL** on the handset or on the telephone base to dial with the cell line.
 - ▶ You can press **#** repeatedly to add or remove **1** in the number before dialing.

Caller ID

Erase missed calls indicator in the call log

When you have missed calls, the screen shows **XX Missed calls**.

This is the total number of calls you have not yet reviewed in the call log.

To erase this missed call indicator, you can:

- ▶ Scroll and review the call log one by one; or
- ▶ Press and hold **OFF/CANCEL** on the handset or **CANCEL** on the telephone base when it is not in use.



Smart call blocker *§

If you have subscribed to caller ID service, then you can use the Smart call blocker feature to screen incoming calls.

What is Smart call blocker?

Smart call blocker filters robocalls and unwanted calls for you, while allowing welcome calls to get through.

You can set up your lists of welcome callers and unwelcome callers. The Smart call blocker allows calls from your welcome callers to get through, and it blocks calls from your unwelcome callers.

For other unknown home calls, you can block, screen, or forward these calls to the answering system.

By default, your telephone allows all incoming home calls to get through, but it will reject calls with numbers you have saved in the block list.

For details, you can check out the Smart call blocker leaflet and the complete user's manual.



Note: The screening feature of Smart call blocker is applicable to home calls only. All incoming cell calls will get through and ring. If you want to block a cell call, add the number to the block list.

* Use of Smart call blocker feature requires subscription of caller ID service.

§ Includes licenced QalTel™ technology.

QalTel™ is a trademark of Truecall Group Limited.



Default scenarios of Smart call blocker handling

Settings Scenarios	SCB screening option	Steps
I want to allow all calls except the people on the block list only.	No screening Block calls on the block list only	<ol style="list-style-type: none"> 1. CALL BLOCK. 2. SELECT to choose SCB screening. 3. SELECT again to choose No screening.

Prerequisite setups

Perform the following setups if you want to block or screen unknown home calls, or forward them to the answering system.

<p>Adding contact to Phonebook</p> <p>Enter and save telephone numbers of family members, friends and frequently called businesses, so that when they call, your telephone rings without having to go through the screening process.</p>	<p>Via direct entry:</p> <ol style="list-style-type: none"> 1. MENU -> ▼ / ▲ -> Phonebook -> SELECT. 2. ▼ / ▲ -> Add new entry -> SELECT. 3. Enter a telephone number up to 30 digits -> SELECT. 4. Enter a name up to 15 characters -> SELECT. <hr style="border-top: 1px dotted black;"/> <p>Via Caller ID log entry:</p> <p>Using a cordless handset:</p> <ol style="list-style-type: none"> 1. ▼ CID on the handset -> ▼ / ▲. 2. SELECT when the desired entry appears. 3. SELECT again to choose To Phonebook. 4. Press SELECT twice. <p>Using the telephone base:</p> <ol style="list-style-type: none"> 1. ▼ CID on the handset -> ▼ / ▲. 2. SELECT when the desired entry appears. 3. SELECT again to choose Phonebook. 4. Press SELECT twice.
--	--



Smart call blocker

Adding number to the block list

Add numbers that you want to prevent their calls from ringing through.

Via direct entry:

1. **CALL BLOCK.**
2. ▼ / ▲ -> **Block list** -> **SELECT.**
3. ▼ / ▲ -> **Add new entry** -> **SELECT.**
4. Enter a telephone number up to 30 digits -> **SELECT.**
5. Enter a name up to 15 characters -> **SELECT.**

Via Caller ID log entry:

Using a cordless handset:

1. Press ▼CID on the handset -> ▼ / ▲.
2. Press **SELECT** when the desired entry appears.
3. ▼ / ▲ -> **To Block list** -> **SELECT.**
4. Press **SELECT** twice.

Using the telephone base:

1. ▼CID on the handset -> ▼ / ▲.
2. **SELECT** when the desired entry appears.
3. ▼ / ▲ -> **Block list** -> **SELECT.**
4. Press **SELECT** twice.

Adding name to the star name list

Add caller names to your star name list to allow their calls to get through without having to go through the screening process.

Via direct entry:

1. **CALL BLOCK.**
2. ▼ / ▲ -> **SCB settings** -> **SELECT.**
3. **SELECT** again to choose **Star name list.**
4. ▼ / ▲ -> **Add new entry** -> **SELECT.**
5. Enter a name up to 15 characters -> **SELECT.**

Via Caller ID log entry:

Using a cordless handset:

1. Press ▼CID on the handset -> ▼ / ▲.
2. Press **SELECT** when the desired entry appears.
3. ▼ / ▲ -> **To Star name** -> **SELECT.**
4. Press **SELECT.**

Using the telephone base:

1. ▼CID on the handset -> ▼ / ▲.
2. **SELECT** when the desired entry appears.
3. ▼ / ▲ -> **Star name list** -> **SELECT.**
4. Press **SELECT.**



Smart call blocker



Notes:

- ▶ The phonebook stores up to 1,200 entries, the block list stores up to 1,000 entries, and the star name list stores up to 10 names.
- ▶ There are many organizations like **schools, medical offices, and pharmacies that use robocalls** to communicate important information to you. Robocall uses an autodialer to deliver pre-recorded messages. By entering the **EXACT** Caller ID (CID)'s name of the organizations into the **Star name list**, it ensures these calls will ring through when you only know the caller names but not their numbers.

Other popular scenarios

Based on your scenario, you can select your smart call blocker handling.

Settings Scenarios	Set screening options	SCB settings
I want to screen robocalls only.	Screen unknown - Screen and block robocalls 1. CALL BLOCK. 2. SELECT to choose SCB screening. 3. ▼ or ▲ -> Screen unknown -> SELECT.	Set screening announcement: - Robocalls only 1. CALL BLOCK. 2. ▼ or ▲ -> SCB settings -> SELECT. 3. ▼ or ▲ -> Screening annc -> SELECT. 4. SELECT to choose SCB annc type. 5. ▼ or ▲ -> Robocalls only -> SELECT.
I want to send home calls with numbers not saved in the phonebook or star name list to the answering system.	UnknownToAns.S - Forward all unknown home calls to the answering system 1. CALL BLOCK. 2. SELECT to choose SCB screening. 3. ▼ or ▲ -> UnknownToAns.S -> SELECT.	--



Smart call blocker

Settings Scenarios	Set screening options	SCB settings
I only want to receive home calls with their numbers in the phonebook or star name list. Other calls will be blocked.	Block unknown - Block all unknown home calls <ol style="list-style-type: none">1. CALL BLOCK.2. SELECT to choose SCB screening.3. ▼ or ▲ -> Block unknown -> SELECT.	--
I want to screen all home calls except those saved in the phonebook or star name list.	Screen unknown - Screen all home calls except welcome calls <ol style="list-style-type: none">1. CALL BLOCK.2. SELECT to choose SCB screening.3. ▼ or ▲ -> Screen unknown -> SELECT.	Set screening announcement: - Unknown caller <ol style="list-style-type: none">1. CALL BLOCK.2. ▼ or ▲ -> SCB settings -> SELECT.3. ▼ or ▲ -> Screening annc -> SELECT.4. SELECT to choose SCB annc type.5. ▼ or ▲ -> Unknown caller -> SELECT.

Block an incoming call

When there is an incoming call and the telephone is ringing, you can block the call.

Using a cordless handset or the telephone base:

- ▶ While the telephone is ringing, press **CALL BLOCK**. The telephone plays the block announcement "*The number you are calling is not accepting your call. Please hang up.*" to the caller, and the call will be terminated. The caller's number will be added to your block list.



Smart call blocker

Block the caller while on a call

When you are on a home call or cell call and speaking to the caller, and you do not want to continue the call, you can end the call with block announcement and add the number to the block list.

Using a cordless handset or the telephone base:

1. During a call, press **CALL BLOCK**.
2. Press **SELECT** to end the call.

Unblock a telephone number

If you have added a telephone number to the block list, you can unblock it.

Using a cordless handset or the telephone base:

1. Press **CALL BLOCK**.
2. ▼ or ▲ -> **Block list** -> **SELECT**.
3. Press **SELECT** to select **Review**.
4. ▼ or ▲ to browse through the block entries.
5. When the desired entry displays, press **MUTE/DELETE** on the handset or press **DELETE** on the telephone base, then press **SELECT** to confirm.

ⓄⓄ Answering system

About answering system and voicemail

Your telephone has separate indicators for two different types of voice messages: those left on the built-in answering system and those left at your telephone service provider's voicemail. To listen to messages recorded on the built-in answering system, refer to the **Message playback** section; to listen to voicemail, contact your telephone service provider for more information.

	Built-in answering system ▶/■	Voicemail service ✉
Supported by	Telephone system	Telephone service provider
Subscription	No	Yes
Fees	No	May apply
Answer incoming calls	<ul style="list-style-type: none"> ▶ After 4 rings by default. ▶ It can be changed in the handset or the telephone base menu. 	<ul style="list-style-type: none"> ▶ Usually after 2 rings. ▶ It can be changed by contacting your telephone service provider.
Storage	Telephone base	Server or System
Display new messages	▶ Handset and telephone base - XX new messages	▶ Handset and telephone base - ✉ and New voicemail
Retrieve messages	<ul style="list-style-type: none"> ▶ Press ▶/■ on the telephone base; OR ▶ Press MENU, and then select Play messages on the handset; OR ▶ Access remotely with an access code. 	<ul style="list-style-type: none"> ▶ <u>Press and hold</u> ✉ on the dialpad, and enter an access number from your telephone service provider; OR ▶ <u>Press and hold</u> ✉ to dial if you have saved the access number.

☉☉ Answering system

Turn answering system on or off

The answering system must be turned on to answer and record messages.

Using the telephone base:

- ▶ Press **⏻ ANS ON** to turn the answering system on or off.
If the answering system is turned on, it announces, *"Calls will be answered."* If the answering system is turned off, it announces, *"Calls will not be answered."*

Using a cordless handset:

1. **MENU** -> **▼ / ▲** -> **Answering sys** -> **SELECT**.
 2. **▼ / ▲** -> **Answer on/off** -> **SELECT**.
 3. **▼ / ▲** to choose **On** or **Off**-> **SELECT**.
- When the answering system is on, the handset shows **ANS ON**.

Message alert tone

When this feature is on, and there is at least one new message, the telephone base beeps every 10 seconds.

Using a cordless handset or the telephone base:

1. **MENU** -> **▼ / ▲** -> **Answering sys** -> **SELECT**.
2. **▼ / ▲** -> **Ans sys setup** -> **SELECT**.
3. **▼ / ▲** -> **Msg alert tone** -> **SELECT**.
4. **▼ / ▲** to choose **On** or **Off** -> **SELECT**.

Call screening

Turn this feature on if you want to listen to the incoming messages when they are being recorded. While monitoring an incoming message, you can answer the call by pressing **🏠HOME/FLASH** on the handset or **🏠HOME** on the telephone base.

Using a cordless handset or the telephone base:

1. **MENU** -> **▼ / ▲** -> **Answering sys** -> **SELECT**.
2. **▼ / ▲** -> **Ans sys setup** -> **SELECT**.
3. **SELECT** to select **Call screening**.
4. **▼ / ▲** to choose **On** or **Off** -> **SELECT**.

Answering system

Message playback

Using the telephone base:

- › Press ►/■/PLAY/STOP when the telephone base is not in use.

Using a cordless handset:

- › Press **MENU** then **SELECT** when the handset is not in use.

Options during playback

Feature	On the telephone base	On a handset
Adjust playback volume	Press - VOL +	Press VOL ▼ or VOL ▲
Stop playback	Press ►/■/PLAY/STOP	Press OFF/CANCEL
Skip to the next message	Press ►►/SKIP	Press 6
Repeat the message	Press ◀◀/REPEAT	Press 4
Play the previous message	Press ◀◀/REPEAT twice	Press 4 twice
Delete the message	Press X/DELETE	Press MUTE/DELETE

For C-UL compliance

In compliance with the bilingual requirements for safety, caution, and warning markings of Canadian Federal and Provincial/Territorial statutes and regulations, the French version of Important safety information is included.

Mesures de sécurité importantes



Ce symbole vous alertera d'informations importantes ou d'instructions d'entretien pouvant apparaître dans ce guide d'utilisation. Respectez toujours les mesures de sécurité et de sécurité de base lorsque vous utilisez ce produit, afin de réduire les risques de blessures, d'incendie, ou d'électrocution.

Information relative à la sécurité

- ▶ Veuillez lire et comprendre toutes les instructions de ce guide d'utilisation. Relectez toutes les inscriptions apparaissant sur le produit.
- ▶ N'utiliser qu'avec des dispositifs Bluetooth homologués par UL.
- ▶ Évitez d'utiliser le téléphone pendant un orage. Il pourrait y avoir un faible risque d'électrocution.
- ▶ N'utilisez pas un téléphone près d'une fuite de gaz. Dans certaines circonstances, une flammèche pourrait se produire lorsque l'adaptateur est branché à une prise de courant, ou lorsque le combiné est déposé sur son chargeur. Ceci est un événement fréquent associé avec la fermeture d'un circuit électrique. L'utilisateur ne devrait pas brancher un téléphone dans une prise de courant, et ne devrait pas déposer un combiné chargé dans le chargeur, si le téléphone se trouve dans un environnement comportant une concentration de gaz inflammables ou ignifuges, à moins de se trouver dans un endroit où la ventilation est adéquate. Une flammèche dans de tels environnements pourrait provoquer une explosion. De tels environnements peuvent comprendre : les endroits où de l'oxygène à des fins médicales est utilisé sans ventilation adéquate; des endroits où se trouvent des gaz industriels (dissolvants de nettoyage, des vapeurs de gazoline, etc.), une fuite de gaz naturel, etc.
- ▶ N'utilisez pas ce produit près de l'eau ou lorsque vous êtes mouillés. Par exemple, ne l'utilisez pas dans des sous-sols humides ou sous la douche, ou près d'une piscine, d'un bain, d'un évier de cuisine, ou d'une cuve de lavage. N'utilisez pas de liquides, ou de vaporisateurs aérosol de nettoyage. Si le produit entre en contact avec du liquide, débranchez immédiatement le fil téléphonique ou le cordon d'alimentation. Ne rebranchez pas le produit avant qu'il soit complètement sec.
- ▶ Installez cet appareil dans un endroit protégé où personne ne peut trébucher sur les cordons d'alimentation ou la ligne téléphonique. Protégez les câbles contre les dommages ou l'abrasion.
- ▶ Si le produit ne fonctionne pas correctement, consultez la section **Dépannage (Troubleshooting)** du guide d'utilisation. Si vous ne pouvez pas régler le problème, ou si le produit est endommagé, consultez la section **Garantie limitée (Limited warranty)** des pages 41-43. N'ouvrez pas ce produit, sauf tel qu'indiqué dans le guide d'utilisation. L'ouverture du produit ou le remontage inadéquat pourrait vous exposer à des tensions dangereuses ou autres dangers.

For C-UL compliance

- ▶ Remplacez les piles uniquement tel que décrit dans votre guide d'utilisation (Page 6). N'incinerez pas et ne percez pas les piles — elles contiennent des produits chimiques caustiques.
- ▶ L'adaptateur de courant est conçu pour être orienté verticalement ou installé sur le plancher. Les broches ne sont pas conçues pour se maintenir en place si la fiche est branchée dans une prise de courant au plafond, sous la table ou sous une armoire.
- ▶ Pour les produits à brancher à une prise de courant, la prise de courant doit être installée près du produit, afin d'assurer une accessibilité sécuritaire à la prise de courant.



MISES EN GARDE:

- ▶ N'utilisez seulement l'adaptateur inclus avec ce produit. Pour obtenir une pièce de rechange, visitez notre site Web au

<https://telephones.att.com> ou composez le
1-800-222-3111. Au Canada, composez le **1-866-288-4268**.



ATTENTION: Afin de prévenir les risques d'incendie ou d'explosion de la pile, remplacez la pile avec une pile du même type. Jetez les piles épuisées en respectant les instructions.

- ▶ Débrancher les lignes téléphoniques avant le remplacement des piles.

Évitez d'utiliser la batterie dans les conditions suivantes:

- ▶ des températures extrêmes faibles ou élevées auxquelles une batterie peut être soumise pendant l'utilisation, le stockage ou le transport.
- ▶ remplacement d'une batterie par un type incorrect pouvant supprimer une protection.
- ▶ mise au rebut d'une batterie dans un feu ou dans un four chaud, ou écrasement mécanique ou coupure d'une batterie, susceptible de provoquer une explosion.
- ▶ maintien d'une batterie dans un environnement à très haute température pouvant provoquer une explosion ou la fuite de liquide ou de gaz inflammables.
- ▶ batterie soumise à une pression de l'air extrêmement faible pouvant provoquer une explosion ou la fuite de liquide ou de gaz inflammables.
- ▶ N'utilisez que la pile de rechargeable incluse ou une pile de rechange (modèle BT162342/BT262342). Pour commander, visitez notre site Web
<https://telephones.att.com> ou composez le
1-800-222-3111. Au Canada, composez le **1-866-288-4268**.
- ▶ La plaque signalétique appliquée est située au bas ou à proximité du produit.

For C-UL compliance

Spécifiquement en rapport avec les téléphones sans fil

- ▶ Confidentialité : Les mêmes caractéristiques qui rendent les téléphones sans fil si pratiques créent également des restrictions. Les appels téléphoniques sont transmis entre le socle du téléphone et le combiné par le biais d'ondes radio, et il se peut que vos conversations téléphoniques soient interceptées par d'autres équipements de réception d'ondes radio au sein de la portée du téléphone sans fil. Pour cette raison, vous ne devez pas considérer les conversations sur un téléphone sans fil comme étant aussi confidentielles que celles d'un téléphone à cordon.
- ▶ Alimentation électrique : La base de ce téléphone sans fil doit être branchée à une prise de courant électrique fonctionnelle. La prise électrique ne doit pas être contrôlée par un interrupteur mural. Les appels ne peuvent pas être effectués à partir du combiné si la base n'est pas branchée, si elle est hors fonction ou si le courant électrique est coupé.
- ▶ Interférences potentielles aux téléviseurs : Certains téléphones sans fil fonctionnent sur des fréquences pouvant causer des interférences aux téléviseurs et magnétoscopes. Pour réduire ou prévenir de tels parasites, ne pas déposer la base du téléphone sans fil à proximité d'un téléviseur ou magnétoscope, ni directement sur celui-ci. Si votre téléviseur affiche des interférences, éloignez le téléphone sans fil de celui-ci afin de réduire les parasites.
- ▶ Piles rechargeables : Ce produit comporte des piles rechargeables à l'hydrure métallique de nickel. Utilisez de prudence lorsque vous manipulez de telles piles et veillez à ne pas les court-circuiter avec des matériaux conducteurs, tels que des bagues, bracelets et clés. La pile ou le conducteur peut surchauffer et vous brûler. Respectez la polarité adéquate entre les piles et le chargeur de piles.
- ▶ Piles rechargeables à l'hydrure métallique de nickel : Jetez ces piles de manière sécuritaire. N'incinerez pas et ne percez pas les piles. Comme pour les autres piles du même type, si elles sont brûlées ou percées, des matières corrosives peuvent s'en échapper, ce qui risque de causer des brûlures ou autres blessures corporelles.



Le sceau de l'organisme de recyclage RBRC sur les piles à l'hydrure métallique de nickel signifie que le fabricant de cet appareil participe volontairement au programme industriel visant à reprendre et recycler ce type de piles lorsqu'elles ne servent plus, au sein du territoire des États-Unis et du Canada. Vous devez apporter ces piles chez un détaillant participant ou le centre de recyclage le plus près de chez vous. Ou vous pouvez composer le 1-800-8-BATTERY^{MD} afin de connaître les endroits qui acceptent les piles à l'hydrure métallique de nickel mortes.

RBRC Seal et 1-800-8-BATTERY^{MD} sont des marques déposées de Call2recycle, Inc.

For C-UL compliance

Mesures préventives pour les utilisateurs de stimulateurs cardiaques implantés dans l'organisme

Stimulateurs cardiaques (ne s'applique qu'aux téléphones sans fil numériques) :

L'organisme "Wireless Technology Research, LLC (WTR)", une firme de recherche indépendante, a mené une évaluation pluridisciplinaire des interférences entre les téléphones sans fil portatifs et les stimulateurs cardiaques implantés dans l'organisme. Appuyée par l'Administration des aliments et drogues (FDA) des États-Unis, la firme WTR recommande aux médecins :

Avis aux détenteurs de stimulateurs cardiaques:

- ▶ Ils doivent tenir le téléphone sans fil à une distance d'au moins six pouces du stimulateur cardiaque.
- ▶ Ils ne doivent PAS placer le téléphone sans fil directement sur le stimulateur cardiaque, tel que dans une poche de chemise, lorsque celui-ci est en fonction.
- ▶ Ils doivent utiliser le téléphone sans fil en l'appuyant sur l'oreille qui se trouve dans la direction opposée au stimulateur cardiaque.

L'étude effectuée par l'organisme WRS n'a pas identifié de risque pour les détenteurs de simulateurs cardiaques causé par les gens qui utilisent un téléphone sans fil à proximité de ceux-ci.

Mode ECO

Lorsque le socle communique avec le combiné, le mode ECO sera activé automatiquement. Ceci réduit la consommation d'énergie selon la distance entre le socle du téléphone et le combiné.

Spécifiquement en rapport avec les répondeurs téléphoniques

Enregistrement deux voies : Cet appareil n'émet pas de bips d'avertissement qui permettent de prévenir l'autre partie que vous enregistrez la conversation. Pour assurer votre conformité aux règlements fédéraux ou provinciaux en rapport avec les enregistrements des conversations téléphoniques, vous devriez informer l'autre partie lorsque vous activez l'enregistrement.

CONSERVEZ CES INSTRUCTIONS

FCC Part 68 and ACTA

This equipment complies with Part 68 of the FCC rules and with technical requirements adopted by the Administrative Council for Terminal Attachments (ACTA). The label on the back or bottom of this equipment contains, among other things, a product identifier in the format US:AAAEQ##TXXXX. This identifier must be provided to your telephone service provider upon request.

The plug and jack used to connect this equipment to premises wiring and the telephone network must comply with the applicable Part 68 rules and technical requirements adopted by ACTA. A compliant telephone cord and modular plug is provided with this product. It is designed to be connected to a compatible modular jack that is also compliant. An RJ11 jack should normally be used for connecting to a single line and an RJ14 jack for two lines. See the installation instructions in the user's manual.

The Ringer Equivalence Number (REN) is used to determine how many devices you may connect to your telephone line and still have them ring when you are called. The REN for this product is encoded as the 6th and 7th characters following the US: in the product identifier (e.g., if ## is 03, the REN is 0.3). In most, but not all areas, the sum of all RENs should be five (5.0) or less. For more information, please contact your telephone service provider.

This equipment must not be used with Party Lines. If you have specially wired alarm dialing equipment connected to your telephone line, ensure the connection of this equipment does not disable your alarm equipment. If you have questions about what will disable the alarm equipment, consult your telephone service provider or a qualified installer.

If this equipment is malfunctioning, it must be unplugged from the modular jack until the problem has been corrected. Replacement to this telephone equipment can only be made by the manufacturer or its authorized agents. For replacement procedures, follow the instructions outlined under the Limited warranty.

If this equipment is causing harm to the telephone network, the telephone service provider may temporarily discontinue your telephone service. The telephone service provider is required to notify you before interrupting service. If advance notice is not practical, you will be notified as soon as possible. You will be given the opportunity to correct the problem and the telephone service provider is required to inform you of your right to file a complaint with the FCC. Your telephone service provider may make changes in its facilities, equipment, operation, or procedures that could affect the proper functioning of this product. The telephone service provider is required to notify you if such changes are planned.

If this product is equipped with a corded or cordless handset, it is hearing aid compatible.

If this product has memory dialing locations, you may choose to store emergency telephone numbers (e.g., police, fire, medical) in these locations. If you do store or test emergency numbers, please:

- ▶ Remain on the line and briefly explain the reason for the call before hanging up.
- ▶ Perform such activities in off-peak hours, such as early morning or late evening.

Industry Canada

This device contains licence-exempt transmitter(s)/receiver(s) that comply with Innovation, Science and Economic Development Canada's licence-exempt RSS(s). Operation is subject to the following two conditions:

(1) This device may not cause interference.

(2) This device must accept any interference, including interference that may cause undesired operation of the device.

Privacy of communications may not be ensured when using this telephone.

The term "IC:" before the certification/registration number only signifies that the Industry Canada technical specifications were met.

The Ringer Equivalence Number (REN) for this terminal equipment is 0.1. The REN indicates the maximum number of devices allowed to be connected to a telephone interface. The termination of an interface may consist of any combination of devices subject only to the requirement that the sum of the RENs of all the devices not exceed five.

This product meets the applicable Innovation, Science and Economic Development Canada technical specifications.

FCC Part 15

NOTE: This equipment has been tested and found to comply with the requirements for a Class B digital device under Part 15 of the Federal Communications Commission (FCC) rules. These requirements are intended to provide reasonable protection against harmful interference in a residential installation. This equipment generates, uses and can radiate radio frequency energy and, if not installed and used in accordance with the instructions, may cause harmful interference to radio communications. However, there is no guarantee that interference will not occur in a particular installation. If this equipment does cause harmful interference to radio or television reception, which can be determined by turning the equipment off and on, the user is encouraged to try to correct the interference by one or more of the following measures:

- ▶ Reorient or relocate the receiving antenna.
- ▶ Increase the separation between the equipment and receiver.
- ▶ Connect the equipment into an outlet on a circuit different from that to which the receiver is connected.
- ▶ Consult the dealer or an experienced radio/TV technician for help.

WARNING: Changes or modifications to this equipment not expressly approved by the party responsible for compliance could void the user's authority to operate the equipment.

This device complies with Part 15 of the FCC Rules. Operation is subject to the following two conditions: (1) this device may not cause harmful interference, and (2) this device must accept any interference received, including interference that may cause undesired operation. Privacy of communications may not be ensured when using this telephone.

To ensure safety of users, the FCC/ISED has established criteria for the amount of radio frequency energy that can be safely absorbed by a user or bystander according to the intended usage of the product. This product has been tested and found to comply with the FCC/ISED criteria. The handset may be safely held against the ear of the user. The telephone base shall be installed and used such that parts of the user's body other than the hands are maintained at a distance of approximately 20 cm (8 inches) or more.

This Class B digital apparatus complies with Canadian requirement:
CAN ICES-3 (B)/NMB-3(B)

Limited warranty

The AT&T brands are used under license. This product is covered by a one-year limited warranty. Any replacement or warranty service, and all questions about this product, should be directed to our website at

<https://telephones.att.com> or call **1 (800) 222-3111**. In Canada, dial **1 (866) 288-4268**.

1. What does this limited warranty cover?

The manufacturer of this AT&T Product, Advanced American Telephones, warrants to the holder of a valid proof of purchase ("Consumer" or "you") that the Product and all accessories provided by Advanced American Telephones in the sales package ("Product") are free from material defects in material and workmanship, pursuant to the following terms and conditions, when installed and used normally and in accordance with operation instructions. This limited warranty extends only to the Consumer for Products purchased and used in the United States of America and Canada.

2. What will Advanced American Telephones do if the Product is not free from material defects in materials and workmanship during the limited warranty period ("Materially Defective Product")?

During the limited warranty period, Advanced American Telephones' authorized service representative will replace, at Advanced American Telephones' option, without charge, a Materially Defective Product. If we choose to replace this Product, we may replace it with a new or refurbished Product of the same or similar design. Advanced American Telephones will return replacement Products to you in working condition.

Advanced American Telephones will retain defective parts, modules, or equipment. Replacement of Product, at Advanced American Telephones' option, is your exclusive remedy. You should expect the replacement to take approximately 30 days.

3. How long is the limited warranty period?

The limited warranty period for SynJ® and Syn248® products is TWO (2) YEARS from the date of purchase, while all other products limited warranty period is ONE (1) YEAR from the date of purchase. If we replace a Materially Defective Product under the terms of this limited warranty, this limited warranty also applies to replacement Products for a period of either (a) 90 days from the date the replacement Product is shipped to you or (b) the time remaining on the original one-year limited warranty, whichever is longer.

4. What is not covered by this limited warranty?

This limited warranty does not cover:

- ▶ Product that has been subjected to misuse, accident, shipping or other physical damage, improper installation, abnormal operation or handling, neglect, inundation, fire, water or other liquid intrusion; or
- ▶ Product that has been damaged due to repair, alteration or modification by anyone other than an authorized service representative of Advanced American Telephones; or
- ▶ Product to the extent that the problem experienced is caused by signal conditions, network reliability or cable or antenna systems; or
- ▶ Product to the extent that the problem is caused by use with non-Advanced American Telephones electrical accessories; or
- ▶ Product whose warranty/quality stickers, Product serial numbers plates or electronic serial numbers have been removed, altered or rendered illegible; or
- ▶ Product purchased, used, serviced, or shipped for repair from outside the United States, or used for commercial or institutional purposes (including but not limited to Products used for rental purposes); or
- ▶ Product returned without valid proof of purchase (see 2 below); or
- ▶ Charges for installation or set up, adjustment of customer controls, and installation or repair of systems outside the unit.

5. How do you get warranty service?

To obtain warranty service in the United States of America, visit

<https://telephones.att.com> or call **1 (800) 222-3111**. In Canada, dial **1 (866) 288-4268**.

NOTE: Before calling for service, please check the user's manual. A check of the Product controls and features may save you a service call.

Except as provided by applicable law, you assume the risk of loss or damage during transit and transportation and are responsible for delivery or handling charges incurred in the transport of Product(s) to the service location. Advanced American Telephones will return replaced Product under this limited warranty to

you, transportation, delivery or handling charges prepaid. Advanced American Telephones assumes no risk for damage or loss of the Product in transit.

6. What must you return with the PRODUCT to get warranty service?

1. Return the entire original package and contents including the Product to the Advanced American Telephones service location along with a description of the malfunction or difficulty;
2. Include “valid proof of purchase” (sales receipt) identifying the Product purchased (Product model) and the date of purchase or receipt; and
3. Provide your name, complete and correct mailing address and telephone number.

7. Other limitations

This warranty is the complete and exclusive agreement between you and Advanced American Telephones. It supersedes all other written or oral communications related to this Product. Advanced American Telephones provides no other warranties for this Product. The warranty exclusively describes all of Advanced American Telephones’ responsibilities regarding the Product. There are no other express warranties. No one is authorized to make modifications to this limited warranty and you should not rely on any such modification.



State/Provincial Law Rights: This warranty gives you specific legal rights, and you may also have other rights which vary from state to state.

Limitations: Implied warranties, including those of fitness for a particular purpose and merchantability (an unwritten warranty that the Product is fit for ordinary use) are limited to one year from date of purchase. Some states/provinces do not allow limitations on how long an implied warranty lasts, so the above limitation may not apply to you.

In no event shall Advanced American Telephones be liable for any indirect, special, incidental, consequential, or similar damages (including, but not limited to lost profits or revenue, inability to use the Product, or other associated equipment, the cost of substitute equipment, and claims by third parties) resulting from the use of this Product. Some states/provinces do not allow the exclusion or limitation of incidental or consequential damages, so the above limitation or exclusion may not apply to you.

Please retain your original sales receipt as proof of purchase.

Technical specifications

RF frequency band	1921.536MHz — 1928.448MHz	
Channels	5	
Handset battery	2.4V Ni-MH battery	
 	Telephone base voltage (DC adapter output)	6V DC @0.6A Max. PS1 or LPS
	Charger voltage (AC adapter output)	6V DC @0.4A Max. PS1 or LPS
Operating times*	Talk time (handset): up to 10 hours Standby: up to 5 days	

* Operating times vary depending on your actual use and the age of the battery.



Recycle this product when you are done with it

Scan the QR code or visit telephones.att.com/recycle
(For the US only)



Company: Advanced American Telephones

Address: 9020 SW Washington Square Road - Ste 555 Tigard, OR 97223, United States.

Phone: 1 (800) 222-3111 in the U.S. or 1 (866) 288-4268 in Canada



Telephones identified with this logo have reduced noise and interference when used with most T-coil equipped hearing aids and cochlear implants. The TIA-1083 Compliant Logo is a trademark of the Telecommunications Industry Association. Used under license.



The ENERGY STAR® program (www.energystar.gov) recognizes and encourages the use of products that save energy and help protect our environment. We are proud to supply this product with an ENERGY STAR® qualified power adapter meeting the latest energy efficiency guidelines.

The *Bluetooth*® word mark and logos are owned by Bluetooth SIG, Inc. and any use of such marks by Advanced American Telephones and its parent, VTech Holdings Limited, is under license. VTech Holdings Limited is a member of Bluetooth SIG, Inc. Other trademarks and trade names are those of their respective owners.

©2024 Advanced American Telephones. All Rights Reserved.

AT&T and the AT&T logo are trademarks of AT&T Intellectual Property licensed to Advanced American Telephones, San Antonio, TX 78219.

Siri® is a registered trademark of Apple Inc.

Android® is a registered trademark of Google Inc.

Connect to Cell™ is a trademark of Advanced American Telephones.

Google Now™ is a trademark of Google Inc.

IOS is a trademark or registered trademark of Cisco in the U.S. and other countries and is used under license.

Qaltel™ is a trademark of Truecall Group Limited.

S Voice® is a registered mark of Samsung Electronics Co., Ltd.

SynJ® and Syn248® are trademarks of Advanced American Telephones.

The RBRC Seal and 1-800-8-BATTERY® are registered trademarks of Call2recycle, Inc.

Printed in China. Issue 1.0 AT&T 04/24.