

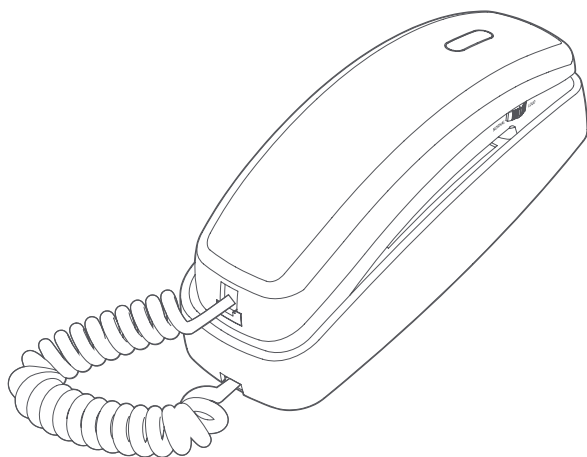

User's manual

TRIMLINE® 213
Memory telephone



Scan the QR code for
support information



Congratulations

on your purchase of this AT&T product. Before using this AT&T product, please read the **Important safety information** section on pages 1-2 of this manual.

Both the model and serial numbers of your AT&T product can be found on the bottom of the telephone base. Save your sales receipt and original packaging in case it is necessary to return your telephone for warranty service.

For customer service, please visit our website at <https://telephones.att.com> or call **1 (800) 222-3111**. In Canada, dial **1 (866) 288-4268**.



This **TRIMLINE® 213** Memory telephone user's manual can also be downloaded at <https://telephones.att.com/manuals>.

Parts checklist

Your telephone package contains the following items.

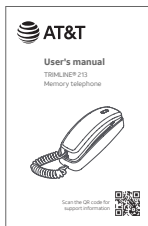

User's manual



Corded handset with
coiled handset cord



Telephone base



Telephone line cord

Important safety information



This symbol is to alert you to important operating or servicing instructions that may appear in this user's manual. Always follow basic safety precautions when using this product to reduce the risk of injury, fire, or electric shock.

Safety information

- ▶ Read and understand all instructions in the user's manual. Observe all markings on the product.
- ▶ Avoid using a telephone during a thunderstorm. There may be a slight chance of electric shock from lightning.
- ▶ Do not use a telephone in the vicinity of a gas leak. If you suspect a gas leak, report it immediately, but use a telephone away from the area where gas is leaking. If this product is a cordless model, make sure the base is also away from the area.
- ▶ Do not use this product near water or when you are wet. For example, do not use it in a wet basement or shower, nor next to a swimming pool, bathtub, kitchen sink and laundry tub. Do not use liquids or aerosol sprays for cleaning. If the product comes in contact with any liquid, unplug any line or power cord immediately. Do not plug the product back in until it has dried thoroughly.
- ▶ Install this product in a protected location where no one can trip over any line or power cords. Protect cords from damage or abrasion.
- ▶ If this product does not operate normally, see the **Troubleshooting** section of this user's manual. If you cannot solve the problem, or if the product is damaged, refer to the **Limited warranty** section (pages 21 - 23). Do not open this product except as directed in your user's manual. Opening the product or reassembling it incorrectly may expose you to hazardous voltages or other risks.
- ▶ If this product has user-replaceable batteries, replace batteries only as described in your user's manual. Do not burn or puncture batteries — they contain caustic chemicals.
- ▶ If this product has a three-prong (grounding) plug or a polarized plug with one wide prong, it may not fit in non-polarized outlets. Do not defeat the purpose of these plugs. If they do not fit in your outlet, the outlet should be replaced by an electrician.
- ▶ For pluggable equipment, the socket-outlet shall be installed near the equipment and shall be easily accessible.



CAUTIONS:

- ▶ Use only the power adapter provided with this product. To obtain a replacement, visit our website at **<https://telephones.att.com>** or call **1 (800) 222-3111**. In Canada, dial **1 (866) 288-4268**.
- ▶ The applied nameplate is located at the bottom or near of the product.

Important safety information

Especially about corded telephones

- ▶ **Electrical power:** The telephone base of this corded telephone must be connected to a working electrical outlet which is not controlled by a wall switch. Calls cannot be made from the handset if the telephone base is unplugged, switched off or if the electrical power is interrupted.
- ▶ **Power adapter:** The power adapter is intended to be correctly oriented in a vertical or floor mount position. The prongs are not designed to hold the plug in place if it is plugged into a ceiling, under-the-table or cabinet outlet.

Especially about telephone answering systems

Two-way recording: This unit does not sound warning beeps to inform the other party that the call is being recorded. To ensure that you are in compliance with any federal or state regulations regarding recording a telephone call, you should start the recording process and then inform the other party that you are recording the conversation.

SAVE THESE INSTRUCTIONS

Table of contents

Important safety information	1
Install.....	4
Wall-mount installation (optional)	6
Handset overview	8
Telephone base overview.....	10
Operate.....	11
Redial.....	11
Call waiting / three-way calling.....	11
Mute.....	11
Ringer volume.....	12
Ringer tone	12
Receiver (handset) volume.....	12
Temporary tone dialing.....	13
Memory dialing	13
Memory features	13
Speed dialing	14
Troubleshooting.....	15
For C-UL compliance.....	16
FCC, ACTA and IC information	18
FCC Part 15	20
Limited warranty	21

Install

Table/desk installation

This telephone includes a 7-foot line cord with a modular plug on each end. Use this cord to connect the telephone to a modular wall jack.

1. Fill in directory card

Remove the directory card and write in your own telephone number. Also write the telephone numbers (or names) that you want to store in each memory location (See Page 13). Reinstall the card and clear plastic cover.

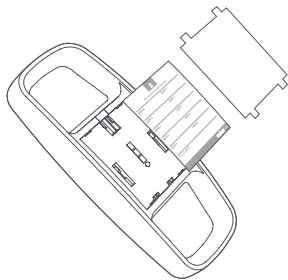

2. Connect handset to base

Plug one end of the coiled handset cord into the handset, and the other end into the base.

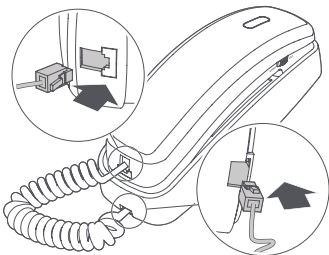

3. Connect line cord to telephone

Plug the long line cord into the jack on the underside of the telephone base. Then, feed the line cord through the channel provided so the telephone sits flat on your table or desk during use.

4. Connect line cord to wall jack

Plug free end of the line cord into a modular wall jack. Make sure it snaps firmly into place.

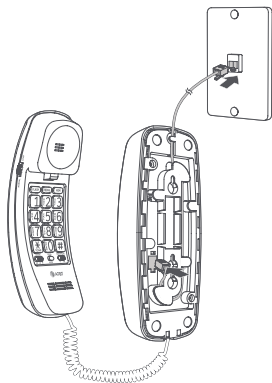



Install

5. Set dial mode switch

This product comes set in tone dialing (**TT**) mode. Make sure you choose the correct dialing method (**TT** or **DP**); touch tone dialing will not work if you have dial pulse service.

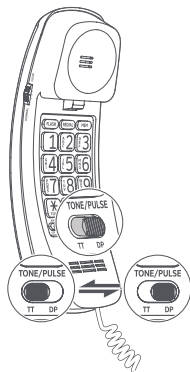

6. Check for dial tone

Lift the handset and listen for dial tone. When there is an incoming call, the visual ringer indicator light on the handset flashes.

If you cannot hear a dial tone, refer to the **Troubleshooting** section (Page 15) and try to correct the problem.

To disconnect the telephone, squeeze the clip on the modular plug and pull it out of the jack.

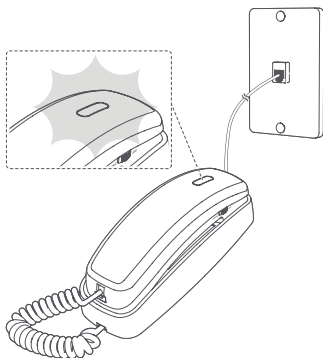



Wall-mount installation (optional)

Wall-mount installation

1. Fill in directory card

Remove the directory card and write in your own telephone number. Also write the telephone numbers (or names) that you want to store in each memory location (See Page 13). Reinstall the card and clear plastic cover.

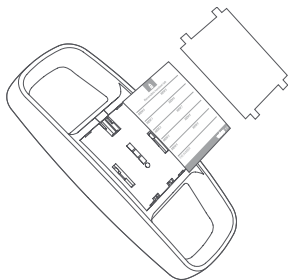

2. Reverse handset tab

To install the telephone on a wall jack, you must reverse the small tab above the directory card. This tab holds the handset in place when you hang up.

With the directory card and plastic cover removed, lift and remove the handset tab.

Reverse the tab and reinstall it, as shown below. Then, replace the directory card and cover.

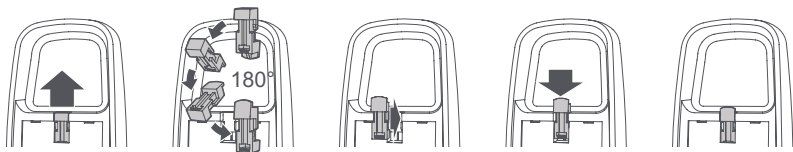
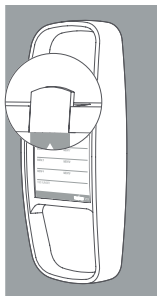

3. Plug the line cord into the jack on the underside of the base

Feed the line cord into the channel and wind it around the mounting area. Feed the last portion (as short as possible), through one of the slots in the mounting area.

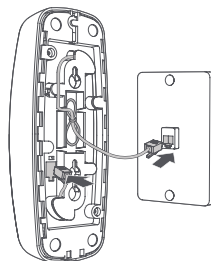



Wall-mount installation (optional)

4. Install telephone base on wall jack

Hold the base up next to the wall jack, and plug in the line cord. Then, push the base against the wall jack and down until it is held securely by the mounting studs.

NOTE: If you cannot fit the base onto the wall jack, remove the four non-slip pads.

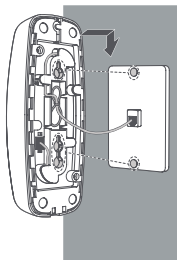

5. Connect handset to base

Plug one end of the coiled handset cord into the handset, and the other end into the base. Then, hang up.

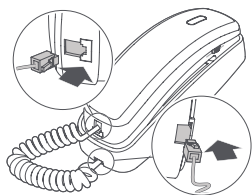

6. Set dial mode switch

This product comes set in tone dialing (**TT**) mode. Make sure you choose the correct dialing method (**TT** or **DP**); touch tone dialing will not work if you have dial pulse service.

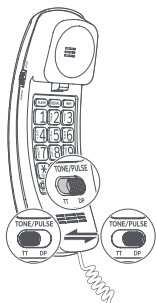

7. Check for dial tone

Lift the handset and listen for dial tone. When there is an incoming call, the visual ringer indicator light on the handset flashes.

If you cannot hear a dial tone, refer to the **Troubleshooting** section (Page 15) and try to correct the problem.

To disconnect the telephone, squeeze the clip on the modular plug and pull it out of the jack.

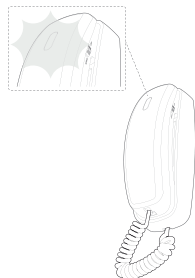



Handset overview

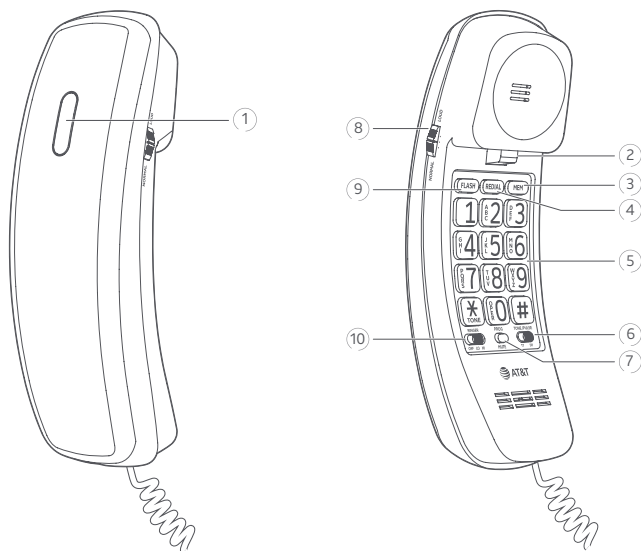

Handset

1	Visual ringer indicator	▸ Flashes when there is an incoming call.
2	Switch hook	<ul style="list-style-type: none">▸ Lift the handset from the telephone base to make a call.▸ Place the handset to the telephone base to end a call.
3	MEM	▸ When the telephone is not in use, press this key and followed by a dialing key (0-9) to dial the stored speed dial number.
4	REDIAL	▸ Press to call the last dialed number.
5	Dialing key pad	
	TONE ✕	▸ Press to switch to tone dialing temporarily during a call if you have pulse service.



Handset overview

-
- | | | |
|-----|-------------------|--|
| (6) | TONE/PULSE | <ul style="list-style-type: none">› Switch to left for tone dialing (TT); or switch to right for pulse dialing (DP). |
|-----|-------------------|--|
-
- | | | |
|-----|------------------|--|
| (7) | PROG/MUTE | <ul style="list-style-type: none">› When the telephone is not in use, press this key followed by a dialing key (0-9) to store the speed dial number.› While on a call, press to mute the microphone. The other party cannot hear you, but you can hear the other party. Press again to return to two-way conversation. |
|-----|------------------|--|
-
- | | | |
|-----|---|--|
| (8) | Receiver (handset) volume switch | <ul style="list-style-type: none">› Switch between NORMAL and LOUD listening volume. |
|-----|---|--|
-
- | | | |
|-----|--------------|--|
| (9) | FLASH | <ul style="list-style-type: none">› Press to activate custom calling services such as call waiting or 3-way calling.
NOTE: You may have to press other buttons before or after pressing FLASH, as explained in custom calling instructions provided by your local telephone company. |
|-----|--------------|--|
-
- | | | |
|------|-----------------------------|---|
| (10) | Ringer volume switch | <ul style="list-style-type: none">› Switch to middle to set the telephone to ring at low volume (LO).› Switch to right to set the telephone to ring at high volume (HI).› Switch to left to turn off the telephone ringer (OFF). You can dial or answer calls normally when the ringer is off. Other telephones in your home will still ring; they are not affected by the switch. |
|------|-----------------------------|---|
-



Telephone base overview

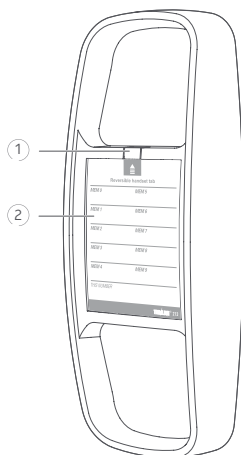

Telephone base

-
- | | | |
|---|-------------------------------|--|
| ① | Reversible handset tab | › Reverse the handset tab for wall-mounting. This tab holds the handset in place when you hang up. |
|---|-------------------------------|--|
-
- | | | |
|---|-----------------------|--|
| ② | Directory card | › You can write the telephone numbers (or names) that you want to store in each memory location. |
|---|-----------------------|--|
-



Operate

Redial

This telephone stores the last phone number dialed in redial memory. However, if the phone is disconnected from the wall jack or if you are without phone service for more than 30 minutes, redial memory will be lost.

The redial memory can accept numbers up to 31 digits long. The number will remain in redial memory until you change it by dialing another telephone number.

- ▶ To dial the same number again, lift the handset, and press **REDIAL**.

Erasing redial memory

- ▶ For privacy, you can erase the redial memory. Lift the handset, then press **1** and hang up.



Note: If the number is more than 31 digits long, no digits will be stored in the redial memory.

Call waiting / three-way calling

- ▶ Press **FLASH** instead of pressing the switch hook to activate custom calling services such as call waiting or 3-way calling.
- ▶ You may have to press other buttons before or after pressing **FLASH**, as explained in custom calling instructions provided by your local telephone company.

Mute

- ▶ While on a call, press **PROG/MUTE** to mute the microphone. The other party cannot hear you, but you can hear the other party.
- ▶ Press **PROG/MUTE** again to return to two-way conversation.

Operate

Ringer volume

The ringer volume switch allows you to turn the telephone ringer **OFF**, or set it to ring at **LO** or **HI** volume. You can dial or answer calls normally when the ringer is off. Other telephones in your home will still ring; they are not affected by the switch.

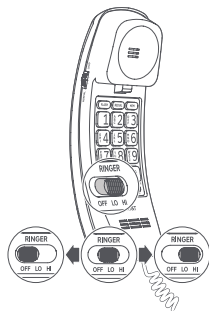

Ringer tone

You can choose from three different ringer tones. The phone comes set to Tone 2.

1. Press **PROG/MUTE**.
2. Press **#**.
3. Press **3** for Tone 1.
- **OR** -
Press **6** for Tone 2.
- **OR** -
Press **9** for Tone 3.
- **OR** -
Press **0** to temporarily turn off the ringer.
Lifting the handset and replacing it onto the base will turn the ringer back on.

Receiver (handset) volume

The receiver volume switch on the side of the handset can be adjusted for a comfortable listening level. The switch has three volume positions.

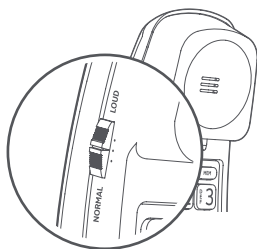



Operate

Temporary tone dialing

Temporary tone dialing is used only when you have rotary service. It allows you to access to services that require tone signaling, including some tone-activated computer systems (e.g., telephone banking).

To change from pulse (rotary) to tone dialing during a call:

1. Dial a telephone number with the dial switch set to **DP** (pulse).
2. Press **TONE** ; all buttons pressed after this will send tone signals.
3. After you hang up, the phone automatically returns to rotary service.



Memory dialing

Memory features

This telephone can store up to 10 different phone numbers, each up to 21 digits long. Numbers will remain stored in memory unless you erase or change them by entering other numbers.



Note: Numbers programmed into a memory location might not be retained if the telephone has been unplugged from the line jack for a half hour or more.

Directory card: Remove the directory card. Write your telephone number in the space provided. Also write the telephone numbers (or names) that you want to store in each memory location. Reinstall the card and clear plastic cover.

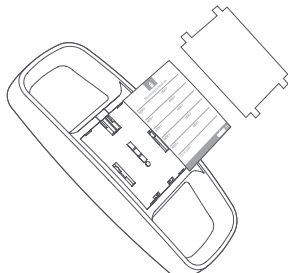



Memory dialing

Speed dialing

Ten telephone numbers can be stored in standard speed-dialing locations. You can dial any of these numbers by pressing two buttons.

To program numbers into memory:

1. Lift the handset.
2. Press **PROG/MUTE**.
3. Press **MEM**.
4. Enter a digit (**0-9**) for the memory location where you want to store the number.
5. Enter the telephone number. You will hear a click when each button is pressed.
6. Press **PROG/MUTE**.
7. Hang up after the number is entered correctly.
8. Repeat Steps 1-7 to store another number.

To dial:

1. Lift the handset and listen for dial tone.
2. Press **MEM**.
3. Press memory location (**0-9**).

To erase numbers from memory:

To erase any number from memory, you can enter another number in the same location.

Troubleshooting

If you have difficulty operating this phone, try the suggestions mentioned below. For Customer Service, visit our website at <https://telephones.att.com> or call **1 (800) 222-3111**. In Canada, call **1 (866) 288-4268**. Have the serial number, found on the underside of your phone, available when contacting Customer Service. Please retain your receipt as your proof of purchase.

To purchase accessories or replacement parts, contact Customer Service. Visit our website at <https://telephones.att.com> or call **1 (800) 222-3111**. In Canada, call **1 (866) 288-4268**.

No dial tone

- ▶ Make sure all plugs are connected properly. Inspect the line cord connections at the modular wall jack and at the telephone. Also inspect the coiled handset cord connections at both ends.
- ▶ Unplug the telephone and connect it to another modular wall jack. If it still does not work, try another telephone; if neither telephone works, the problem is not in your telephone. The trouble may be caused by local telephone company lines, central office equipment, or the wiring in your home.

Calls cannot be dialed, or are dialed slowly

- ▶ This product comes set in the tone (**TT**) mode. Make sure you choose the correct dialing method (**TT** or **DP**) for the dial switch. Touch tone dialing will not work if you have dial pulse service. If you have tone dialing service, you can use either tone or dial pulse mode. If you set the switch to **TT**, numbers are dialed much more quickly.

You can hear the other party, but other party can't hear you

- ▶ The **Mute** feature might be activated.
- ▶ Try pressing **PROG/MUTE**.
- ▶ If this doesn't work, try pressing **PROG/MUTE** again.
- ▶ If you program a number into memory while on a call, the other party will be unable to hear you.

Telephone does not ring

- ▶ Make sure the ringer volume switch is not set to **OFF**.
- ▶ You may have inadvertently turned off the ringer. Press **PROG/MUTE, #, 6, PROG/MUTE**.
- ▶ If there are several other phones on the same line, try disconnecting some of the other telephones. Having too many telephones can also create problems such as low ringer volume or impaired quality during calls.

For C-UL compliance

In compliance with the bilingual requirements for safety, caution, and warning markings of Canadian Federal and Provincial/Territorial statutes and regulations, the French version of Important safety information is included.

Mesures de sécurité importantes



Ce symbole vous alertera d'informations importantes ou d'instructions d'entretien pouvant apparaître dans ce guide d'utilisation. Respectez toujours les mesures de sécurité et de sécurité de base lorsque vous utilisez ce produit, afin de réduire les risques de blessures, d'incendie, ou d'électrocution.

Information relative à la sécurité

- ▶ Veuillez lire et comprendre toutes les instructions de ce guide d'utilisation. Relectez toutes les inscriptions apparaissant sur le produit.
- ▶ Évitez d'utiliser le téléphone pendant un orage. Il pourrait y avoir un faible risque d'électrocution.
- ▶ N'utilisez pas un téléphone près d'une fuite de gaz. Dans certaines circonstances, une flammèche pourrait se produire lorsque l'adaptateur est branché à une prise de courant, ou lorsque le combiné est déposé sur son chargeur. Ceci est un événement fréquent associé avec la fermeture d'un circuit électrique. L'utilisateur ne devrait pas brancher un téléphone dans une prise de courant, et ne devrait pas déposer un combiné chargé dans le chargeur, si le téléphone se trouve dans un environnement comportant une concentration de gaz inflammables ou ignifuges, à moins de se trouver dans un endroit où la ventilation est adéquate. Une flammèche dans de tels environnements pourrait provoquer une explosion. De tels environnements peuvent comprendre : les endroits où de l'oxygène à des fins médicales est utilisé sans ventilation adéquate; des endroits où se trouvent des gaz industriels (dissolvants de nettoyage, des vapeurs de gazoline, etc.), une fuite de gaz naturel, etc.
- ▶ N'utilisez pas ce produit près de l'eau ou lorsque vous êtes mouillés. Par exemple, ne l'utilisez pas dans des sous-sols humides ou sous la douche, ou près d'une piscine, d'un bain, d'un évier de cuisine, ou d'une cuve de lavage. N'utilisez pas de liquides, ou de vaporisateurs aérosol de nettoyage. Si le produit entre en contact avec du liquide, débranchez immédiatement le fil téléphonique ou le cordon d'alimentation. Ne rebranchez pas le produit avant qu'il soit complètement sec.
- ▶ Installez cet appareil dans un endroit protégé où personne ne peut trébucher sur les cordons d'alimentation ou la ligne téléphonique. Protégez les câbles contre les dommages ou l'abrasion.
- ▶ Si le produit ne fonctionne pas correctement, consultez la section **Dépannage (Troubleshooting)** du guide d'utilisation. Si vous ne pouvez pas régler le problème, ou si le produit est endommagé, consultez la section **Garantie limitée (Limited warranty)** des pages 21-23. N'ouvrez pas ce produit, sauf tel qu'indiqué dans le guide d'utilisation. L'ouverture du produit ou le remontage inadéquat pourrait vous exposer à des tensions dangereuses ou autres dangers.

For C-UL compliance

- ▶ Remplacez les piles uniquement tel que décrit dans votre guide d'utilisation. N'incinerez pas et ne percez pas les piles — elles contiennent des produits chimiques caustiques.
- ▶ L'adaptateur de courant est conçu pour être orienté verticalement ou installé sur le plancher. Les broches ne sont pas conçues pour se maintenir en place si la fiche est branchée dans une prise de courant au plafond, sous la table ou sous une armoire.
- ▶ Pour les produits à brancher à une prise de courant, la prise de courant doit être installée près du produit, afin d'assurer une accessibilité sécuritaire à la prise de courant.



MISES EN GARDE:

- ▶ N'utilisez seulement l'adaptateur inclus avec ce produit. Pour obtenir une pièce de rechange, visitez notre site Web au

<https://telephones.att.com> ou composez le
1-800-222-3111. Au Canada, composez le **1-866-288-4268**.

- ▶ La plaque signalétique appliquée est située au bas ou à proximité du produit.

Spécifiquement en rapport avec les téléphones avec fil

- ▶ Alimentation électrique : La base de ce téléphone sans fil doit être branchée à une prise de courant électrique fonctionnelle. La prise électrique ne doit pas être contrôlée par un interrupteur mural. Les appels ne peuvent pas être effectués à partir du combiné si la base n'est pas branchée, si elle est hors fonction ou si le courant électrique est coupé.
- ▶ Adaptateur de courant: L'adaptateur de courant est conçu pour être orienté verticalement ou installé sur le plancher. Les broches ne sont pas conçues pour se maintenir en place si la fiche est branchée dans une prise de courant au plafond, sous la table ou sous une armoire.

Spécifiquement en rapport avec les répondeurs téléphoniques

Enregistrement deux voies : Cet appareil n'émet pas de bips d'avertissement qui permettent de prévenir l'autre partie que vous enregistrez la conversation. Pour assurer votre conformité aux règlements fédéraux ou provinciaux en rapport avec les enregistrements des conversations téléphoniques, vous devriez informer l'autre partie lorsque vous activez l'enregistrement.

CONSERVEZ CES INSTRUCTIONS

FCC, ACTA and IC information

If this equipment was approved for connection to the telephone network prior to July 23, 2001, it complies with Part 68 of the Federal Communications Commission (FCC) rules. If the equipment was approved after that date, it complies with the Part 68 rules and with the Technical Requirements for Connection of Equipment to the Telephone Network adopted by the Administrative Council for Terminal Attachments (ACTA). We are required to provide you with the following information.

1. Product identifier and REN information

The label on the back or bottom of this equipment contains, among other things, an identifier indicating product approval and the Ringer Equivalence Number (REN). This information must be provided to your telephone service provider upon request. For equipment approved prior to July 23, 2001, the product identifier is preceded by the phrase "FCC Reg No." and the REN is listed separately. For equipment approved after that date, the product identifier is preceded by "US" and a colon (:), and the REN is encoded in the product identifier without a decimal point as the sixth and seventh characters following the colon. For example, the product identifier US:AAAEQ03T123XYZ would indicate an REN of 0.3.

The REN is used to determine how many devices you may connect to your telephone line and still have them ring when you are called. In most, but not all areas, the sum of all RENS should be five (5.0) or less. You may want to contact your telephone service provider for more information.

2. Connection and use with the nationwide telephone network.

The plug and jack used to connect this equipment to the premises wiring and the telephone network must comply with the applicable part 68 rules and technical requirements adopted by ACTA. A compliant telephone cord and modular plug are provided with this product. It is designed to be connected to a compatible modular jack that is also compliant. An RJ11 jack should normally be used for connecting to a single line and an RJ14 jack for two lines, see installation instructions in the user's manual. This equipment may not be used with coin telephone lines or with party lines. If you have specially wired alarm dialing equipment connected to our telephone line, ensure the connection of this equipment does not disable your alarm equipment. If you have questions about what will disable the alarm equipment, consult your telephone service provider or qualified installer.

3. Repair instructions

If this equipment is malfunctioning, it must be unplugged from the modular jack until the problem has been corrected. Replacement to this telephone equipment can only be made by the manufacturer or its authorized agents. For replacement procedures, follow the instructions outlined under the limited warranty.

FCC, ACTA and IC information

4. Rights of the telephone service provider

If this equipment is causing harm to the telephone network, the telephone service provider may temporarily discontinue your telephone service. The telephone service provider is required to notify you before interrupting service.

If advance notice is not practical, you will be notified as soon as possible. You will be given the opportunity to correct the problem and the telephone service provider is required to inform you of your right to file a complaint with the FCC. Your telephone service provider may make changes in its facilities, equipment, operation, or procedures that could affect the proper functioning of this product. The telephone service provider is required to notify you if such changes are planned.

5. Hearing aid compatibility

If this product is equipped with a corded or cordless handset, it is hearing aid compatible.

6. Programming/testing of emergency numbers

If this product has memory dialing locations, you may choose to store police, fire department and emergency medical service telephone numbers in these locations. If you do, please keep three things in mind:

- a. We recommend that you also write the telephone number on the directory card (if applicable), so that you can still dial the emergency number manually if the memory dialing feature doesn't work.
- b. This feature is provided only as a convenience, and the manufacturer assumes no responsibility for customer reliance upon the memory feature.
- c. Testing the emergency telephone numbers you have stored is not recommended. However, if you do make a call to an emergency number:
 - You must remain on the line and briefly explain the reason for the call before hanging up.
 - Programming/testing of emergency numbers should be performed during off-peak hours, such as in the early morning or late evening, when the emergency services tend to be less busy.

FCC Part 15

Some telephone equipment generates, uses, and can radiate radio-frequency energy and, if not installed and used properly, may cause interference to radio and television reception. This product has been tested and found to meet the standards for a class B digital device, as specified in part 15 of the FCC rules.

These specifications are designed to provide reasonable protection against such interference in a residential installation. However, there is no guarantee that interference will not occur in a particular installation.

If this product causes interference to radio, VCR or television reception when it is in use, you might correct the interference with any one or all of these measures:

- ▶ Where it can be done safely, reorient the receiving radio, VCR or television antenna.
- ▶ To the extent possible, relocate the radio, VCR, television or other receiver with respect to the telephone equipment.
- ▶ If this telephone product runs on AC power, plug your product into an AC outlet that is not on the same circuit as one used by your radio, VCR or television.

Modifications to this product, not expressly approved by the manufacturer, could void the user's authority to operate the equipment.

Limited warranty

The AT&T brands are used under license. This product is covered by a one-year limited warranty. Any replacement or warranty service, and all questions about this product, should be directed to our website at

<https://telephones.att.com> or call **1 (800) 222-3111**. In Canada, dial **1 (866) 288-4268**.

1. What does this limited warranty cover?

The manufacturer of this AT&T Product, Advanced American Telephones, warrants to the holder of a valid proof of purchase (“Consumer” or “you”) that the Product and all accessories provided by Advanced American Telephones in the sales package (“Product”) are free from material defects in material and workmanship, pursuant to the following terms and conditions, when installed and used normally and in accordance with operation instructions. This limited warranty extends only to the Consumer for Products purchased and used in the United States of America and Canada.

2. What will Advanced American Telephones do if the Product is not free from material defects in materials and workmanship during the limited warranty period (“Materially Defective Product”)?

During the limited warranty period, Advanced American Telephones’ authorized service representative will replace, at Advanced American Telephones’ option, without charge, a Materially Defective Product. If we choose to replace this Product, we may replace it with a new or refurbished Product of the same or similar design. Advanced American Telephones will return replacement Products to you in working condition.

Advanced American Telephones will retain defective parts, modules, or equipment. Replacement of Product, at Advanced American Telephones’ option, is your exclusive remedy. You should expect the replacement to take approximately 30 days.

3. How long is the limited warranty period?

The limited warranty period for SynJ® and Syn248® products is TWO (2) YEARS from the date of purchase, while all other products limited warranty period is ONE (1) YEAR from the date of purchase. If we replace a Materially Defective Product under the terms of this limited warranty, this limited warranty also applies to replacement Products for a period of either (a) 90 days from the date the replacement Product is shipped to you or (b) the time remaining on the original one-year limited warranty, whichever is longer.

Limited warranty

4. What is not covered by this limited warranty?

This limited warranty does not cover:

- ▶ Product that has been subjected to misuse, accident, shipping or other physical damage, improper installation, abnormal operation or handling, neglect, inundation, fire, water or other liquid intrusion; or
- ▶ Product that has been damaged due to repair, alteration or modification by anyone other than an authorized service representative of Advanced American Telephones; or
- ▶ Product to the extent that the problem experienced is caused by signal conditions, network reliability or cable or antenna systems; or
- ▶ Product to the extent that the problem is caused by use with non-Advanced American Telephones electrical accessories; or
- ▶ Product whose warranty/quality stickers, Product serial number plates or electronic serial numbers have been removed, altered or rendered illegible; or
- ▶ Product purchased, used, serviced, or shipped for repair from outside the United States, or used for commercial or institutional purposes (including but not limited to Products used for rental purposes); or
- ▶ Product returned without valid proof of purchase (see item 6); or
- ▶ Charges for installation or set up, adjustment of customer controls, and installation or repair of systems outside the unit.

5. How do you get warranty service?

To obtain warranty service in the United States of America, visit

<https://telephones.att.com> or call **1 (800) 222-3111**. In Canada, please dial **1 (866) 288-4268**.

NOTE: Before calling for service, please check the user's manual. A check of the Product controls and features may save you a service call.

Except as provided by applicable law, you assume the risk of loss or damage during transit and transportation and are responsible for delivery or handling charges incurred in the transport of Product(s) to the service location. Advanced American Telephones will return replaced Product under this limited warranty to you, transportation, delivery or handling charges prepaid. Advanced American Telephones assumes no risk for damage or loss of the Product in transit.

Limited warranty

6. What must you return with the **PRODUCT** to get warranty service?

- ▶ Return the entire original package and contents including the Product to the Advanced American Telephones service location along with a description of the malfunction or difficulty;
- ▶ Include “valid proof of purchase” (sales receipt) identifying the Product purchased (Product model) and the date of purchase or receipt; and
- ▶ Provide your name, complete and correct mailing address and telephone number.

7. Other limitations

This warranty is the complete and exclusive agreement between you and Advanced American Telephones. It supersedes all other written or oral communications related to this Product. Advanced American Telephones provides no other warranties for this Product. The warranty exclusively describes all of Advanced American Telephones’ responsibilities regarding the Product. There are no other express warranties. No one is authorized to make modifications to this limited warranty and you should not rely on any such modification.

State/Provincial Law Rights: This warranty gives you specific legal rights, and you may also have other rights which vary from state to state.

Limitations: Implied warranties, including those of fitness for a particular purpose and merchantability (an unwritten warranty that the Product is fit for ordinary use) are limited to one year from date of purchase. Some states/provinces do not allow limitations on how long an implied warranty lasts, so the above limitation may not apply to you.

In no event shall Advanced American Telephones be liable for any indirect, special, incidental, consequential, or similar damages (including, but not limited to lost profits or revenue, inability to use the Product, or other associated equipment, the cost of substitute equipment, and claims by third parties) resulting from the use of this Product. Some states/provinces do not allow the exclusion or limitation of incidental or consequential damages, so the above limitation or exclusion may not apply to you.

Please retain your original sales receipt as proof of purchase.



<https://telephones.att.com>

Company: Advanced American Telephones

Address: 9020 SW Washington Square Road - Ste 555 Tigard, OR 97223, United States.

Phone: 1 (800) 222-3111 in the U.S. or 1 (866) 288-4268 in Canada

©2022 Advanced American Telephones. All Rights Reserved.

AT&T and the AT&T logo are trademarks of AT&T Intellectual Property licensed to
Advanced American Telephones, San Antonio, TX 78219.

TRIMLINE® is a registered trademark of Advanced American Telephones.

SynJ® and Syn248® are trademarks of Advanced American Telephones.

Printed in China. Issue 1.1 AT&T 12/22.