



at&t



Proud Sponsor

Quick start guide

1856
**Speakerphone/
answering system with
caller ID/call waiting**



Quick reference guide

FLASH

During a call, press to receive an incoming call if call waiting is activated.

DISPLAY DIAL

Press to dial the number currently displayed.

TAS/SETUP

Press to hear setup options. Press and hold to change answering system options.

CID/SETUP

Press to customize the telephone's operation.

PROG/MEM

Press to program a number.

M1/M2/M3

Press to dial a one-touch number.

CID ▲

When the telephone is idle, press to display caller ID information.

While entering numbers, press to delete the last number entered.

DELETE

Press to delete a message currently playing.

When phone is not in use, press and hold to delete all old messages.

◀REPEAT/MEMO

Press once to repeat a message currently playing, and press twice to listen to the previous messages.

Press to record a memo or change a menu setting.

CID ▼

When the telephone is idle, press to display caller ID information.

While entering numbers, press twice to insert a three-second dialing pause.

REMOVE

Press to delete caller ID currently displayed.

CLOCK RESET

Press to review. Press and hold to set the clock.

REDIAL

Press to redial last number dialed.

▲VOLUME

During a call, press ▲ or ▼ to adjust listening volume.

MUTE

Press to silence the microphone. Press again to resume conversation.

▶SPEAKER

Press to turn the speakerphone on or off (begin or end a call).

ON/OFF

Press to turn answering system on or off.

▶▶SKIP/ANNC

Press to skip a message or change a menu setting. Press and hold to record an announcement.

PLAY/STOP

When the telephone is idle, if you have new messages, press to play. Press again to stop message playback.

Press and hold to play all messages (the oldest first).

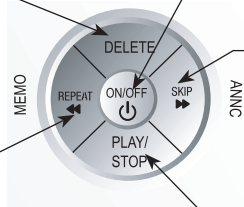
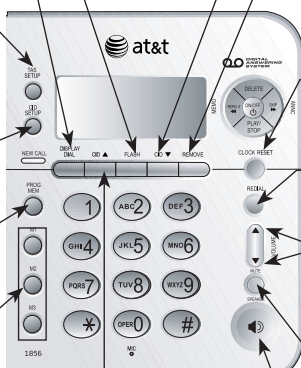

Telephone base installation

Install the telephone as shown below. Choose a location where the telephone is not exposed to excessive heat, cold, dust or moisture.

If you subscribe to high-speed Internet service (DSL - digital subscriber line) through your telephone lines, you must install a DSL filter between the telephone base and the telephone wall jack. The filter prevents noise and caller ID problems caused by DSL interference. Please contact your DSL service provider for more information about DSL filters.

1. Plug one end of the telephone line cord into the telephone jack at the back of the telephone.
2. The small end of the power adapter has been plugged into the power jack in the back of the telephone at the factory. Double check that it has been plugged in firmly.
3. Route the cord through the slot as shown to the right.
4. Plug the other end of the telephone line cord into a telephone wall jack.
5. Plug the large end of the power adapter into an electrical outlet not controlled by a wall switch.

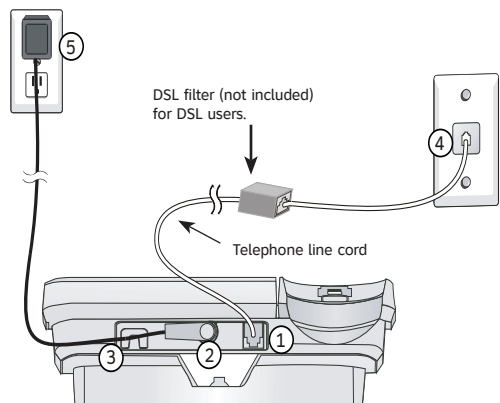

NOTES:

1. Use only the power adapter supplied with this product or equivalent. To order a replacement power adapter, visit our website at www.telephones.att.com, or call **1 (800) 222-3111**. In Canada, dial **1 (866) 288-4268**.
2. Be sure to use an electrical outlet not controlled by a wall switch.
3. The power adapters are intended to be correctly oriented in a vertical or floor mount position. The prongs are not designed to hold the plug in place if it is plugged into a ceiling or under-the-table/cabinet outlet.

Installation options

i NOTE: The mounting bracket must be used for both tabletop use and wall installation options.

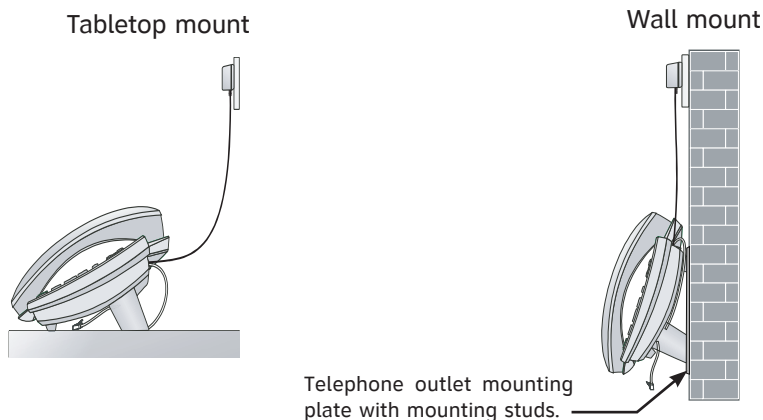

Wall mounting

The telephone base comes with the bracket mounted for tabletop use. If wall mounting is desired, a telephone outlet wall mounting plate with mounting studs is required. This mounting plate with studs may be available for purchase from many hardware or consumer electronics retailers and may require professional installation.

1. Hold down the switch hook on the telephone base, then slide the handset tab upwards to remove it from the slot. Rotate the handset tab 180 degrees. Push the handset tab down into the grooves so it settles into position.

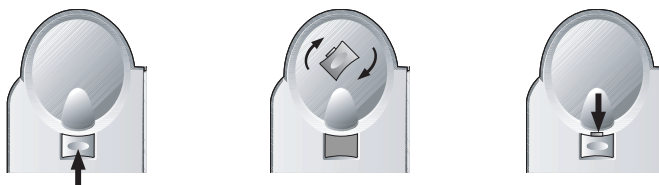

2. To remove the bracket, hold the telephone base in both hands, press the two bracket tabs and lift the bracket away from slots **a** and **b**.

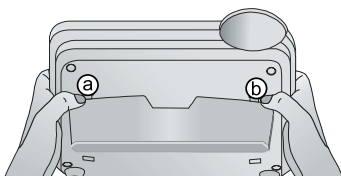

Installation options

3. Rotate the bracket to the wall installation position. Plug one end of the telephone line cord into the jack of the telephone base. Place the telephone line cord through one channel on the bracket. Bundle the telephone line cord and place it inside the bracket. Place the other end of the telephone line cord through the other channel on the bracket.
4. Insert the tabs of the bracket into slots ① and ② on the telephone base, then press the other bracket tabs into slots ③ and ④ as shown below.
5. Plug the power adapter into an electrical outlet not controlled by a wall switch. Plug the other end of the telephone line cord into a telephone wall jack. To mount the telephone on the wall, position the mounting holes ⑤ and ⑥ over the telephone outlet mounting studs. Press and slide the bracket down firmly so the telephone is held securely on the telephone outlet mounting studs.

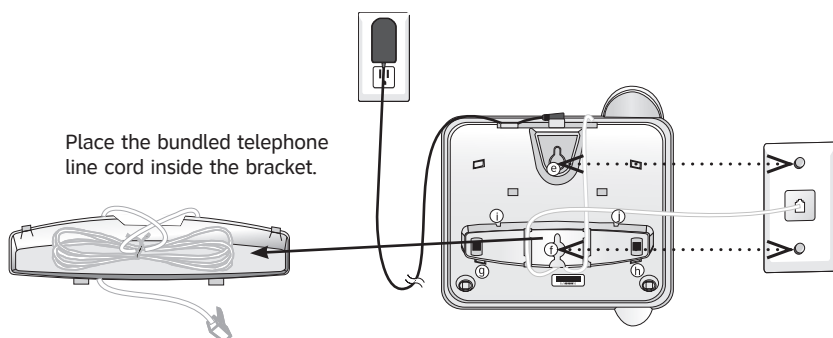

Tabletop installation

To return the bracket from the wall installation to tabletop position, follow the directions below.

1. Remove the telephone base from the wall. Unplug the cords from the wall jacks. Remove the bracket from the telephone base. Remove the telephone line cord from the channels. Untie the bundled telephone line cord.

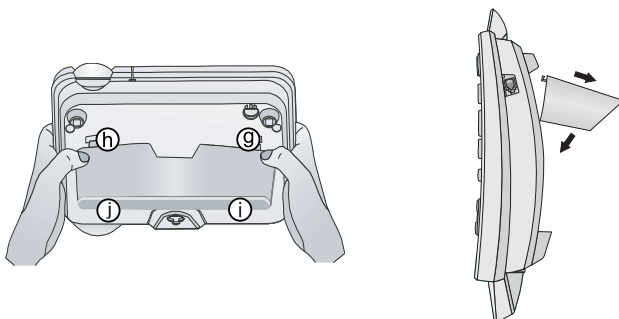

Installation options

Tabletop installation

2. Hold down the switch hook on the telephone base, then slide the handset tab upwards to remove it from the slot. Rotate the handset tab 180 degrees. Push the handset tab down into the grooves so it settles into position.

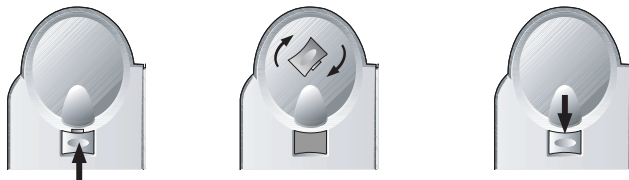

3. Rotate the bracket to tabletop position, insert the bracket tabs into slots © and ④ on the telephone base, then press the other bracket tabs into slots ② and ③.

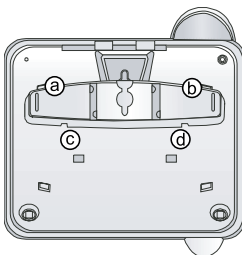

4. Plug one end of the telephone line cord into the telephone base. Plug the other end into the wall jack. Plug the small end of the power adapter into the telephone base. Route the power adapter cord through the slot. Plug the large end of the power adapter into an electrical outlet not controlled by a wall switch.

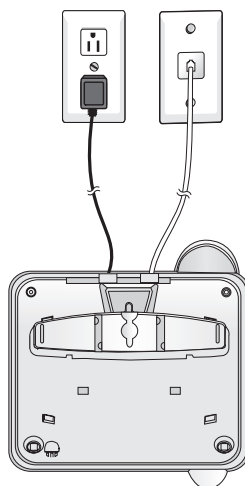



Proud Sponsor

www.telephones.att.com