



Quick start guide

TL96151

This quick start guide provides you with basic instructions only. For more complete instructions, refer to your user's manual provided in the package, or see the online user's manual at www.telephones.att.com/manuals.

Telephone base installation

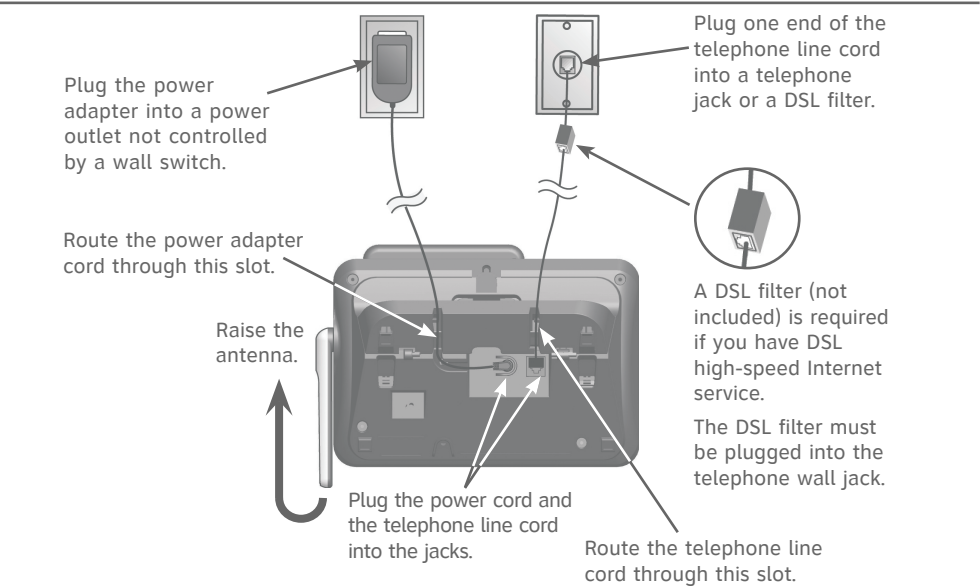

Caution: Use only the power adapter provided with this product. To obtain a replacement, visit our website at www.telephones.att.com or call **1 (800) 222-3111**. In Canada, dial **1 (866) 288-4268**.

Battery installation

Install the battery, as shown below. Charge your handset(s) before initial use. The battery is fully charged after 16 hours of continuous charging.

1. Plug the battery connector securely into the socket inside the handset battery compartment. Insert the supplied battery with the label **THIS SIDE UP** facing up, as indicated.



2. Align the cover flat against the battery compartment, then slide it upwards until it clicks into place.

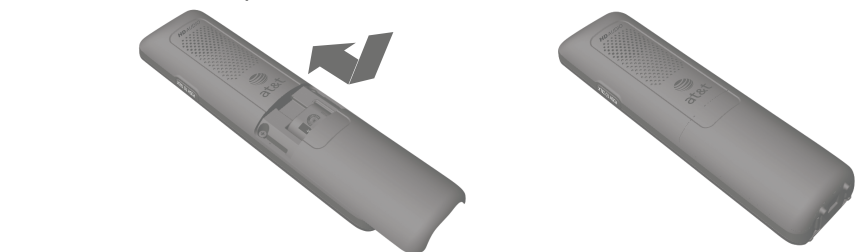

CHARGE light



Caution: Use only the supplied rechargeable battery or replacement battery (model BT183342/ BT283342).

3. Charge the handset by placing it face forward in the telephone base or charger. The **CHARGE** light on the top of the handset is on during charging.

Quick reference guide - handset

Softkeys (2)

- Show the menu.
- Select an item or save an entry or setting.

CHARGE light

- On when the handset is charging.

CELLULAR

- Make or answer a cell call.
- Answer a call waiting call during a cell call.

HOME/FLASH

- Make or answer a home call.
- Answer a call waiting call during a home call.

1

- Press repeatedly to add or remove **1** in front of the call log entry before dialing or saving it to the directory.

TONE ✕

- Switch to tone dialing temporarily during a call if you have pulse service.
- Toggle the name order when saving a caller ID log entry into directory.

SPEAKER

- Make or answer a home or cell call using the speakerphone.
- Switch between the speakerphone and the handset.

REDIAL/PAUSE

- Press repeatedly to view the last 10 numbers dialed.
- Press and hold to insert a dialing pause while entering numbers.

EQ

- During an outside call, intercom call, message or announcement playback, press to change the quality of the audio to best suit your hearing.



PUSH TO TALK

- Press to display the PTT menu to begin a PTT call.
- Press and hold to begin a one-to-group broadcast when the handset is not in use.

DIR▲/VOLUME

- Scroll up in menus.
- Increase listening volume when on a call or message playback.
- Show directory entries.
- Move the cursor to the left while entering names or numbers.

MUTE/DELETE

- Mute the microphone during a call.
- Delete digits while predialing.
- Delete an individual entry while reviewing the redial list, directory or caller ID log.
- Erase a digit or character while entering or editing a directory entry.
- Silence the ringer temporarily.
- Delete a message or announcement during message or announcement playback.

OFF/CANCEL

- Cancel an operation, back up to the previous menu, or exit the menu display while using menus.
- Press and hold to return to idle mode.
- Hang up a call.
- Press and hold to erase all the **Missed calls** or **Download fail** messages.
- Silence the ringer temporarily.

CID▼/VOLUME

- Scroll down in menus.
- Decrease listening volume when on a call or message playback.
- Show caller ID log.
- Move the cursor to the right while entering names or numbers in the directory.

(pound key)

- Press repeatedly to display other dialing options when reviewing a caller ID log entry.

Quick reference guide - telephone base

REDIAL/PAUSE

- Press repeatedly to view the last 10 numbers dialed.
- While entering numbers, press and hold to insert a dialing pause.

HANDSET LOCATOR

- Press the button to page all system handsets.
- Press and hold to begin handset deregistration.

VOLUME ▲

- Adjust the volume during message playback.
- Adjust the volume during a call.
- Adjust the telephone base ringer volume for all lines when in idle mode.

REPEAT

- Press to repeat a message or press twice to play the previous message.

PLAY/STOP

- Press to start or stop message playback.

MUTE

- Mute the microphone during a call.
- Silence the ringer temporarily.

HEADSET

- Transfer a call from the telephone base to a connected Bluetooth headset.
- Press to use a connected Bluetooth headset.
- Press to end a call while you are using the Bluetooth headset.

CANCEL

- While in a menu, press to exit without making changes or press and hold to return to idle mode.
- Press and hold to erase the displayed messages.

CID

- Press to scroll down while in a menu.
- Press to review the caller ID log.
- While entering names or numbers, press to move the cursor to the left.

Softkeys (2)

- Press to select the menu item displayed above the key.

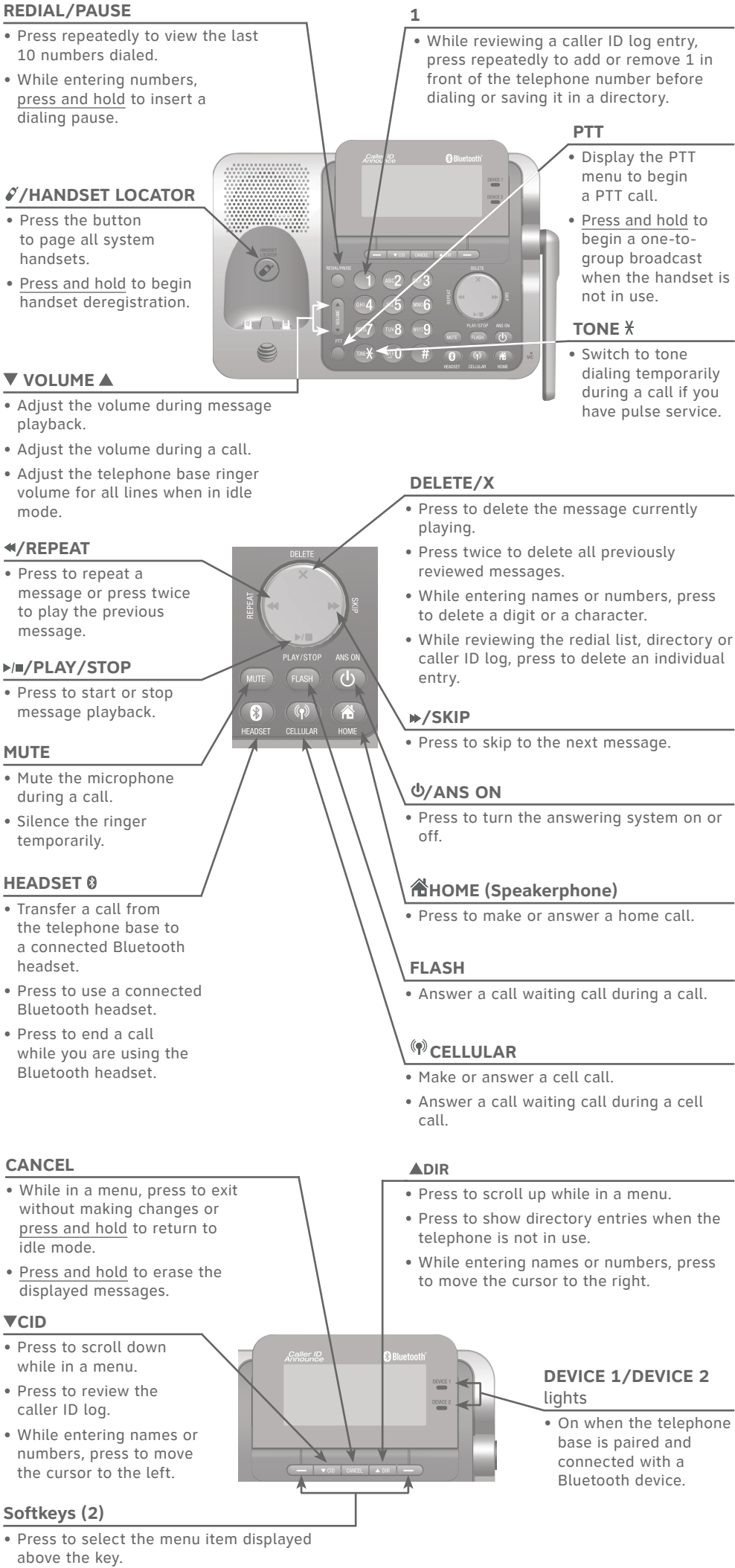

Initial settings

We recommend you program your telephone system before use.

The following are a few examples of common features to set before using the telephone. Refer to the **Handset and telephone base settings** and **Answering system settings** in the user's manual for detailed instructions on setting all telephone features.

Set date/time

Set the date/time before using the answering system.

Using a cordless handset or the telephone base:

1. **MENU** -> ▼ or ▲ -> **Set date/time** -> **SELECT**.
2. Enter the month, day and year using the dialing keys -> **SET**.
3. Enter the hour and minute using the dialing keys.
4. ▼ or ▲ to choose **AM** or **PM** -> **SET**.

Record your own announcement

Your outgoing announcement plays when calls are answered by the answering system. You can use the preset announcement to answer calls, or replace it with your own recorded announcement.

Using a cordless handset or the telephone base:

1. **MENU** -> ▼ or ▲ -> **Answering sys** -> **SELECT**.
2. **SELECT** to select **Announcement** -> **RECORD**.
3. Facing the handset or telephone base, record your announcement and press **STOP** to end recording.

Number of rings

You can set the answering system to answer an incoming call after 2, 3, 4, 5 or 6 rings, or toll saver. If you choose toll saver, the answering system answers a call after two rings when you have new messages, or after four rings when there are no new messages. This enables you to check for new messages and avoid paying unnecessary long distance charges if you are calling from out of your local area.

If you want the built-in answering system instead of the voicemail to answer a call, you should set the answering system to answer a call at least two rings before the voicemail is set to answer. Contact your telephone service provider for information on your voicemail settings.

Using a cordless handset or the telephone base:

1. **MENU** -> ▼ or ▲ -> **Answering sys** -> **SELECT**.
2. ▼ or ▲ -> **Ans sys setup** -> **SELECT**.
3. ▼ or ▲ -> **# of rings** -> **SELECT**.
4. ▼ or ▲ -> choose among **6, 5, 4, 3, 2** or **Toll saver** -> **SET**.

Ringer volume

You can set the ringer volume level to one of the six levels or turn the ringer off.

Using a cordless handset or the telephone base:

1. **MENU** -> ▼ or ▲ -> **Ringers** -> **SELECT**.
2. **SELECT** to select **Ringer volume**.
3. ▼ or ▲ -> **All lines, Home, Cell-D1 or Cell-D2** -> **SELECT**.
4. ▼ or ▲ to choose the desired level -> **SET**.

