



Quick start guide

**5.8 GHz Cordless
Telephone/Answering
System E5926/E5927B/
E5937B/E5947B/EI937B**

with caller ID/call waiting



Installation and setup

After battery installation, place each handset in the telephone base or a charger and allow to charge for 16 hours before use. You can keep the battery packs charged by returning the handsets to the telephone base or chargers after each use. When the battery is fully depleted, a recharge takes about 12 hours. The average talk time on a fully charged battery is about eight hours depending on environmental conditions, and the standby time is approximately four days.

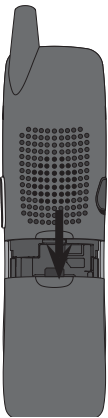

Press in and downward on the tab to open the battery compartment cover.

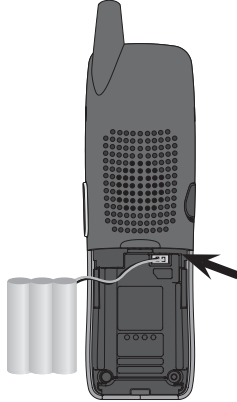

Plug the battery pack connector into handset.



Place the battery pack and wires in the compartment.

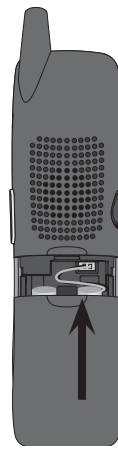

Slide battery compartment cover up until it clicks closed.

Plug telephone line cord into telephone jack.

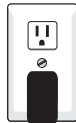

Plug the large power adapter into an electrical outlet not controlled by a wall switch.

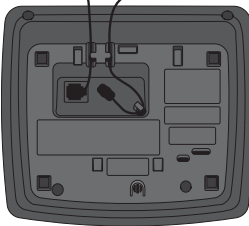

Place handset in base or charger to charge for 16 hours before first use.



Caution: Use only the supplied rechargeable battery or replacement battery pack (part number 80-5848-00-00).



NOTES:

1. Use only the power cord supplied with this product. If you need a replacement, call 1 (800) 222-3111. In Canada, call 1 (866) 288-4268.
2. Be sure to use an electrical outlet not controlled by a wall switch.

Quick reference guide

Cordless handset

▼ CID

Press to scroll down while in menus.

Press to display caller ID information. While entering names or numbers, press to move the cursor to the left.

PHONE/FLASH

Press to make or answer a call.

During a call, press to receive an incoming call if call waiting is activated.

MUTE/DELETE

While on a call, press to mute microphone.

While reviewing the call log, press to delete an individual entry, or press and hold to clear the caller ID log.

While pre-dialing, press to delete digits from a string.

🔊 SPEAKER

Press to activate handset speakerphone.

Press again to resume normal handset use.

SELECT/MENU

Press to display menu, or to select a highlighted item from menu or save an entry.

▲ DIR

Press to scroll up while in menus.

Press to display directory entries. While entering names, press to move the cursor to the right.

OFF/CLEAR

During a call, press to hang up.

While using menus, press to cancel an operation, back up to the previous menu, or exit the menu display.

REDIAL/PAUSE

Press to view redial memory. While entering numbers, press and hold to insert a dialing pause.

📞 INTERCOM

Press to initiate an intercom conversation, transfer or forward a call.

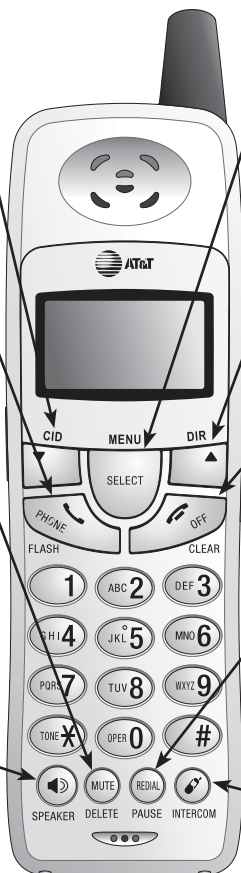

Feature menu

> shows a highlighted item

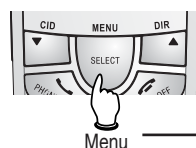
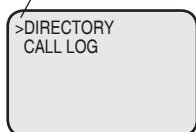

Feature menu

DIRECTORY
CALL LOG
RINGER VOLUME
RINGER TONE
KEY TONE
LANGUAGE
CLR VOICE MAIL
DIAL TYPE

Press ▼ or ▲ to scroll through menu items.

Press **SELECT** to select or modify a highlighted item.

Press **OFF/CLEAR** to cancel an operation, back up to the previous menu, or exit the menu display.



NOTE: For more information, please refer to the user's manual.

Quick reference guide

Telephone base



CHARGE

On when the cordless handset is properly positioned to charge in the telephone base.

IN USE

On when handset is in use or you are registering a handset. Flashes when another phone is in use on the same line, or the answering system is answering an incoming call, or you are de-registering a handset from the base.

VOLUME

Press to adjust message playback volume.

HANDSET LOCATOR

Press to make handset(s) beep (see page 14).

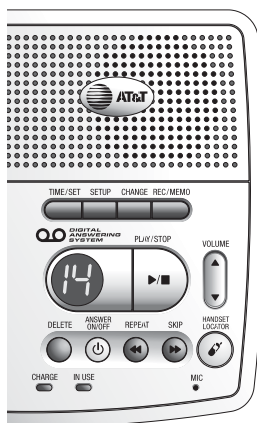

Answering system controls

Press to play or stop playing messages.

Press to repeat message.
Hold to slow playback.
Press twice to hear previous message.



Press to skip to next message. Hold to speed up playback.

- ANSWER ON/OFF** Press to turn answering system on or off.
- DELETE** Press to delete a message during play back. Hold to delete all old messages when set is idle.
- TIME/SET** Press to review or set the answering system clock.
- SETUP** Press to review or change answering system options.
- CHANGE** Press to change a menu option.
- REC/MEMO** Press to record a memo, or after pressing SETUP, to record an outgoing announcement.